

SCHEDULE "A"

The following lot or parcel of land situate, lying and being at

Pleasant Harbour aforesaid and known as "Beaver Field" and more particularly described as follows:

BEGINNING at a blazed spruce tree, thence running north 23 degrees west a distance of 2.34 chains to a blazed fir tree;

THENCE south 75 degrees 20 minutes west a distance 1.55 chains to a blazed fir tree;

THENCE southerly along the west line of said "Beaver Field" a distance of 2.87 chains to a blazed fir tree;

THENCE north 56 degrees 20 minutes east to the place of beginning, and the said "Beaver Field" is bounded on all sides by the lands of one Hugh Webb.

ALSO to the said Grantee, his heirs and assigns the free and uninterrupted use of the wood or hauling Roads passing through and over the lands described in Deed to said Grantee and recorded in the Registry of Deeds at Halifax in Book 1002, Page 617.

Reference is made to Document No. 99101744

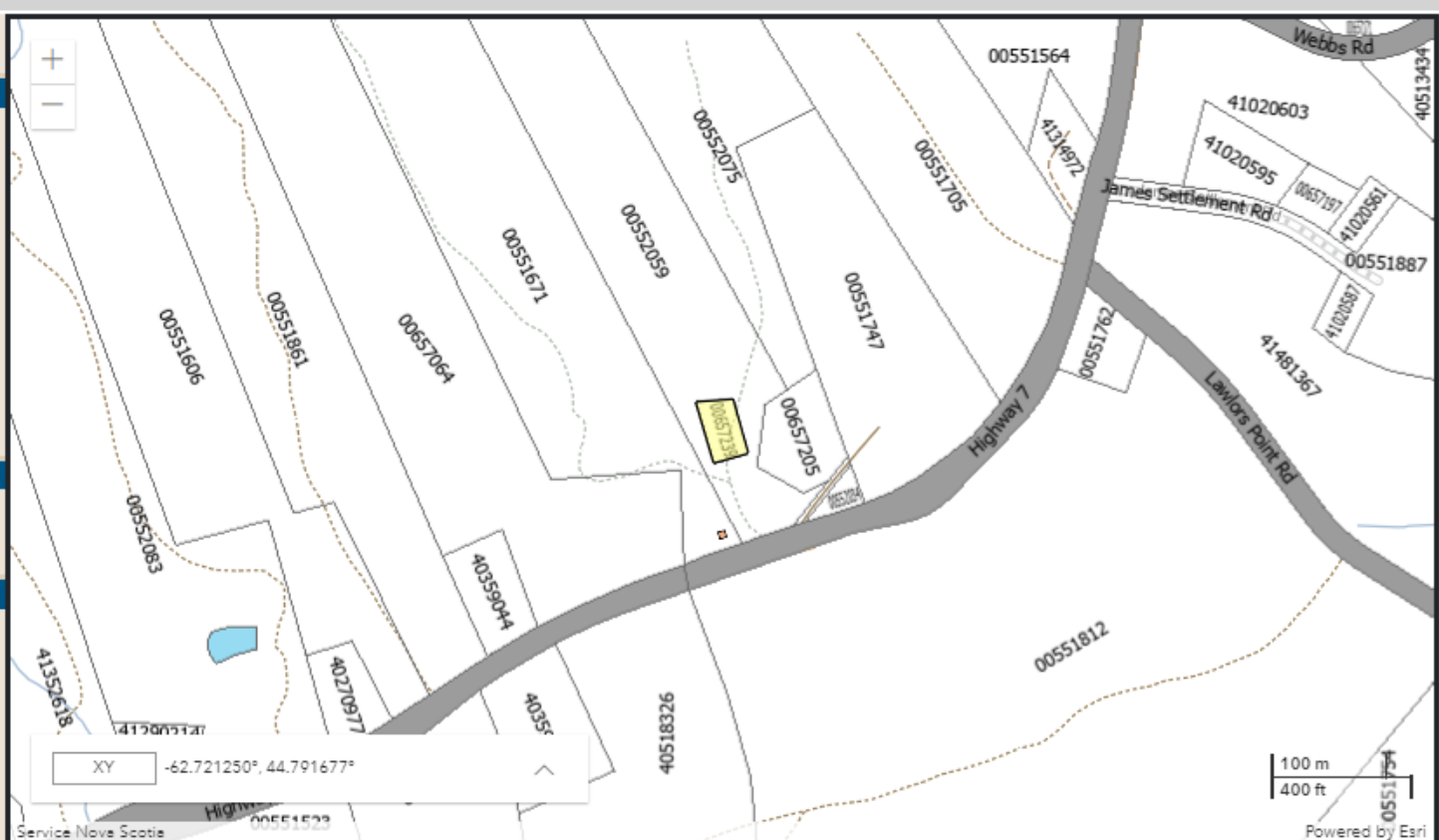

Lat: 44-47-030N

Long: 062-43-017W

Scale: 4505

Go

Zoom: 15

The Provincial mapping is a graphical representation of property boundaries which approximate the size, configuration and location of parcels. Care has been taken to ensure the best possible quality, however, this map is not a land survey and is not intended to be used for legal descriptions or to calculate exact dimensions or area. The Provincial mapping is not conclusive as to the location, boundaries or extent of a parcel [Land Registration Act subsection 21(2)]. THIS IS NOT AN OFFICIAL RECORD.