

SCHEDULE "A"

ALL those certain lots, pieces or parcels of land situate at or near Port Dufferin aforesaid (Formerly known as Salmon River) abutted and bounded as follows, that is to say, that certain lot of land situate at Beaver Harbour, called and known by the name of Lake Hill, and bounded as follows:

BEGINNING at the South East angle of the said lot;

THENCE running North along Hales Line which forms the Eastern boundary

~~of the said lot till it strikes John Hartlings line, which bounds it on~~
the North;

THENCE West thirty two chains and fifty links till it meets the Beaver Harbour Grant Line till it meets John Winters line, bounding the said lot on the South;

THENCE running East along the said line of John Winters, to the place of beginning.

CONTAINING twenty-six acres, more or less, being also same lot of land purchased by the said Joseph Hartling Senior from Leonard Jewens by Deed bearing date of first Decemben One Thousand Eight Hundred and Seventy Two. Registered in the Office of the Registrar of Deeds at Halifax, in the County, in Book 238, Page 154.

Reference is made to Book 5323 at Page 986

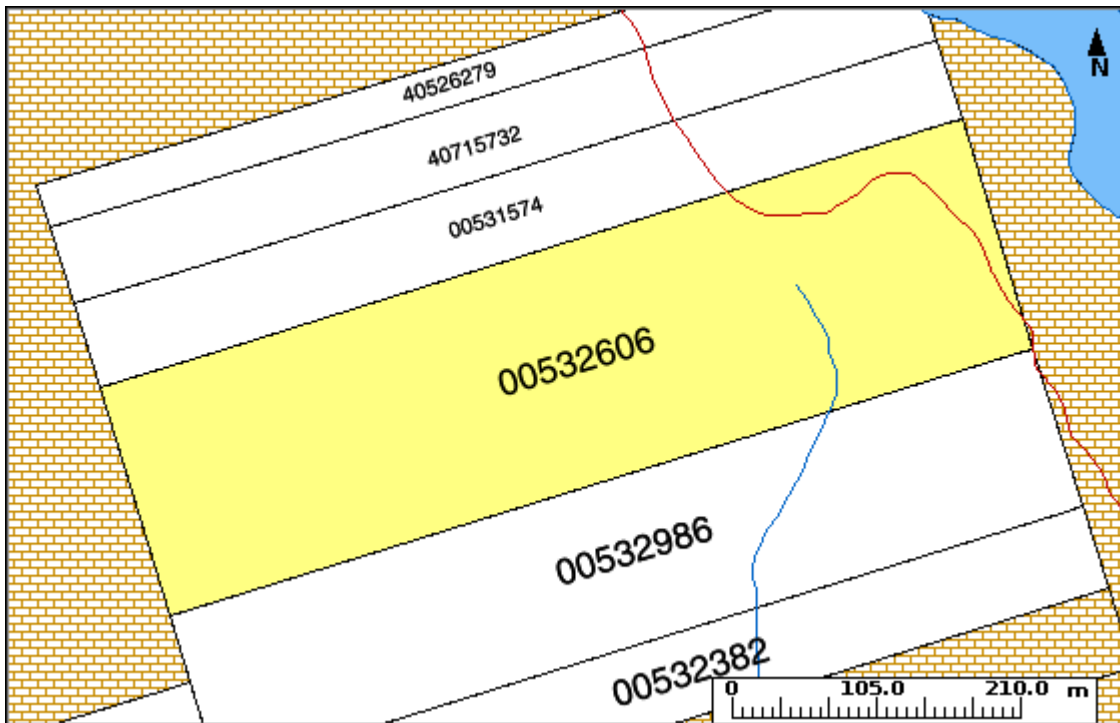

The Provincial mapping is a graphical representation of property boundaries which approximate the size, configuration and location of parcels. Care has been taken to ensure the best possible quality, however, this map is not a land survey and is not intended to be used for legal descriptions or to calculate exact dimensions or area. The Provincial mapping is not conclusive as to the location, boundaries or extent of a parcel [*Land Registration Act* subsection 21(2)]. THIS IS NOT AN OFFICIAL RECORD.

Property Online version 2.0

This page and all contents are copyright © 1999-2003, [Government of Nova Scotia](#), all rights reserved.