



P.O. Box 1749
Halifax, Nova Scotia
B3J 3A5 Canada

Item No. 15.2.1
Halifax Regional Council
February 25, 2020

TO: Mayor Savage and Members of Halifax Regional Council

Original Signed

SUBMITTED BY: _____
Councillor Matt Whitman, Chair, North West Community Council

DATE: February 11, 2020

SUBJECT: **Hammonds Plains Common Area Rate Funding Request – Hammonds Plains Consolidated School Parent Teacher Association**

ORIGIN

February 10, 2020 meeting of North West Community Council, Item No. 13.2.2.

LEGISLATIVE AUTHORITY

Halifax Regional Municipality Charter, section 25 (f) which states: “The powers and duties of a community council include making recommendations to the Council on any matter referred to it by the Council”.

RECOMMENDATION

North West Community Council recommends that Halifax Regional Council approve a one-time withdrawal from the Hammonds Plains Common Area Rate in the amount of \$4,538.28 to the Hammonds Plains Consolidated School Parent Teacher Association to cover additional costs related the 2019 Hammonds Plains Consolidated School Landscaping project.

BACKGROUND

On June 19, 2018, Halifax Regional Council approved the Area Rates for fiscal 2018-19 and directed staff to update and combine the current Recreation Area Rate Policy and Interim Area Rates Guidelines into New Area Rate Administrative Order for 2019-2020. Administrative Order #2019-005-ADM, Respecting the Establishment and use of Community Area Rates in HRM, was approved by Regional Council on August 13, 2019. As part of the review, Council also directed the discontinuance of the Hammonds Plains Common Area Rate levied on each of the taxable residential and resource property assessments and that staff return with recommendations on the existing surplus. In the meantime, interested non-profits are able to apply for funding for community projects from the surplus. Note: funds from the Hammonds Plains Common Area Rate can only fund projects that benefit the catchment area (Attachment 2).

In consultation with staff, and in keeping with past practice, requests for funding from the Hammonds Plains Common Area Rate surplus may be considered by North West Community Council with a recommendation for funding subject to Halifax Regional Council.

For further information, please refer to the Business Plan and Funding Request from the Hammonds Plains Consolidated School Parent Teacher Association (Attachment 1).

DISCUSSION

North West Community Council considered the funding request from the Hammonds Plains Consolidated School Parent Teacher Association at its meeting held on February 10, 2020 and forwarded the recommendation to Halifax Regional Council as outlined in this report.

FINANCIAL IMPLICATIONS

The Hammonds Plains Common Area Rate (C170) current balance, less commitments is \$131,644. There are sufficient funds for the payment of \$4,538.28. As all funding is from the Hammonds Plains Common Area Rate, so there would be no impact on the HRM General Operating Budget.

RISK CONSIDERATION

There are no significant risks associated with this report.

COMMUNITY ENGAGEMENT

North West Community Council meetings are open to public attendance and members of the public are invited to address the Community Council for up to five minutes at the end of each meeting during Public Participation. The agenda, reports, and minutes of North West Community Council are posted on Halifax.ca.

ENVIRONMENTAL IMPLICATIONS

Not applicable.

ALTERNATIVES

North West Community Council did not discuss alternative recommendations.

ATTACHMENTS

1. Business Plan and Funding Request from the Hammonds Plains Consolidated School Parent Teacher Association
2. Hammonds Plains Common Area Rate Catchment Area

A copy of this report can be obtained online at halifax.ca or by contacting the Office of the Municipal Clerk at 902.490.4210.

Report Prepared by: Krista Vining, Legislative Assistant, Office of the Municipal Clerk 902.490.6520



P.O. Box 1749
Halifax, Nova Scotia
B3J 3A5 Canada

Item No. 13.2.2

Request for North West Community Council Consideration		
<input checked="" type="checkbox"/> Agenda Item (Submitted to Municipal Clerk's Office by Noon at least 5 working days prior to the meeting)	<input type="checkbox"/> Added Item (Submitted to Municipal Clerk's Office by Noon at least one day prior to meeting)	<input type="checkbox"/> Request from the Floor
<p>Date of Meeting: February 10, 2020</p> <p>Subject: Hammonds Plains Area Rate Funding Request – Hammonds Plains Consolidated School Landscaping Project</p>		
<p>Motion for North West Community Council to Consider:</p> <p>That North West Community Council recommend that Halifax Regional Council approve a one-time withdrawal from the Hammonds Plains Common Area Rate in the amount of \$4,538.28 to the Hammonds Plains Consolidated School Parent Teacher Association to cover additional costs related the 2019 Hammonds Plains Consolidated School Landscaping project.</p> <p>Reason:</p> <p>In May 2019, the Hammonds Plains Consolidated School Parent Teacher Association submitted a Proposal and Business Plan to North West Community Council to landscape the school grounds of the Hammonds Plains Consolidated School with funding from the Hammonds Plains Common Area Rate. North West Community Council forwarded a recommendation to Halifax Regional Council to grant a one-time withdrawal of \$36,794.25 to complete the project. This recommendation was approved by Halifax Regional Council on June 4, 2019. For further information, please refer to attachment 2.</p> <p>Due to unforeseen cost over runs associated with the project, the Hammonds Plains Consolidated school submitted an additional funding request to North West Community Council on February 6, 2020 for an additional \$4,538.28 to cover the total cost of the project. For further information, please refer to attachment 1.</p> <p>In consultation with staff, and in keeping with past practice, requests for funding from the Hammonds Plains Common Area Rate surplus may be considered by North West Community Council with a recommendation for funding subject to Halifax Regional Council.</p> <p>Attachment 1: February 6, 2020 request from the Hammonds Plains Consolidated School PTA Attachment 2: May 2019 request from the Hammonds Plains Consolidated School PTA Attachment 3: Current Balance of Hammonds Plains Common Area Rate</p>		

Outcome Sought:

To provide the Hammonds Plains Consolidated School Parent Teacher Association with funding in the amount of \$4,538.28 from the Hammonds Plains Common Area rate to fully cover the cost of the 2019 landscaping project at the Hammonds Plains Consolidated School.

Councillor Matt Whitman

District 13

Attachment 1

Hello Northwest Community Councillors,

We would like to submit a funding request from the Hammonds Plains Community Area Rate to fund the additional costs which unexpectedly accumulated from the Hammonds Plains Consolidated School Landscaping project – funded by the Hammonds Plains Community Area Rate, approved in 2019. The project took place the last 2 weeks of August 2019 and was completed prior to the school year in September 2019.

The HPCS PTA was informed by the contractor after the work was completed that an additional \$4,538.28 including taxes were charged above the initial quote of \$36,748.25 due to:

- the very dry weather conditions, an additional 5 trips for watering plants and sod using water totes and fire hoses,
- an additional 40 cubic yards of soil was required to fill in and level off the back area
- additional cost for plants
- concrete was selected over stone for bench bases for longevity
- additional labour time not quoted

The HPCS PTA is requesting that The Northwest Community Council considers additional funding to cover these overages. It should be noted that the initial quote did not include a 15% contingency which would have covered these overruns.

Please see the attached copy of the initial quote plus the additional costs provided by the contractor.

Thank you for your time.

Jen Richardson

HPCS PTA Past President.

P.O. Box 1749
Halifax, Nova Scotia
B3J 3A5 Canada

Item No. 13.2.1

Request for North West Community Council Consideration

- | | | |
|--|---|--|
| <input checked="" type="checkbox"/> Agenda Item
(Submitted to Municipal Clerk's Office by Noon at least 5 working days prior to the meeting) | <input type="checkbox"/> Added Item
(Submitted to Municipal Clerk's Office by Noon at least one day prior to meeting) | <input type="checkbox"/> Request from the Floor |
|--|---|--|

Date of Meeting: May 13, 2019

Subject: Hammonds Plains Common Area Rate Funding Request – Landscaping for Hammonds Plains Consolidated School

Motion for North West Community Council to Consider:

That North West Community Council recommend that Halifax Regional Council authorize a one time contribution of \$36,794.25 from the Hammonds Plains Area Rate surplus to the Hammonds Plains Consolidated School Parent Teacher Association to landscape the school grounds.

Reason:

On June 19, 2018, Halifax Regional Council approved the Area Rates for fiscal 2018-19 and directed staff to update and combine the current Recreation Area Rate Policy and Interim Area Rates Guidelines into New Area Rate Administrative Order for 2019-2020. This policy is expected to return to Council for consideration in 2019. As part of the review, Council also directed the discontinuance of the Hammonds Plains Common Area Rate levied on each of the taxable residential and resource property assessments and that staff return with recommendations on the existing surplus. For further information please refer to the following:

February 12, 2018 staff report – Area Rate Review – June 19, 2018 Halifax Regional Council:
<https://www.halifax.ca/sites/default/files/documents/city-hall/regional-council/180619rc1416.pdf>

June 19, 2018 Halifax Regional Council Meeting Minutes:
<https://www.halifax.ca/sites/default/files/documents/city-hall/regional-council/c180619minutes.pdf>

In May 2019, the Hammonds Plains Consolidated School Parent Teacher Association submitted a funding proposal and business plan to landscape the school grounds

In consultation with staff, this proposal may be considered by North West Community Council with final approval at Regional Council, as a recommendation for funding from Hammonds Plains Common Area Rate surplus.

Attachments:

Attachment 1: Request for Funding: Landscaping for the Hammonds Plains Consolidated School.
Attachment 2: Balance of Hammonds Plains Common Area Rate

Outcome Sought:

To authorize funding for the landscaping of the Hammonds Plains Consolidated School grounds from the Hammonds Plains Common Area Rate surplus.

Councillor Matt Whitman

District 13



Our History

_____Hammonds Plains Consolidated School (HPCS) opened in 1968, a new community school welcoming the consolidation of the school of Upper Hammonds Plains and Hammonds Plains School. In the late 1980's, an addition was built on to HPCS and with the rapidly growing community of Hammonds Plains, the new addition did not allow for enough classrooms. During that time there were up to 9 portable classrooms on the school site. HPCS underwent additional renovations and upgrades in 1996.

Today

Today, the school has over 25 classrooms, a large gym, cafeteria, library, music room, resource rooms and learning centres. There are currently five portables onsite. Student enrolment for 2018-2019 was 577 students. HPCS welcomes grades primary to 5 in both English and French immersion programs.

Parent Teacher Association

HPCS has a dedicated Parent and Teacher Association that has provided enriched learning opportunities for the students of HPCS. Within the last 10 years, the PTA was able to successfully raise funds within the school community and secure grants to replace the playground equipment on both the primary playground and grades 1-5 playground. HPCS also has a large multipurpose field.

Our Community

The HPCS community encompasses the subdivisions of Highland Park, Yankeetown Rd., Maplewood, Hammonds Plains Rd., Glen Arbour, White Hills and the communities of Upper Hammonds Plains and Hammonds Plains.

Our playground structures welcome families from the community on a regular basis. The playgrounds frequently draw families to the school grounds both after school and on weekends for fun, fresh air and fitness.

The field is used regularly by community members enrolled in programs within the HRM Department of Recreation and local community programs such as soccer and baseball. The school is used each evening for recreation programs such as basketball and Girl Guides. The school is a gathering place for parents and guardians during these recreational events and children play and socialize on the playground equipment and surrounding areas. The school playground sees over 550 smiling and energetic faces more than 3 times per day during the school year.

Landscaping History and Existing Conditions

Despite more recent upgrades to the playground equipment, the school grounds and landscaping have not seen any improvements for over 10 years. Many areas of the playground are in very hard shape due to high traffic, age and poor grading. The wear and tear on the school grounds and common areas is showing significantly. There are several main areas where the grass has been worn away and what remains is dirt and mud.

Many years ago the PTA had benches installed as well as some trees. Grassy areas were planted for children to play. These benches have since rotted and had to be removed for safety along with some of the trees. Most the grass has been worn away due to a combination poor grading and use. The playground and surrounding school areas are in much need of landscaping and some common areas for socialization. As it stands currently, the playground is not inviting, nor pleasing for students or community members.

Our New Landscaping Plan

We are pleased to present you with a detailed plan and drawing of our new and improved landscaping proposal for our school community. While some areas will receive a facelift, the bulk of the plan will be along the school wall nearest to the playground. This area was designed with a park like feel. It is a green space that is welcoming and enjoyable. It contains buddy benches as well as two large patio areas with picnic tables that allow for Summer picnics, a seating area for parents and guardians as well as outdoor classroom space for teachers and students. Children will love paying tag on the pathways and having a rest in the shade. It will be a welcoming space that will be enjoyed for many years to come.

Thank You

Thank you for taking the time to review our proposal. We feel the new landscaping plan will be pleasing to both the community and students of HPCS. A fund-raising project of such magnitude would take several years of additional fundraising for our school community and in the interim the grounds would further deteriorate.

The total cost of the plan is \$36,794.25

Respectfully Submitted by Barb Bowers



*17 Beech Hill Road
Seabright, NS B3Z 3A5
902-233-2781
nick_hunsley34@hotmail.com*

**Hunsley & Associates Landscaping and Property
Services**

Date: April 1, 2019 Quote#: QUO040819CD

Quote to: Hammonds Plains Consolidated Elementary School

Prod.	Description	Price	Line Total
--------------	--------------------	--------------	-------------------

P001	Phase One: Front of School		
	<p><u>Right Side:</u> Excavating old shrubs and trees scraping off old grass, and regrading area for better drainage. All discarded trees, brush, and grubblings to be taken away to dump. Adding fresh new lawn soil, and sod installed. Adding quality garden soil for two large beds in the front and planting beautiful new shrubs and plants (low maintenance) in between windows of the front and in the large beds. Also, a row of shrubs to act as a wall between school and parallel sidewalk. Garden areas to then have brown mulch spread.</p>	<p>Materials: \$1,570.00</p> <p>Labor and Excavating: \$1,035.00</p>	\$2,605.00
	<p><u>Left Side:</u> Doors to corner of the Left Corner of the school: Excavating old shrubs, scraping off old grass, re-grading slope down the hill for proper drainage, then taking away all grubblings to dump for disposal. New lawn soil to be added and One pallet of sod laid over top. Garden soil added for garden bed and in between windows along the front. Once prepped, shrubs to be planted in bed and in between windows.</p>	<p>Materials: \$1,210.00</p> <p>Labor and Excavating: \$1,165.00</p>	\$2,375.00
	<p>Corner of School to Drain area and loop area; Including Drain: Using excavator to scrape off old grass and grade area for better drainage. Also excavating a 'T' drain to provide proper drainage where pavement meets the garden area by the bus loop. Drain to have perforated big O black piping, clear stone dravel We will also be cleaning out the beautiful memorial garden, trimming shrubs, and adding brown mulch to it. Fresh lawn soil and sod to be laid in front of garden and around transformer area. A new gravel/crusher dust path way to be installed between garden and transformer for easier access and a more durable walking surface. One additional shrub to be planted on the corner where the sidewalk and transformer almost meet. (This should entice the students to go around it and stay on the sidewalk and gravel made paths). We will also clean out the 'loop' crusher dust path way with the current red benches. New crusher dust to be applied to that</p>	<p>Materials: \$1,845.00</p> <p>Labor and Excavating: \$1,830.00</p>	\$3,675.00

<p>P002</p>	<p>Phase 2: Play Ground side of the school: Using excavator to dig out old shrubs, approx. 10, scrape off all old grass, and re-grade entire area. Grubbings taken to dump for disposal Creating 3-4 large garden beds, with quality garden soil, added shrubs and plants, and spreading brown mulch on top. Shrubs to also be planted in new garden soil along school in between each window with mulch spread on top as well. Crusher dust gravel pathway to go the full length of the school. Leading to 2-3 benches beside gardens, two separate pic-nick tables on patios with interlocking brick bases, and 2-3 exits to pavement towards playground. Patio areas to be 14'x14' using Alpine 60mm stone (colors and photos to be presented and discussed). Also, 4" of lawn soil to be spread everywhere else, with sod installed. Soil and mulch also added around three mature trees that are there. Plastic black pegged edged to separate sod from pathway. *Any extra sod will be able to repair muddy area with in ground bench by field</p> <p>*Option for crusher dust gravel patio pads under pic-nick tables rather than stone: →</p>	<p>Materials: \$10,790.00 Labor and Excavating: \$9,400.00</p> <p>Materials: \$9,570.00 Labor and Excavating: \$8,415.00</p>	<p>\$20,190.00</p> <p>or</p> <p>\$17,985.00</p>
<p>P003</p>	<p>Phase 3: Back Doors Area: Excavating 2-4 inches off the top to assist with drainage and allow for new materials on top. 2-4 inches of new lawn soil added where sod will be laid. Lay out of the area to have one garden bed in the center of each side with garden soil, shrubs, and mulch spread on top. A multi-directional pathway of crusher dust gravel to be connected from school doors sideway to P003 play ground pathway, with multiple directions to field, and classroom portables. Shrubs also planted in between windows to match other sides of the school.</p>	<p>Materials: \$1,425.00 Labor and Excavating: \$1,685.00</p>	<p>\$3,110.00</p>

Notes: Quote Valid for 30 Days ~ All prices are pre-tax, tax added at NS 15% HST.

Client: _____

Hunsley & Associates Landscaping and Property Services

~Dedicated to Exceeding Expectations~

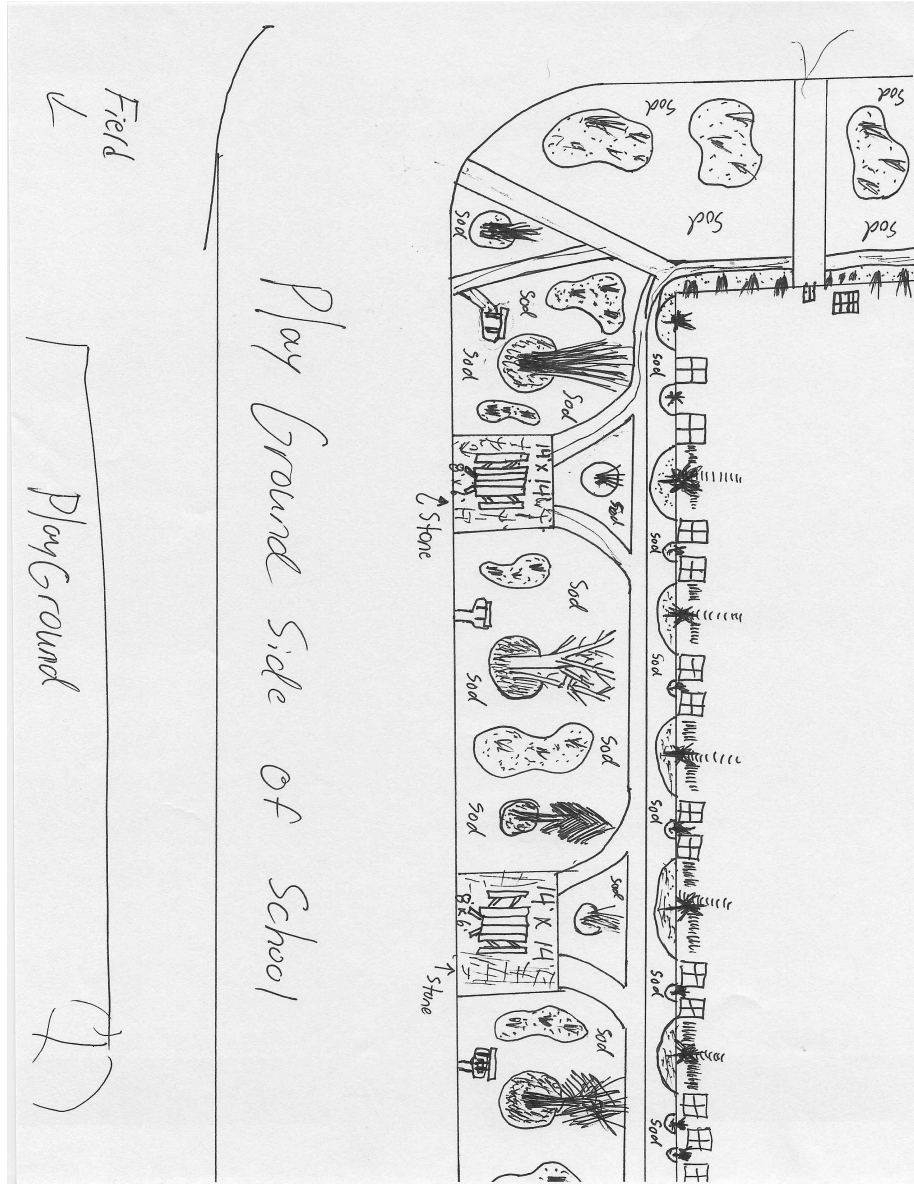

Hammond Plains Consolidated School

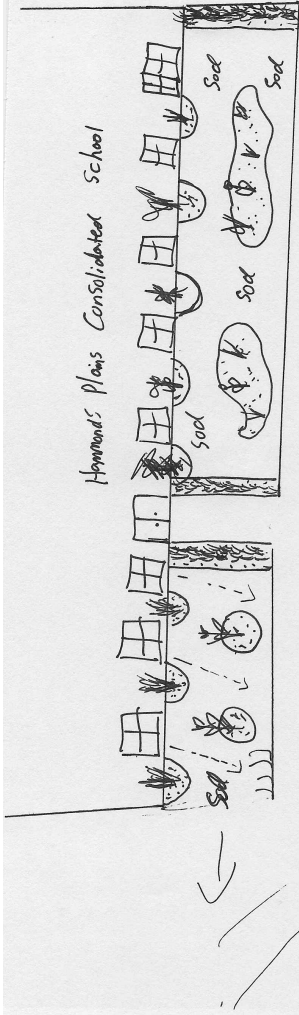

Front of School

Picnic tables
8x6 wide
Long

Attachment 2

Balance of Hammonds Plains Common Area Rate

		12	Cost Elements	Actual	Commitment	Assigned	%Asn/FoAnr
C135 Kingswood Ratepayers		13	4200 Area Rate Revenue				
C140 Prospect		14	4201 AreaRate Residential				
C142 Glengarry Estates HO		15	4206 Area Rate Resource				
C145 Westwood H Res Assoc		16	* Area Rate Revenue				
C160 Musquodoboit Harbour		17	5803 Transfer General Rat				
C170 Hammonds Plns Com.RT		18	* Other Revenue				
C180 Grand Lake Com. Ctr		19	** Total Revenues				
C185 District 3 Cap. Fund		20	9200 HR CATS Wage/Ben				
C190 Maplewood Subdivisio		21	9210 HR CATS OT Wage/Ben				
C196 Silverside Res.Assoc		22	* Compensation and Benefits				
C198 St. Marg/Fox Hollow		23	6399 Contract Services				
C210 LWF Recreation Ctr		24	* External Services				
R755 Private Roads		25	6999 Other Goods/Services				
		26	* Other Goods & Services				
		27	8001 Transf Outside Agenc				
		28	9000 Prior Yr. Sur/Def	393,932-		393,932-	100
		29	9001 Current Yr. Sur/Def				
		30	* Other Fiscal	393,932-		393,932-	
		31	** Total Expenditures	393,932-		393,932-	
		32	*** Net Surplus/Deficit	393,932-		393,932-	
		33					

Hammonds Plains Common Area Rate

Opening Balance - 01 April 2019

Date	Amount	Association
1-Apr-19	\$ 393,932	
4-Jun-19	<u>(36,794)</u>	HP Consolidated School
6-Jan-20	\$ 357,138	
29-Jan-19	(25,494)	Glen Arbour HOA
21-May-19	(150,000)	HP Community Centre
9-Dec-19	(25,000)	Highland Park RPA
9-Dec-19	(25,000)	Highland Park RPA
	<u>\$ 131,644</u>	Available as of 16 Jan 2020

Hammonds Plains Common Area Rate Catchment Area

