

LEGEND	PROPOSED	EXISTING
WATERMAIN & GATE VALVE		
SANITARY MANHOLE & PIPE		
STORM MANHOLE & PIPE		
UTILITY POLE & LINES		
EDGE OF PAVEMENT		
LOTLINE		
WATER LATERAL		
CATCH BASIN LEAD		
SWALE/DITCH		
CATCH BASIN		
FIRE HYDRANT		
SHRUB		
SILT FENCE		
FENCE		

#### NOTES

DRAWINGS SUBJECT TO APPROVAL PRIOR TO CONSTRUCTION.

5 4 3 2 1 0 METRES 5 10

SCALE 1:150

NO.	DESCRIPTION	CHK'D	DATE
3	ISSUED FOR REGULATORY REVIEW		18/11/2022
2	SITE PLAN ISSUED FOR APPROVAL		17/11/2022
1	ISSUED FOR COORDINATION		02/11/2022
0	ISSUED FOR REVIEW		28/10/2022

#### SEAL

**HGE Engineering Inc.**  
Land Surveyors  
Consulting Engineers

153 Sackville Drive, Suite 1, Lower Sackville, NS, B4C 2R3  
Phone: (902) 880-1354  
www.hge-inc.ca



#### CLIENT NAME & ADDRESS

**IRVING**  
Saint John, New Brunswick

#### PROJECT NAME & ADDRESS

**IRVING OIL  
GAS BAR**  
Bayers Road, Halifax, Nova Scotia

#### SHEET DESCRIPTION

## SERVICING PLAN

SHEET NO.	NUMBER OF SHEETS
C104	5
DRAWN BY: MLP	CHECKED BY: DTH
DATE: 18/11/2022	SCALE: 1:150 PROJECT NO: H22173

### C STANDARD TRENCH DETAIL

NTS

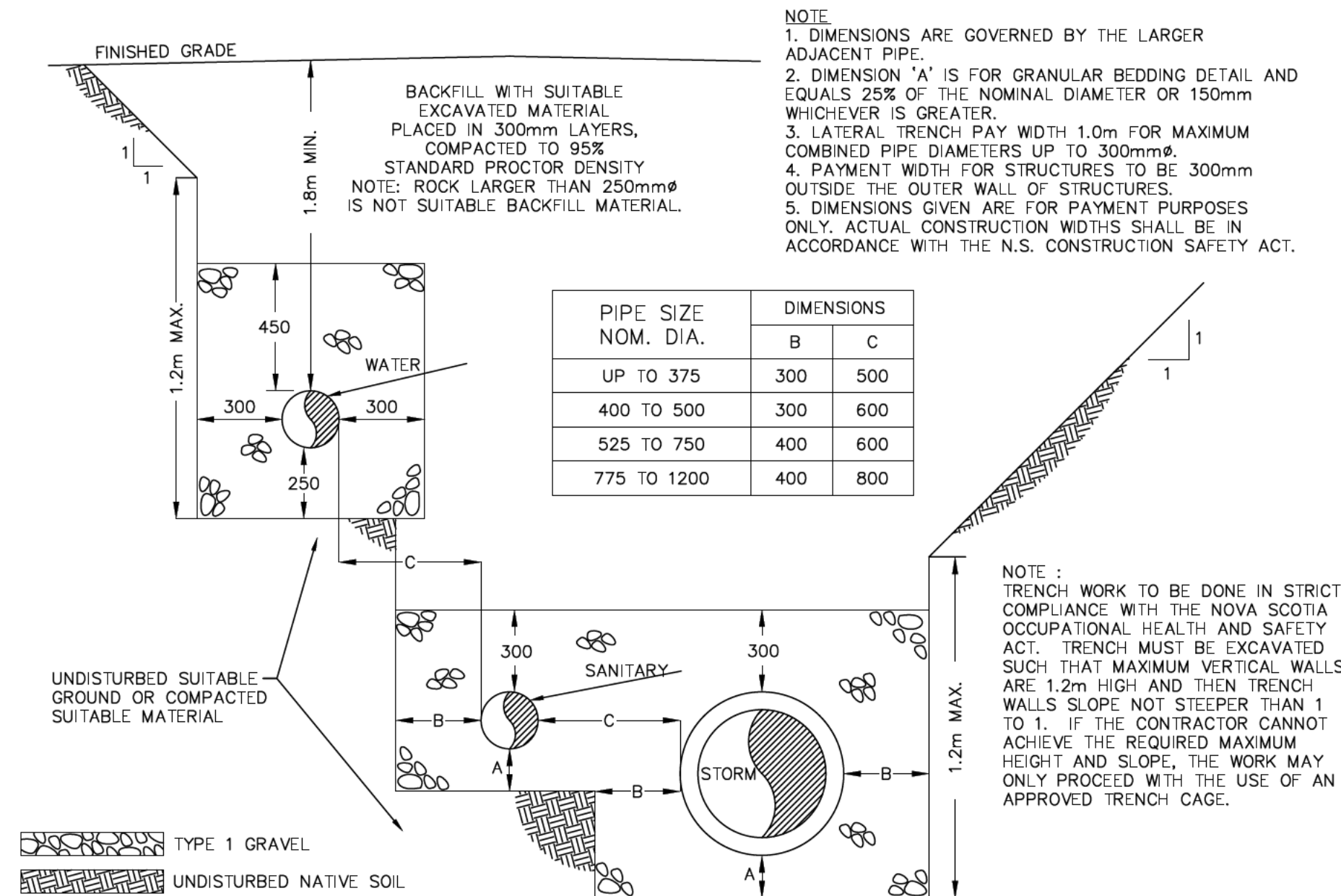

### D BUILDING CONCRETE PLAZA DETAILS

NTS

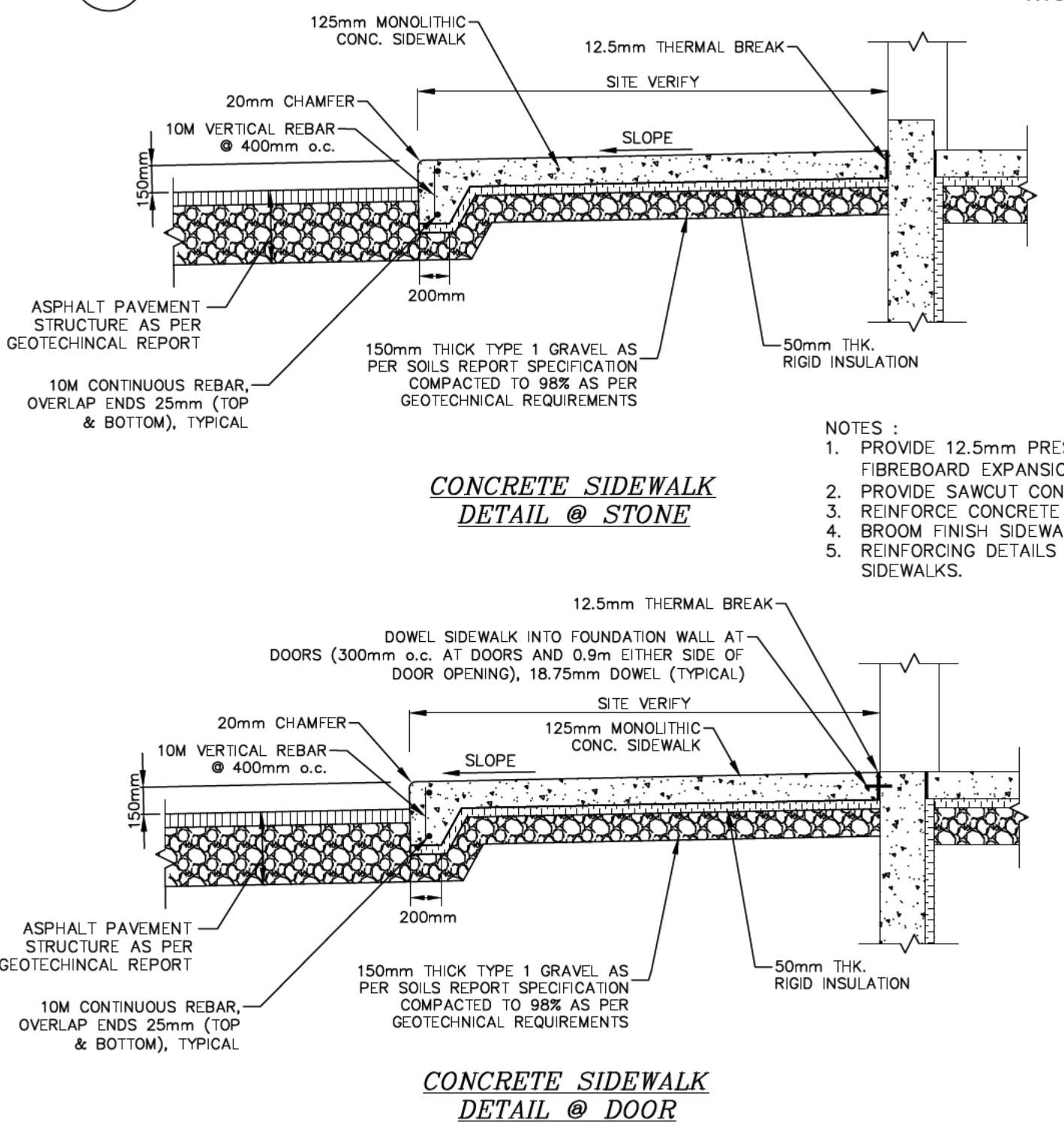

### E TYPICAL CATCHBASIN DETAIL

NTS

