

LEVEL 6 (TOTAL BALCONY AREA : 1,957 SQFT.)

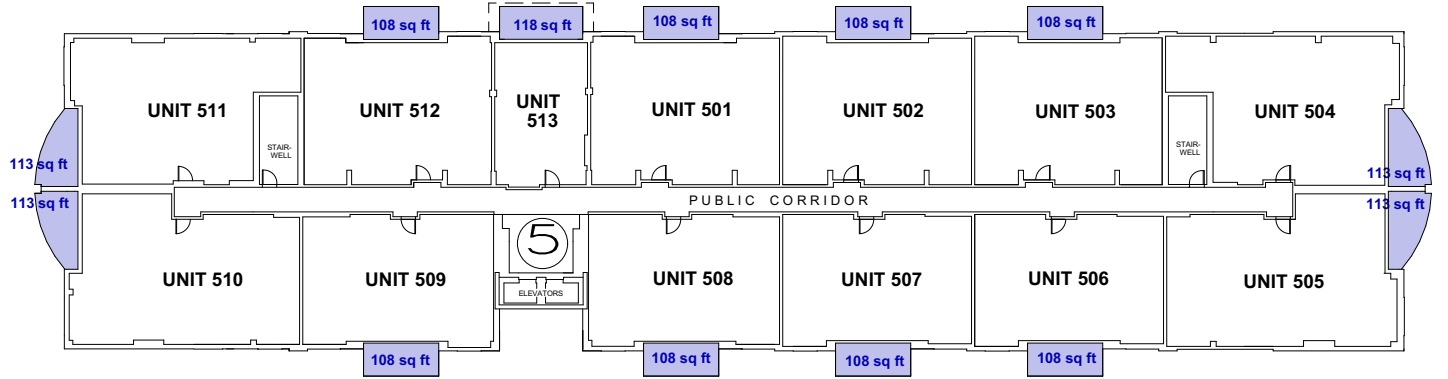

LEVEL 5 (TOTAL BALCONY AREA : 1,431 SQFT.)

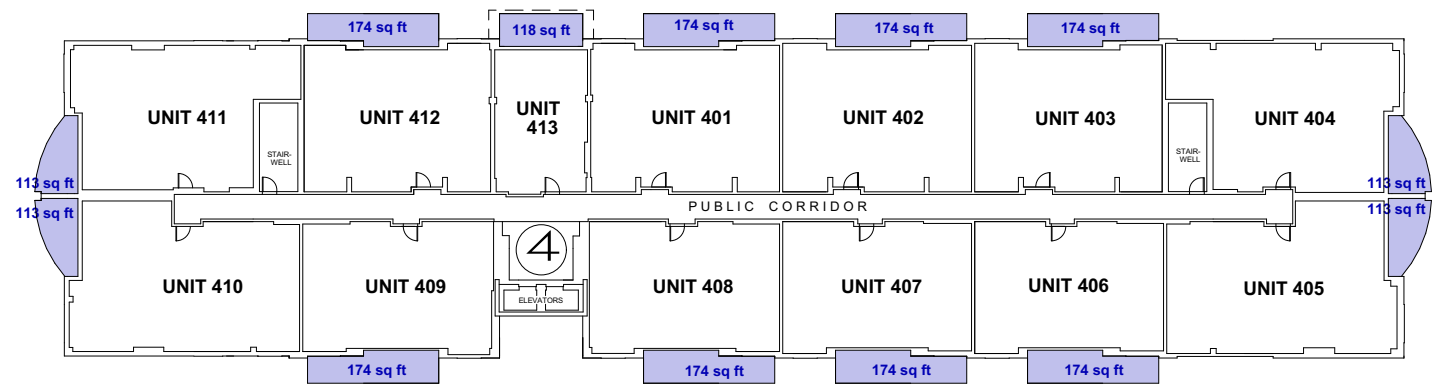

LEVEL 4 (TOTAL BALCONY AREA : 1,957 SQFT.)

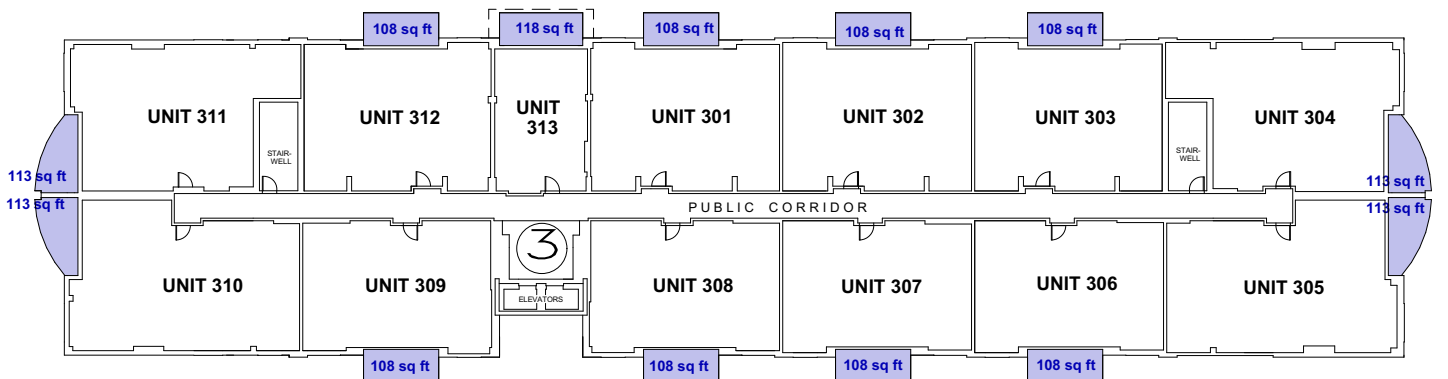

LEVEL 3 (TOTAL BALCONY AREA : 1,431 SQFT.)

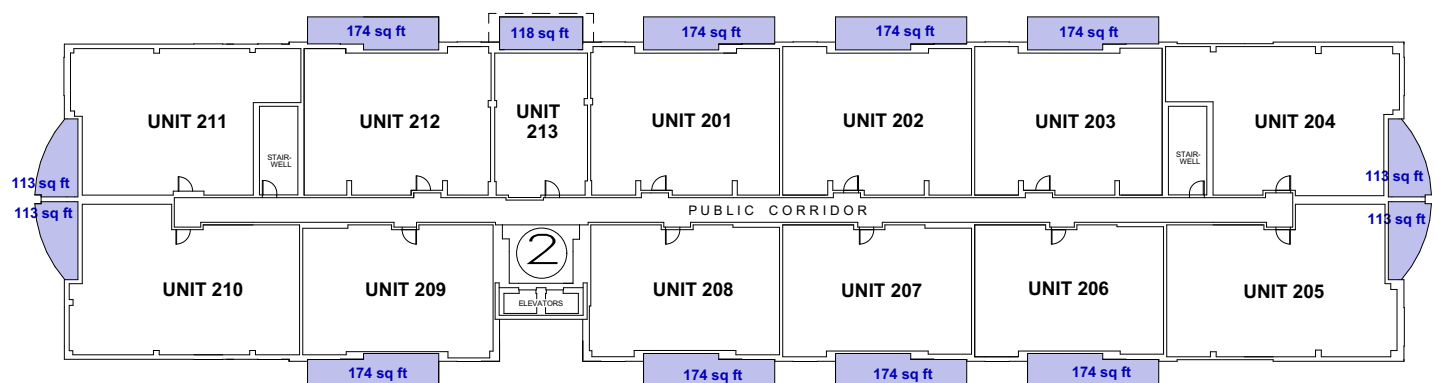

LEVEL 2 (TOTAL BALCONY AREA : 1,957 SQFT.)

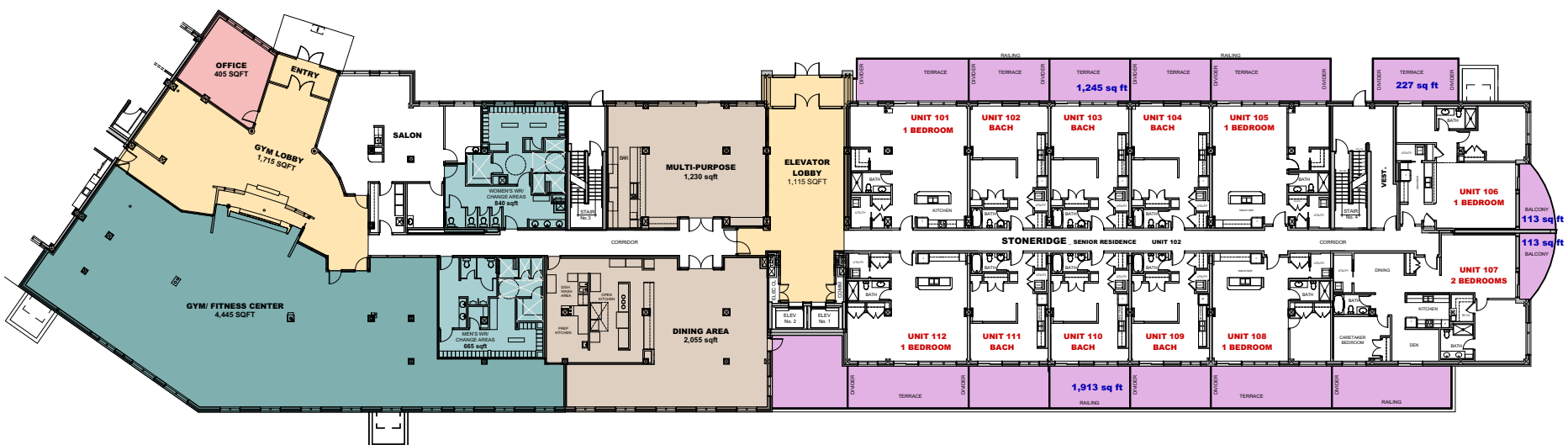

LEVEL 1 _ GROUND FLOOR (TOTAL BALCONY / TERRACE AREA : 3,611 SQFT.)

ALL LEVELS (1 - 12) OVERALL BALCONY AREA : 22,600 SQFT.)

SCALE : 1" = 40'-0"

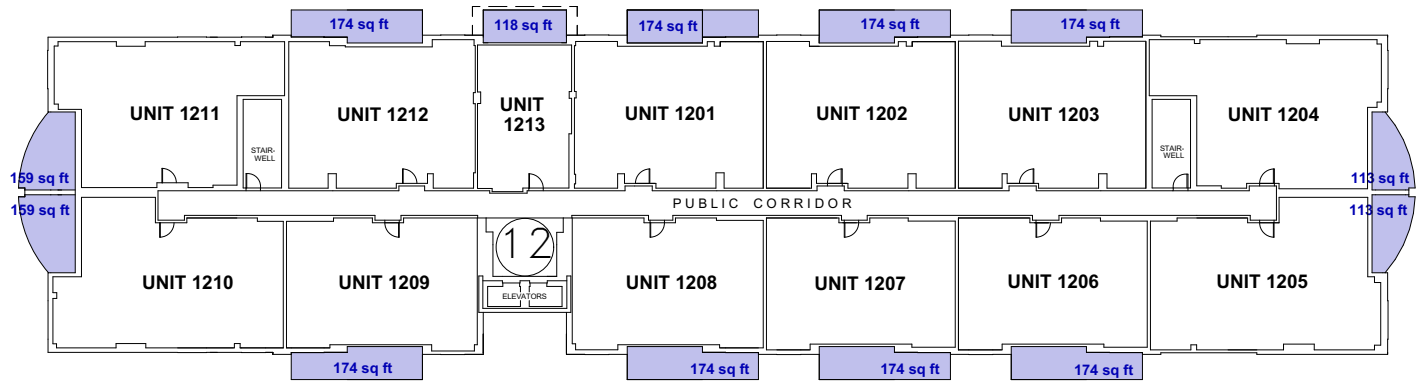

LEVEL 12 (TOTAL BALCONY AREA : 2,049 SQFT.)

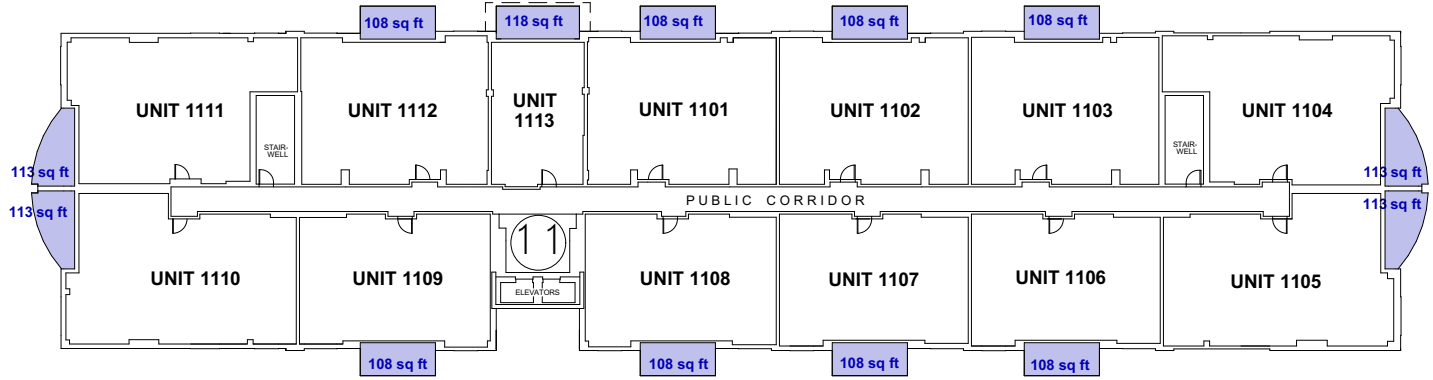

LEVEL 11 (TOTAL BALCONY AREA : 1,431 SQFT.)

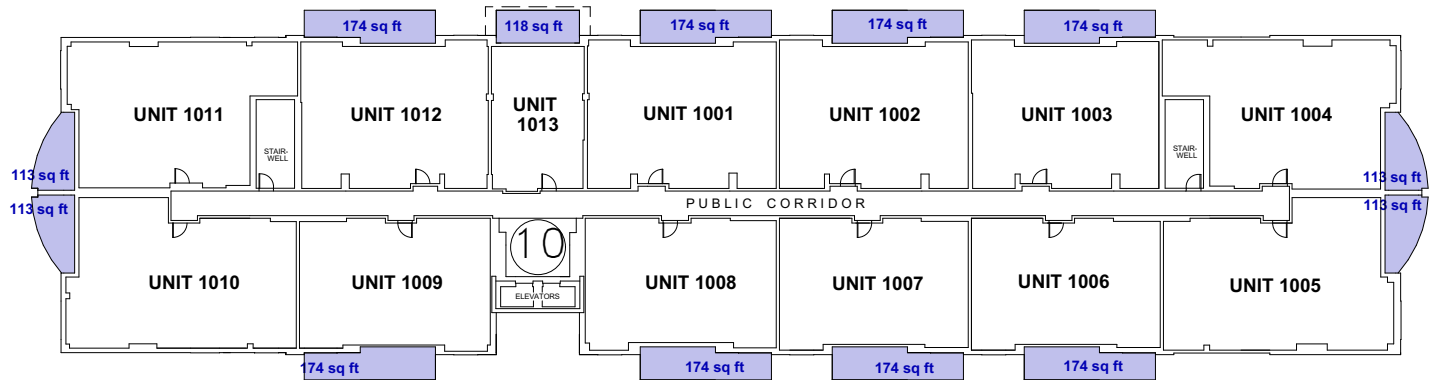

LEVEL 10 (TOTAL BALCONY AREA : 1,957 SQFT.)

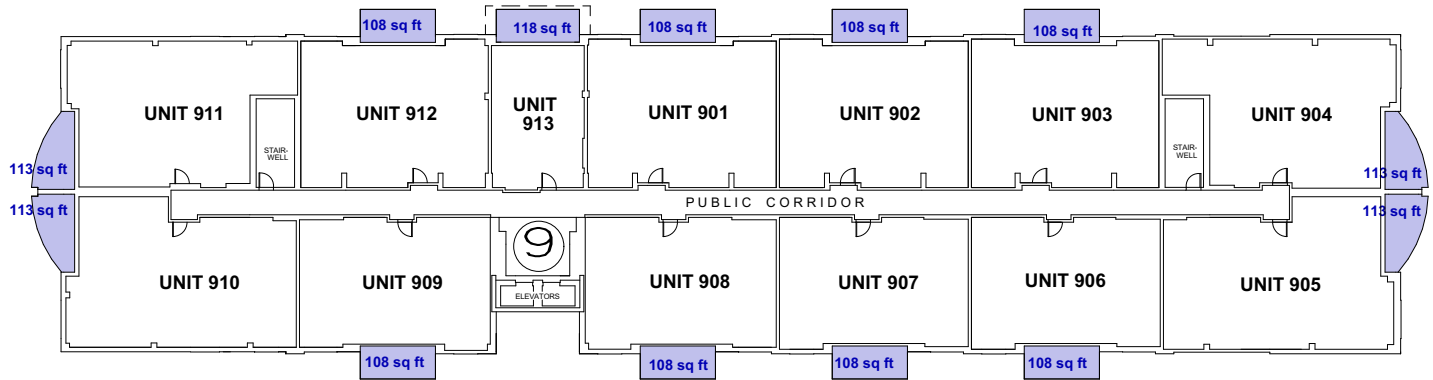

LEVEL 9 (TOTAL BALCONY AREA : 1,431 SQFT.)

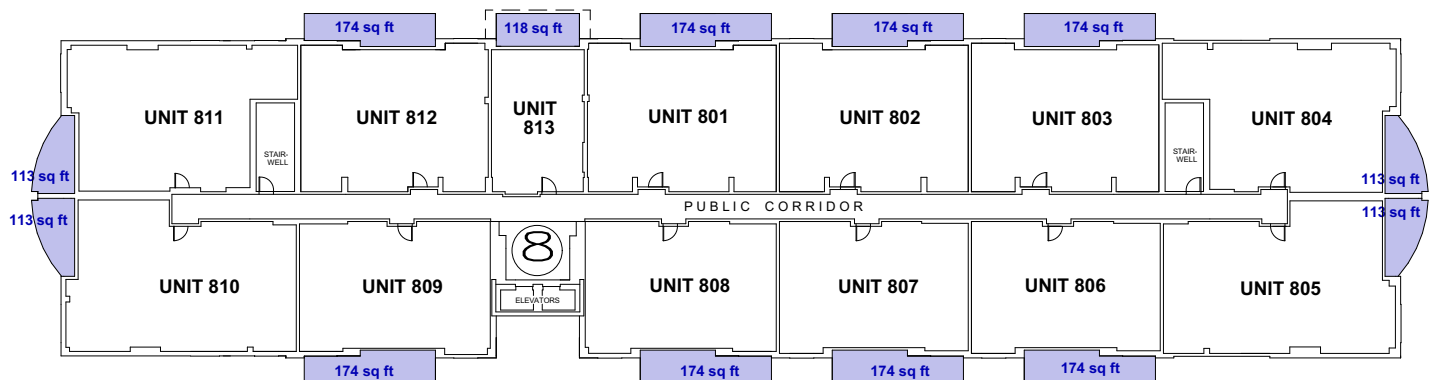

LEVEL 8 (TOTAL BALCONY AREA : 1,957 SQFT.)

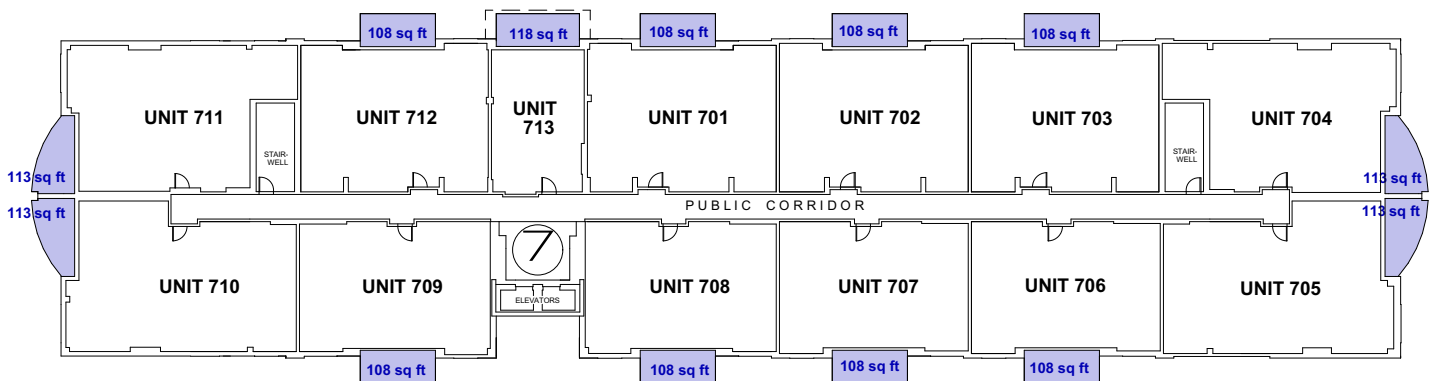

LEVEL 7 (TOTAL BALCONY AREA : 1,431 SQFT.)

SCALE : 1" = 40'-0"