

LEGEND

EXISTING		PROPOSED
	CURB STOP/GATE/BUTTERFLY VALVE	
	FIRE HYDRANT	
	SIAMESE SPRINKLER CONNECTION	
	CATCH BASIN/PIT	
	POWER POLE/LIGHT POLE	
	TREE	
	STREET SIGN	
	GAS LINE	
	WATER MAIN/SERVICE	
	SANITARY MANHOLE & PIPE	
	STORM MANHOLE & PIPE	
	COMBINED SEWER	
	PROPERTY LINE/BOUNDARY	
	BUILDING	

- ### NOTES
- EXISTING WATER, STORM & SANITARY SEWER, U/G CONDUIT AND GAS UNDERGROUND PIPING BASED ON HRM GIS SEWER DATA AND HERITAGE GAS INFORMATION. CONTRACTOR TO VERIFY EXACT LOCATIONS AND ELEVATIONS IN THE FIELD.
 - PROPERTY BOUNDARIES HAVE BEEN COMPILED FROM VARIOUS SOURCES AND ARE SUBJECT TO SURVEY.
 - ALL WORK SHALL BE COMPLETED IN ACCORDANCE WITH NOVA SCOTIA REGULATIONS AND HRM BY-LAWS, HALIFAX WATER DESIGN AND CONSTRUCTION SPECIFICATIONS (LATEST EDITION) AND HRM MUNICIPAL SERVICE SYSTEM GUIDELINES "RED BOOK" (LATEST EDITION).
 - CONTRACTOR TO DISCONNECT, PLUG AND ABANDON EXISTING WATER SERVICE LATERALS FOR CIVIC NOS. 1200 & 1216 AT THE MAIN. CONTRACTOR TO REMOVE VALVE BOXES AND VALVES/SHUT OFFS AFTER THE LATERALS HAVE BEEN DISCONNECTED FROM MAIN.
 - CONTRACTOR TO CAP AND ABANDON ALL EXISTING SEWER LATERALS FOR CIVIC NOS. 1200 & 1216 AT THE MAIN
 - ROOF FLOW CONTROL DRAINS AND PARKING LOT CB ICDS WILL CONTROL POST DEVELOPMENT STORM FLOWS TO PRE-DEVELOPMENT LEVELS.



36 OLAND CRESCENT
BAYERS LAKE BUSINESS PARK
HALIFAX, NOVA SCOTIA
OFFICE: (902) 455-1537
FAX: (902) 455-8479
WEB: www.sdmm.ca

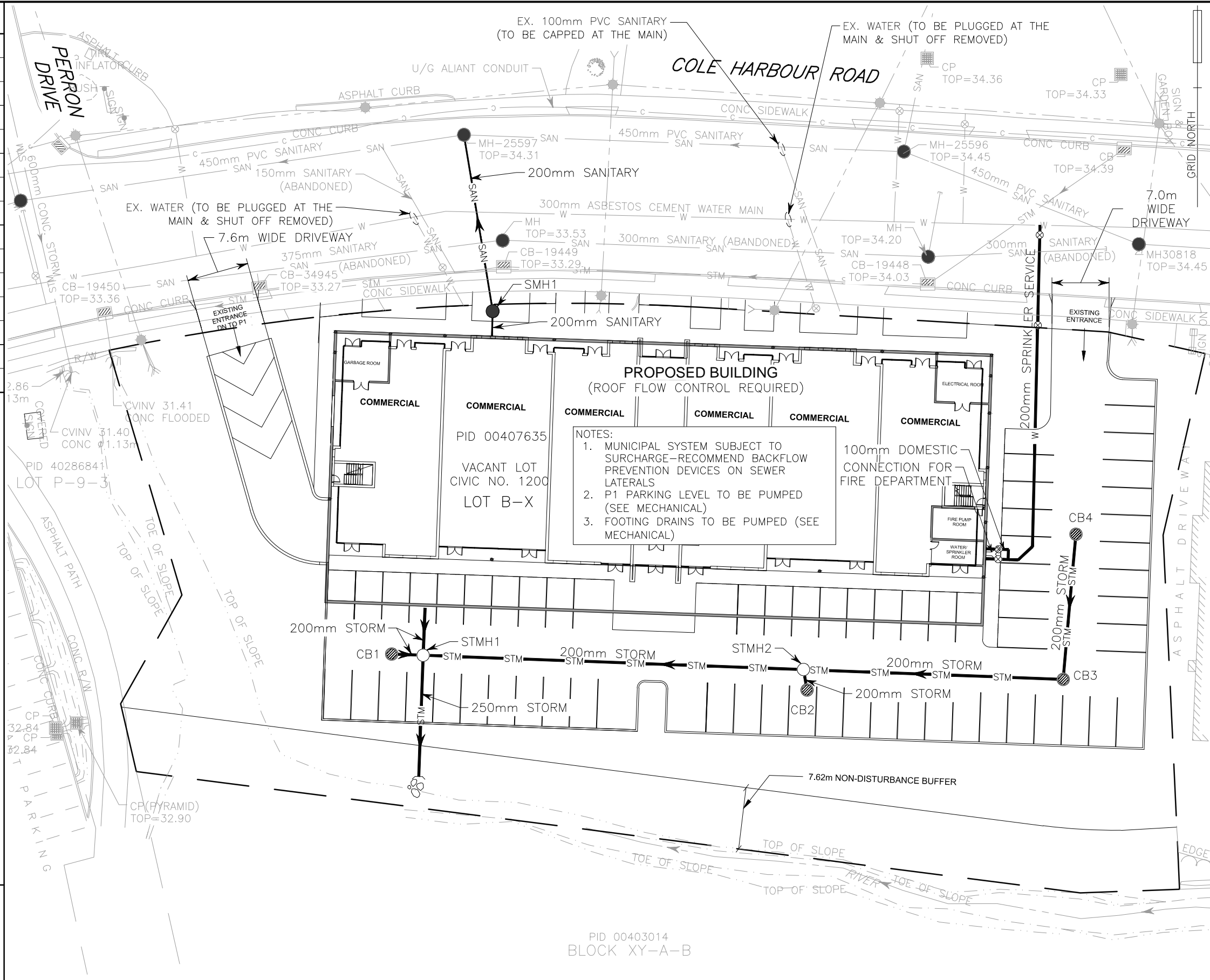

COLE HARBOUR ROAD
1200 COLE HARBOUR ROAD, DARTMOUTH NS

Servicing Schematic

Project No: 36460
Scale: 1:500
Date: 2021-09-02



WM FARES
ARCHITECTS

C1