

ATTACHMENT

C

PRELIMINARY
LANDSCAPE
PLANS



NUMBER OF UNITS

3 BR :	10
2 BR :	26 (1 included in Existing)
1 BR :	70 (1 included in Existing)
TOTAL:	106

GROSS AREA (SF)

TOTAL GROSS AREA:	125,810
OUTDOOR AMENITY:	19,350
INDOOR AMENITY:	2,525

① BALCONY
 ② DECK
 ③ GRADE-RELATED UNIT FENCED COURTYARD
 ④ ROOF TERRACE

● SHRUBBERY
 3 feet(1.0m) high min.

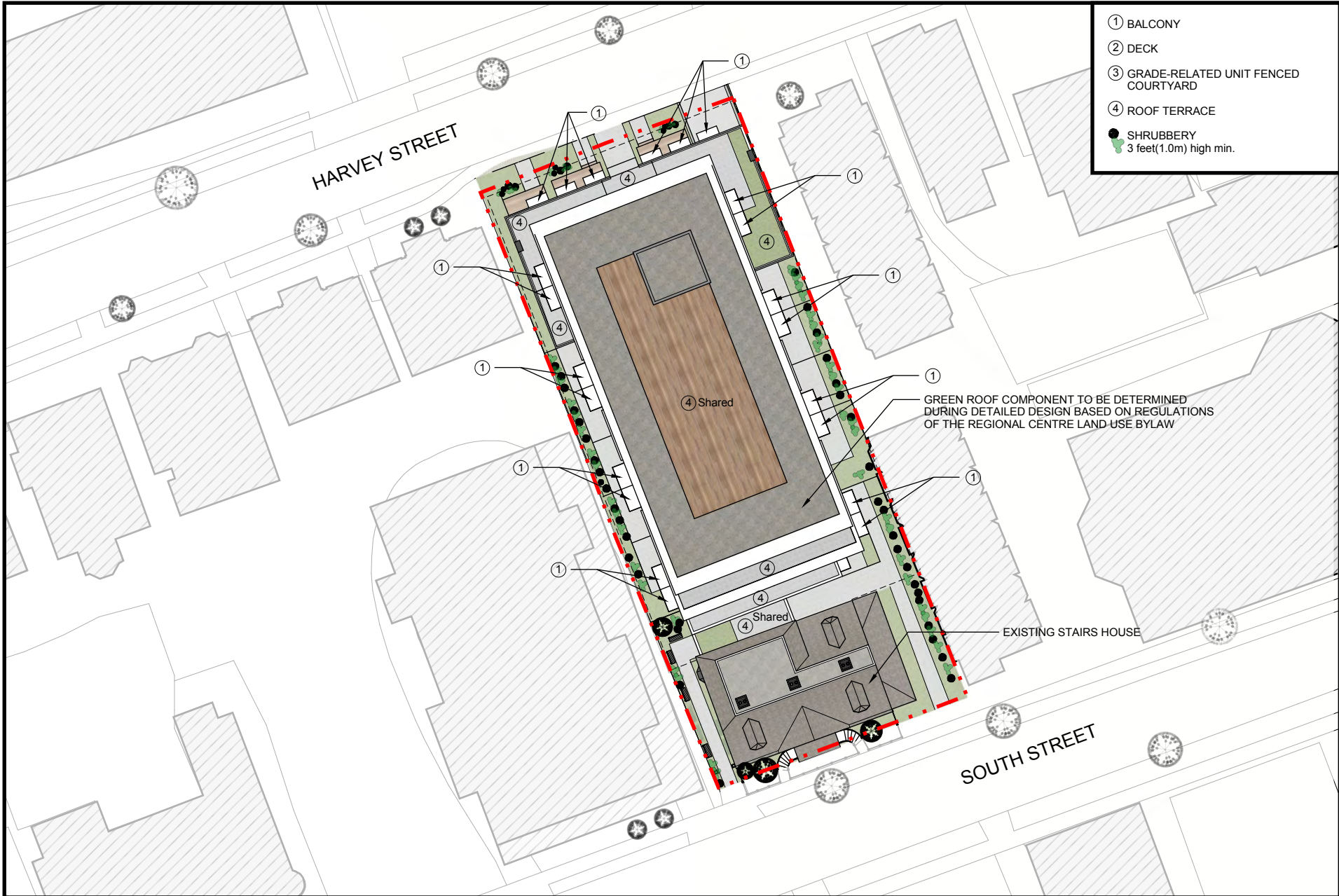

ARCHITECTURE | 49



STAIRS HOUSE
 Landscape Plan - Roof
 Halifax, Nova Scotia

PROJECT
 N



SCALE

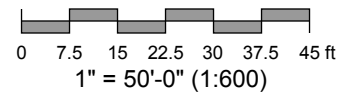

DATE: October 30, 2019

L-102