

1. THIS DRAWING IS INTENDED FOR DEVELOPMENT AGREEMENT PURPOSES AND IS NOT SUITABLE FOR CONSTRUCTION. DETAILED DESIGN IS REQUIRED.
2. EXISTING WATER, STORM & SANITARY SEWER UNDERGROUND PIPING BASED ON HALIFAX WATER INFORMATION. CONTRACTOR TO VERIFY EXACT LOCATIONS AND ELEVATIONS IN THE FIELD.
3. PROPERTY BOUNDARIES HAVE BEEN COMPILED FROM VARIOUS SOURCES AND ARE SUBJECT TO SURVEY.
4. ALL WORK SHALL BE COMPLETED IN ACCORDANCE WITH NOVA SCOTIA REGULATIONS AND HRM BY-LAWS, HALIFAX WATER DESIGN AND CONSTRUCTION SPECIFICATIONS (LATEST EDITION) AND HRM MUNICIPAL SERVICE SYSTEM GUIDELINES "RED BOOK" (LATEST EDITION).

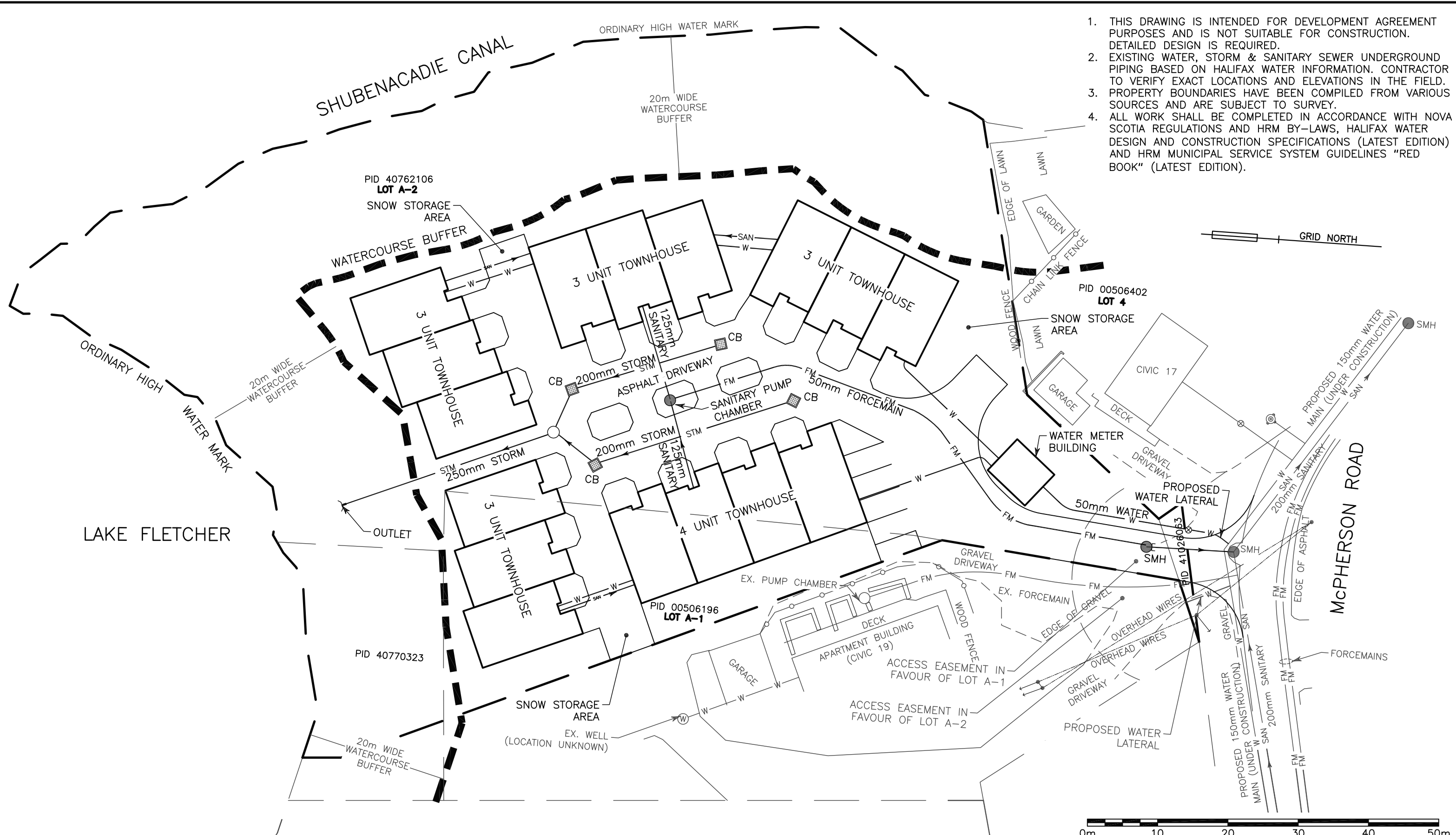

36 OLAND CRESCENT
 BAYERS LAKE BUSINESS PARK
 HALIFAX, NOVA SCOTIA
 OFFICE: (902) 455-1537
 FAX: (902) 455-8479
 WEB: www.sdmm.ca

TITLE: SERVICING SCHEMATIC
 LOCATION: STEEPLAKE ESTATES
 21 McPHERSON ROAD, FALL RIVER, NOVA SCOTIA

NOTES:
 1. PLAN IS METRIC.

Date:	APRIL 2, 2020	Project No. :	34978
Scale:	1:500	Sheet Size:	11"X17"
Prepared by:	G. MACLEAN		

1. THIS DRAWING IS INTENDED FOR DEVELOPMENT AGREEMENT PURPOSES AND IS NOT SUITABLE FOR CONSTRUCTION. DETAILED DESIGN IS REQUIRED.
2. PROPERTY BOUNDARIES HAVE BEEN COMPILED FROM VARIOUS SOURCES AND ARE SUBJECT TO SURVEY.
3. ALL WORK SHALL BE COMPLETED IN ACCORDANCE WITH NOVA SCOTIA REGULATIONS AND HRM BY-LAWS, HALIFAX WATER DESIGN AND CONSTRUCTION SPECIFICATIONS (LATEST EDITION) AND HRM MUNICIPAL SERVICE SYSTEM GUIDELINES "RED BOOK" (LATEST EDITION).
4. AUTOTURN VEHICLE TRACKING SIMULATION PROGRAM USED TO DEMONSTRATE VEHICLE SWEEP PATH.

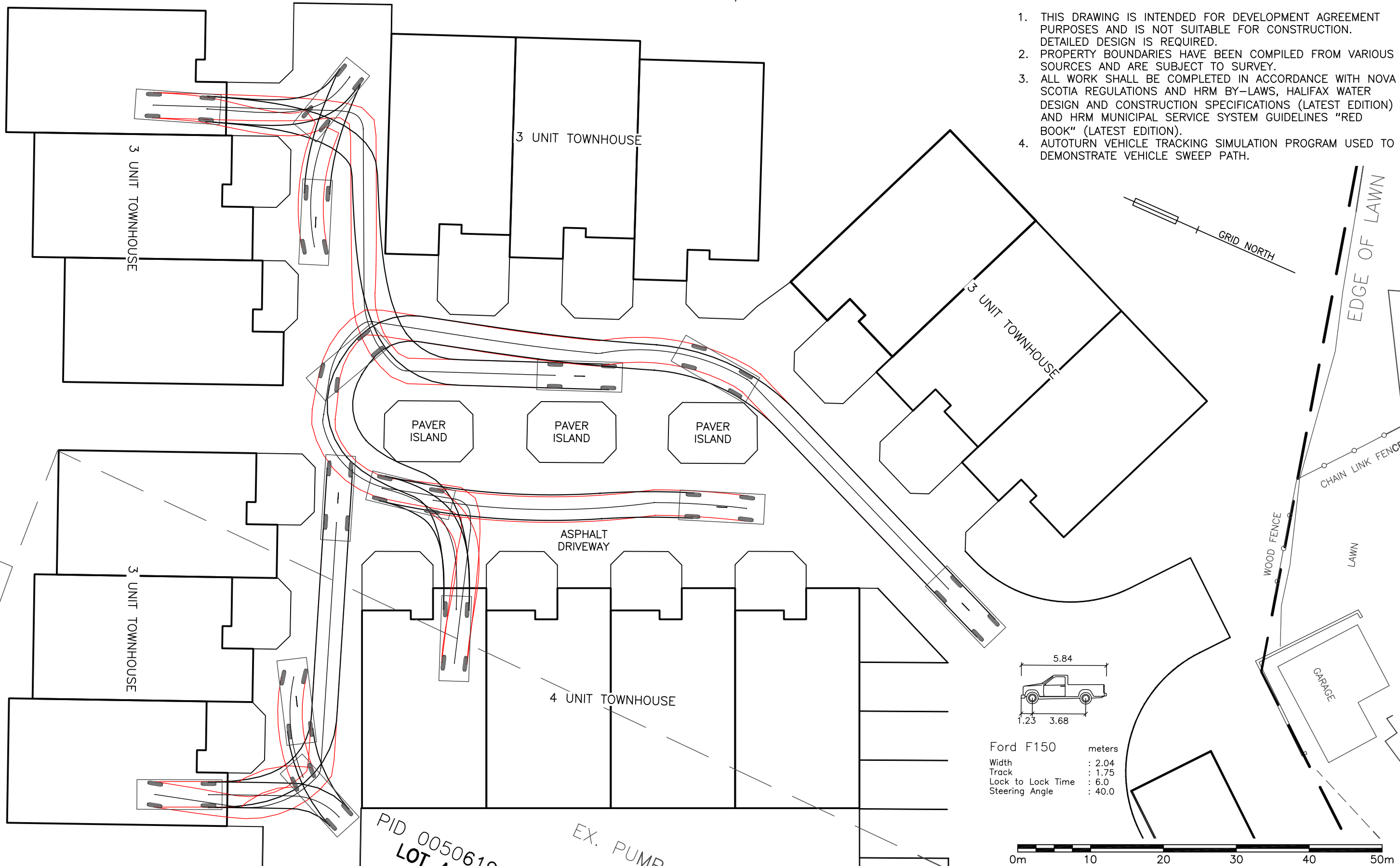

23

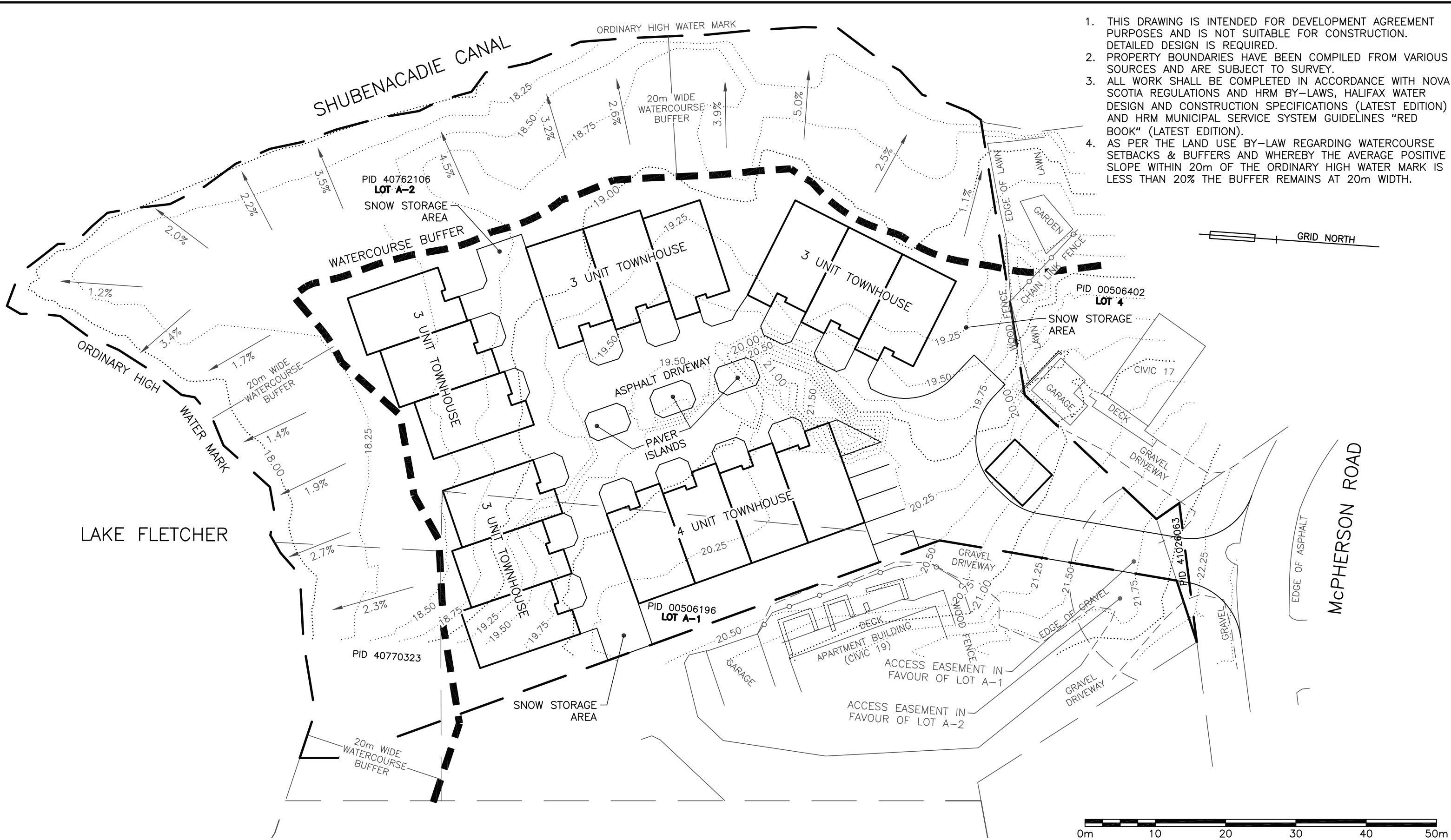

1. THIS DRAWING IS INTENDED FOR DEVELOPMENT AGREEMENT PURPOSES AND IS NOT SUITABLE FOR CONSTRUCTION. DETAILED DESIGN IS REQUIRED.
2. PROPERTY BOUNDARIES HAVE BEEN COMPILED FROM VARIOUS SOURCES AND ARE SUBJECT TO SURVEY.
3. ALL WORK SHALL BE COMPLETED IN ACCORDANCE WITH NOVA SCOTIA REGULATIONS AND HRM BY-LAWS, HALIFAX WATER DESIGN AND CONSTRUCTION SPECIFICATIONS (LATEST EDITION) AND HRM MUNICIPAL SERVICE SYSTEM GUIDELINES "RED BOOK" (LATEST EDITION).
4. AS PER THE LAND USE BY-LAW REGARDING WATERCOURSE SETBACKS & BUFFERS AND WHEREBY THE AVERAGE POSITIVE SLOPE WITHIN 20m OF THE ORDINARY HIGH WATER MARK IS LESS THAN 20% THE BUFFER REMAINS AT 20m WIDTH.



36 OLAND CRESCENT
 BAYERS LAKE BUSINESS PARK
 HALIFAX, NOVA SCOTIA
 OFFICE: (902) 455-1537
 FAX: (902) 455-8479
 WEB: www.sdmm.ca

TITLE: HRM WATERCOURSE BUFFER SKETCH
 LOCATION: STEEPLAKE ESTATES
 21 McPHERSON ROAD, FALL RIVER, NOVA SCOTIA

NOTES:
 1. PLAN IS METRIC.

Date:	APRIL 2, 2020	Project No. :	34978
Scale:	1:500	Sheet Size:	11"X17"
Prepared by:	G. MACLEAN		