

Construction Management Plan

September 2025

Dartmouth Cove Construction Ltd.
Ocean Breeze: Building B

400 Princess Margaret Blvd.



Project Number: 2025-03019

Prepared by: Dartmouth Cove Construction Ltd.

TABLE OF CONTENTS

| | | |
|--------|--|---|
| 1.0 | INTRODUCTION | 1 |
| 1.1 | PROJECT DESCRIPTION AND OBJECTIVES..... | 1 |
| 1.2 | PROJECT CONTACT INFORMATION | 1 |
| 2.0 | CONSTRUCTION SCHEDULE AND LOGISTICS..... | 2 |
| 2.1 | SCHEDULE..... | 2 |
| 2.2 | WORK WITHIN THE PUBLIC RIGHT-OF-WAY | 2 |
| 2.3 | HOURS..... | 3 |
| 3.0 | RELEVANT REGULATIONS & GUIDELINES | 3 |
| 3.1 | OCCUPATIONAL HEALTH & SAFETY REGULATIONS..... | 3 |
| 3.2 | MUNICIPAL REGULATIONS & GUIDELINES | 3 |
| 4.0 | VEHICLE AND PEDESTRIAN MANAGEMENT | 4 |
| 4.1 | VEHICULAR TRAFFIC CONTROL | 4 |
| 4.1.1 | Payment of Applicable Fees..... | 4 |
| 4.1.2 | Vehicular Hazard Assessment..... | 4 |
| 4.1.3 | Traffic Control Plan Preparation & Monitoring | 4 |
| 4.1.4 | Notifications of Traffic Closures..... | 4 |
| 4.1.5 | Traffic Control Element Inspection & Maintenance | 4 |
| 4.1.6 | Changes to Traffic Control Plans..... | 5 |
| 4.1.7 | Emergency Vehicle Access..... | 5 |
| 4.1.8 | Traffic Control Plans & Haul Route Plan | 5 |
| 4.1.9 | Haul Route Plan | 6 |
| 4.1.10 | Parking..... | 6 |
| 4.2 | PEDESTRIAN MANAGEMENT..... | 7 |
| 4.2.1 | Bus Stop Relocation | 7 |
| 4.2.2 | Payment of Applicable Fees..... | 7 |
| 4.2.3 | Pedestrian Hazard Assessment..... | 7 |
| 4.2.4 | Pedestrian Management Plan Preparation & Monitoring..... | 7 |
| 4.2.5 | Notifications of Pedestrian Closures..... | 8 |
| 4.2.6 | Pedestrian Management Plan Compliance | 8 |
| 4.2.7 | Changes to Pedestrian Management Plans..... | 8 |
| 4.2.8 | Pedestrian Management Plans..... | 8 |

| | | |
|--------|--|----|
| 4.2.9 | Pre-Project Hazard Assessment..... | 9 |
| 4.2.10 | Visually Impaired Persons..... | 9 |
| 4.2.11 | Accessibility | 9 |
| 5.0 | CONSTRUCTION SITE PROTECTION AND HOARDING | 10 |
| 5.1 | SITE PROTECTION AND HOARDING MATERIALS | 10 |
| 5.1.1 | Fencing..... | 10 |
| 5.1.2 | Covered Ways | 10 |
| 5.1.3 | Snow Removal | 10 |
| 5.1.4 | Site Lines..... | 10 |
| 5.1.5 | Emergency Access & Egress..... | 11 |
| 5.1.6 | Reinstatement of Public Property | 11 |
| 5.2 | SITE PROTECTION AESTHETICS..... | 11 |
| 5.3 | SIGNAGE..... | 11 |
| 5.3.1 | Project Management Plan Renderings | 11 |
| 5.3.2 | Pedestrian Detour Wayfinding | 12 |
| 6.0 | LIFTING, HOISTING AND CRANE OPERATIONS | 12 |
| 6.1 | NAVIGATION CANADA & TRANSPORT CANADA REGULATORY APPROVALS | 12 |
| 6.2 | OPERATIONS ABOVE THE PUBLIC REALM | 12 |
| 7.0 | ON-SITE CONDITIONS | 13 |
| 7.1 | SITE SAFETY AND SECURITY | 13 |
| 7.1.1 | Access & Egress Gates | 13 |
| 7.1.2 | Hazard Warning Signage..... | 13 |
| 7.1.3 | Gate Locking & Monitoring..... | 13 |
| 7.1.4 | Hoarding Signage..... | 13 |
| 7.1.5 | Inspection Reports..... | 13 |
| 7.1.6 | Dangerous Activities | 13 |
| 7.1.7 | Emergency Contact Information..... | 14 |
| 7.1.8 | After-hours Lighting..... | 14 |
| 7.1.9 | Smoking Area | 15 |
| 7.2 | MATERIAL HANDLING, LOADING/UNLOADING, DELIVERY, AND VEHICLE STAGING..... | 15 |
| 7.3 | ENVIRONMENTALCONTROLS..... | 15 |
| 7.3.1 | Street & Right-of-Way Cleaning..... | 15 |
| 7.3.2 | Stormwater Management and Runoff Pollution | 15 |
| 7.3.3 | Noise Pollution..... | 16 |
| 7.3.4 | Dust Pollution | 16 |

| | |
|---|----|
| 7.3.5 Emissions Control | 16 |
| 7.3.6 Rodent Control | 16 |
| 7.3.7 Light Pollution | 17 |
| 8.0 COMMUNITY ENGAGEMENT & NOTIFICATION..... | 18 |
| 8.1 PRE-CMP COMMUNITY ENGAGEMENT | 18 |
| 8.2 SCHEDULED COMMUNITY NOTIFICATIONS | 18 |
| 8.3 CLOSURE NOTIFICATION REQUIREMENTS | 18 |
| 9.0 PERMIT & NOTIFICATION REQUIREMENTS | 18 |
| 10.0 REGULATION & ENFORCEMENT | 19 |
| 10.1 INSPECTION & MONITORING | 19 |
| 11.0 SUMMARY | 20 |
| Appendices | A |
| Appendix A – Excavation, Substructure, and Superstructure Plan CMP Drawings | A |
| Encroachment Plan..... | A |
| Crane Encroachment Plan | A |
| Pedestrian Management Plan–All Phases..... | A |
| Traffic Control Plan –All Phases..... | A |
| Haul Route Plan– All Phases..... | A |
| Appendix B–Development Information Sign..... | B |
| Appendix C–Draft Notification Letter | C |
| Appendix D–Monthly Project Update Letter..... | D |
| Appendix E – Rodent Control Specifications & Templates | E |
| Contract Box Specifications..... | E |
| Bait Trap Specifications | E |
| Appendix F – Construction Management Plan Change Request | F |
| Appendix G – Construction Management Plan Inspection Sheet..... | G |
| Appendix H – Hazard Assessment..... | H |

1.0 INTRODUCTION

1.1 PROJECT DESCRIPTION AND OBJECTIVES

Dartmouth Cove Construction Ltd. is proposing to develop a 14-story (+ Amenity) and 1 level of underground parking apartment building, located at 400 Princess Margaret Blvd, Dartmouth.

Dartmouth Cove Construction Ltd., has prepared this Construction Management Plan (CMP) to reduce negative impacts to the community as a result of construction activities. This CMP is intended to be an evolving document to help guide the project team to mitigate impacts to the adjacent community before they arise and to address unforeseen issues. CMP drawings can be found in **Appendix A** and were prepared by Dartmouth Cove Construction Ltd.

Should any changes be required to any aspect of this CMP, an email and hard copy of the proposed changes shall be sent to HRM for review a minimum of 10 days prior to their proposed implementation. Changes will only be implemented following approval from HRM.

1.2 PROJECT CONTACT INFORMATION

The project team for the proposed development consists of:

| | |
|---------------------------|--|
| Owner: | Basin Heights Community GP Ltd. 50 Kings Wharf PL, Dartmouth, NS, B2Y0B4 |
| Site Contractor: | Dartmouth Cove Construction Ltd 50 Kings Wharf PL, Dartmouth, NS, B2Y0B4 24 Hour Emergency Contact: Travis England 902-210-6672 |
| Traffic Control Services: | Frontline traffic services |
| Connection to services: | Dexter construction |
| Rodent Control Services: | TBD |

2.0 CONSTRUCTION SCHEDULE AND LOGISTICS

2.1 SCHEDULE

- | | | |
|------------------|--|------------|
| • Excavation | (September 30, 2025 – November 30, 2025) | 2 Months |
| • Substructure | (October 1, 2025 – December 15, 2025) | 2.5 Months |
| • Superstructure | (January 1, 2026 – October 31, 2026) | 10 Months |

From start to completion, the project will take approximately 2 years.

2.2 WORK WITHIN THE PUBLIC RIGHT-OF-WAY

As **Basin Heights Community GP Ltd.** owns the lands directly east and west of the proposed development, the Excavation, Substructure and much of the Superstructure Phase will not require an encroachment onto HRM property.

Each project phase has been planned such that there is no encroachment into the Halifax Regional Municipality (HRM) right-of-way (ROW). Extents of each project phase can be seen on the Encroachment Plans in **Appendices A**.

Currently, **Dexter Construction** is carrying out the infrastructure expansion works for public services and road improvements, with all necessary ROW permits in place. This is a separate project led by Basin Heights Community GP Ltd. Under this contract, the utility connection works are also planned, which means no ROW work will be required for Ocean Breeze Building B.

It is not anticipated that work will be required within the HRM ROW during fencing installation and removal as fencing can be installed from behind the public ROW and staged within the existing Princess Margaret Blvd. Additional information regarding fencing installation and removal is provided in **Section 5.0**. Anticipated dates for this work are as follows:

- | | |
|--|--------------------|
| • Excavation, Substructure, Superstructure fencing Installation | September 15, 2025 |
| 1 Excavation, Substructure, Superstructure fencing Removal | October 30, 2027 |

2.3 HOURS

- Monday to Friday: 7:00 a.m. – 7:00 p.m.
- Saturdays: 8:00 a.m. – 7:00 p.m.
- Sundays, Statutory Holidays, & Remembrance Day: 9:00 a.m. – 7:00 p.m.
- Work Within First Street: 9:00 a.m. – 4:00 p.m.

Construction will be completed during daytime hours to avoid interruptions to residents in the evenings and night. Construction activities must adhere to all restrictions outlined in the HRM Noise Bylaw (N-200). Work within Princess Margaret Blvd will be restricted as per the requirements of the HRM Traffic Control Manual Supplement (TCM).

3.0 RELEVANT REGULATIONS & GUIDELINES

3.1 OCCUPATIONAL HEALTH & SAFETY REGULATIONS

This CMP shall be utilized in agreement with all applicable Provincial and Federal Occupational Health and Safety Regulations. At a minimum, construction activities must always meet the standards of:

- a) National Building Code of Canada, as adopted and modified under the Building Code Act and the Nova Scotia Building Code Regulations made under that Act;
- b) Nova Scotia Occupational Health and Safety Act, and the Nova Scotia Occupational Safety General Regulations made under that Act;
- c) The Transportation Association of Canada (TAC)'s Manual of Uniform Traffic Control Devices for Canada (MUTCDC); and
- d) Nova Scotia Temporary Workplace Traffic Control Manual (NSTCM).

3.2 MUNICIPAL REGULATIONS & GUIDELINES

In addition to the Provincial and Federal standards referenced in **Section 3.1**, this CMP shall be utilized in agreement with and meet, at a minimum, the standards of all relevant municipal by-laws including, but not limited to, the following:

- S-300 Streets;
- E-200 Encroachments;
- B-201 Building;
- N-200 Noise;
- T-600 Trees;
- S-900 Controlled Access Streets;
- T-400 Truck Routes;
- W-101 Discharge into Public Sewers;
- B-600 Blasting; and
- HRM TCM Supplement.

4.0 VEHICLE AND PEDESTRIAN MANAGEMENT

4.1 VEHICULAR TRAFFIC CONTROL

This project site is in a dense urban environment which poses specific risks related to vehicular traffic. This CMP identifies vehicle traffic controls to protect motorists, the public, and on-site workers.

Prior to any construction activity, all temporary workplace traffic control devices and signage will be in place as per the Nova Scotia Temporary Workplace Traffic Control Manual (latest edition) in accordance with the CMP drawings.

Ends of F-Type concrete barriers at starts of temporary sidewalks shall have reflective tape complete with contrasting colors to assist in identifying temporary crosswalks. Similar reflective tape with contrasting colors will be provided along the sides of F-Type concrete barriers, near their tops, both on the vehicular traffic side and the pedestrian traffic side to assist in delineation of travel ways and walkways at night.

4.1.1 Payment of Applicable Fees

Payment of all applicable fees will be made in accordance with HRM Administrative Order 15 (AO15).

4.1.2 Vehicular Hazard Assessment

See **Appendix H** for vehicular and pedestrian hazard assessment information which validates **Dartmouth Cove Construction Ltd.**'s rationale for requiring street encroachments and temporary sidewalks.

4.1.3 Traffic Control Plan Preparation & Monitoring

Separate Traffic Control Plans (TCPs) have been prepared as required for each project phase in accordance with the standards identified in the TAC Manual of Uniform Traffic Control Devices, the NSTIR Temporary Workplace Traffic Control Manual, and the HRM Traffic Control Manual Supplement.

TCPs have been prepared by Dartmouth Cove Construction Ltd. The TCPs illustrate the proposed signage which will be installed to warn vehicular traffic ahead of, and throughout, the construction zone. Traffic control features and methods as well as information related to the TCPs are provided in **Sections 4.1.8**.

The intervention within the ROW is being carried out by Dexter Construction under our development contract, which is currently underway. Additionally, the traffic control plans required for Ocean Breeze Building B will be developed by Big Guy Snow Removal & Traffic Services (902-410-4915).

4.1.4 Notifications of Traffic Closures

The contractor shall notify HRM and the public to proposed traffic closures as outlined in **Section 8.3**. The delivery vehicles are expected to wait inside lot 1.

4.1.5 Traffic Control Element Inspection & Maintenance

All TCPs will be implemented and monitored by a Certified Traffic Control Company and its team of certified Traffic Control Persons (as recognized by the Nova Scotia Department of Transportation and Infrastructure Renewal). Construction warning signage will be displayed throughout the approaches, to and adjacent to, the project site in accordance with the Nova Scotia Temporary Workplace Traffic Control Manual. The Site Contractor and Certified Traffic Control Company will inspect traffic control

Appendix G for a sample construction management plan element inspection sheet to be completed by both Site Contractor and Certified Traffic Control Company.

4.1.6 Changes to Traffic Control Plans

Requests for modifications to TCPs will be sent to HRM for approval a minimum of 10 days prior to their proposed implementation.

4.1.7 Emergency Vehicle Access

Emergency vehicle access to the project site will always be maintained throughout the life of the project. The existing hydrant along Caledonia Road will remain open to emergency vehicles and personnel throughout construction.

In cases of emergencies, on-site workers will exit the project site through gates along Princess Margaret Blvd respectively. These gates will always remain unlocked when workers are on site to allow emergency response units to access the site.

4.1.8 Traffic Control Plans & Haul Route Plan

Traffic Control, Encroachment, and Haul Route, are provided in **Appendices A**.

Excavation Phase Traffic Control

During the Excavation Phase, construction fencing will be set up along the rest of the perimeter of the site. These barriers are intended to separate the general public from construction activities and can be seen in **Appendix A**.

Work vehicles and deliveries will enter and exit the site through marked gates located at the northeast corner of the site. This entry/exit point will be accessed as shown on the Haul Route Plan in **Appendix A**.

The installation of construction fencing will remain in place for the duration of the project.

Substructure Phase Traffic Control

See above Excavation Phase.

Superstructure Phase Traffic Control

See above Excavation Phase.

4.1.9 Haul Route Plan

A Haul Route Plan (HRP) is provided in **Appendix A** and will be implemented throughout all phases of this construction project. This HRP includes the proposed route which construction and delivery trucks will use throughout construction and adheres to the HRM Traffic Control Manual Supplement. As shown in the HRP, haul routes will extend to their origins and destinations by streets approved in the HRM Truck Route Bylaw (T-400). The haul route consists of Princess Margaret Blvd.

4.1.10 Parking

There will be no net parking loss as a result of the proposed project. Please refer to the Encroachment Plans (see **Appendices A**) for additional information.

Parking Stall Removal

During the Excavation, Substructure and Superstructure Phases, no on-street parking stalls will be removed as a result of the proposed project.

Contractor Parking

To minimize parking requirements in adjacent neighborhoods, on-site workers will be required to carpool to the project site.

Out-of-Service Parking Meter Fees

During the Excavation, Substructure and Superstructure Phases, no metered parking stalls will be removed as part of the proposed development.

Temporary Parking

Dartmouth Cove Construction Ltd. is not requesting additional temporary on-street parking currently.

Net Parking Loss

During the Excavation, Substructure and Superstructure Phases, there will be no net parking loss.

Parking Signage

No temporary parking has been provided at this point, but in the future if there is there will be signage posted.

Parking Within Encroachment Areas

Encroachment areas are intended for use as loading areas and temporary pedestrian routes. On-site workers will not be permitted to park within the encroachment areas.

4.2 PEDESTRIAN MANAGEMENT

Pedestrian management will be of foremost consideration throughout the construction of this project. **Dartmouth Cove Construction Ltd.** has prepared Pedestrian Management Plans (PMPs) to assist pedestrians in navigating their way around this project site. These plans are provided in **Appendices A**.

Construction fencing will be secured around the complete perimeter of site. **Appendices A** for further details.

Although most signs will be mounted on existing permanent poles, some signs may require to be mounted using temporary concrete sign bases complete with embedded steel poles. These sign bases will weight approximately 90 kg (200 lb.) to prevent them from being stolen and will be square to prevent them from rolling if toppled. They will be positioned away from, or along the edges, of pedestrian routes to prevent impedance of pedestrians. Some Pedestrian Management Plan Rendering signs will be mounted to existing fences on private property. Additional information related to these items is provided in **Section 5.3**.

4.2.1 Bus Stop Relocation

There will be no bus stop relocations as a result of the proposed development.

4.2.2 Payment of Applicable Fees

Payment of all applicable fees will be made in accordance with HRM Administrative Order 15 (AO15).

4.2.3 Pedestrian Hazard Assessment

See **Appendix H** for Pedestrian Hazard Assessment information which validates **Dartmouth Cove Construction Ltd.**'s rationale for requiring street encroachments and temporary sidewalks.

4.2.4 Pedestrian Management Plan Preparation & Monitoring

Separate Pedestrian Management Plan (PMPs) have been prepared as required for each project phase. PMPs have been prepared **Dartmouth Cove Construction Ltd.** The PMPs illustrate the proposed signage which will be installed to warn pedestrian traffic ahead of and throughout the construction zone. Pedestrian management features and methods as well as information related to the PMPs are provided in Section 5.3 and in Appendices A.

4.2.5 Notifications of Pedestrian Closures

The contractor shall notify HRM and the public to proposed pedestrian closures as outline in **Section 8.3**.

4.2.6 Pedestrian Management Plan Compliance

The PMP will be implemented and monitored by the Site Contractor. Construction warning signage will be displayed throughout the approaches to, and adjacent to, the project site. **The Site Contractor** will inspect pedestrian management elements at the start and end of the workday, or more frequently as required, and will maintain pedestrian management elements as required to ensure the PMPs are effectively and correctly implemented. See **Appendix G** for a sample construction management plan element inspection sheet to be completed by both the Site Contractor and the Certified Traffic Control Company.

4.2.7 Changes to Pedestrian Management Plans

Requests for modifications to PMPs will be sent to HRM for approval a minimum of 10 days prior to their proposed implementation.

Notification of pedestrian disruptions will be distributed to affected residents and businesses a minimum of 5 days in advance of disruptions. Modifications to PMPs for unforeseen events will be sent to the Municipality for approval.

4.2.8 Pedestrian Management Plans

Pedestrian Management Plans (PMPs) have been prepared by **Dartmouth Cove Construction Ltd.** Separate PMPs have been prepared as required for each project phase (see **Appendices A**). The Pedestrian Management Plans illustrate the pedestrian routes throughout construction and signs which will be erected to warn and direct pedestrians in a safe and convenient manner.

Excavation Phase Pedestrian Management

During the Excavation Phase, the perimeter of the site will be secured with construction fencing. They will be placed at the back of sidewalk and along property lines as such that it will not affect the flow of pedestrian or vehicular traffic see **Appendix A** for further details.

As all parking will be at grade and the building is set back a minimum of 2.4m from all adjacent property lines, the use of shoring for the construction of the foundation walls and footings is not anticipated.

Construction fencing will remain in place for the entire duration of the project, therefore, fencing installation and removal plans have not been included in this phase.

Substructure Phase Pedestrian Management

See above Excavation Phase.

Superstructure Phase Pedestrian Management

See above Excavation Phase.

4.2.9 Pre-Project Hazard Assessment

See **Appendix H** for vehicular and pedestrian hazard assessment information which validates **Dartmouth Cove Construction Ltd.**'s rationale for requiring street encroachments and temporary sidewalks.

4.2.10 Visually Impaired Persons

Construction areas can be particularly difficult to navigate for visually impaired persons. **Dartmouth Cove Construction Ltd.** has reviewed elements identified by the Canadian National Institute for the Blind (CNIB) to assist the visually impaired and has incorporated these elements into the design of the CMP.

Ends of F-Type concrete barriers at starts of temporary sidewalks will have reflective tape complete with contrasting colors to assist the visually impaired in navigating their way around this project site. Similar reflective tape with contrasting colors will be provided along the sides of F-Type concrete barriers, near their tops, both on the vehicular traffic side and the pedestrian traffic side.

Sawhorse barricades painted "safety orange" will be located at all termination points along pedestrian routes to assist all pedestrians, especially visually impaired persons, in identifying the transition between pedestrian routes and traffic travel ways. These sawhorse barricades will be constructed complete with an orange-painted wooden 2" x 4" board complete with visual and braille text indicating "No Crossing" which will be fixed along the bottom of the sawhorse barricade for cane detection. Sawhorse barricades will be set up at existing street crossings to clearly identify that these crossings are out-of-service.

4.2.11 Accessibility

All pedestrian routes shall be barrier-free, utilizing existing curb cuts and sidewalk ramps. It will always be the contractor's responsibility to keep all pedestrian routes free and clear of obstructions, including snow, construction debris, and public debris to ensure their continued functionality.

5.0 CONSTRUCTION SITE PROTECTION AND HOARDING

5.1 SITE PROTECTION AND HOARDING MATERIALS

5.1.1 Fencing

In an effort to minimize debris from leaving the site, and to keep unauthorized personnel from entering the site, the entire perimeter of the work area will be secured with construction fence along the property line, total height shall be 1.8m (6ft) as per the HRM by-laws. The fencing may be covered with a combination of project advertising banner or mesh along the fencing facing Princess Margaret Blvd only.

5.1.2 Covered Ways

There are no covered ways anticipated as a result of the project.

5.1.3 Snow Removal

It will be the contractor's responsibility throughout all construction phases to keep all temporary sidewalks clean and free of snow and ice. The contractor will not dump snow or ice onto adjacent public property and will truck snow off site as required to prevent the unsafe build-up of snow piles.

The contractor will be responsible to remove snow and ice as required to ensure that emergency access is maintained to the project site.

5.1.4 Site Lines

Construction fences and signage will be installed as per the CMP drawings such that vehicular site lines are maintained around the corners of street intersections.

5.1.5 Emergency Access & Egress

Along Princess Margaret Blvd, the site will be accessible through one gate. This gate is the only location that will receive equipment/materials during construction and will always be locked after work hours. In cases of emergencies, on-site workers will exit the project site through this gate. The gate will always remain unlocked when workers are on site so as not to restrict emergency response units from accessing the site. In addition, the entrance gates will be designated “Gate” as shown in the CMP drawings.

5.1.6 Reinstatement of Public Property

The contractor will be responsible to repair and pay for any and all damages incurred due to temporary encroachments including, but not limited to:

1. Rigid fence and scaffolding holes reinstated with concrete to existing conditions or better;
2. Street lines repainted to existing conditions;
3. Damaged sidewalks, curbs, sodding, and other public elements reinstated to existing conditions or better;
4. Tactile pedestrian launch bars removed, and asphalt underneath treated with asphalt sealant;
5. Cracked asphalt within the encroachment areas repaired using hot rubber (or approved equivalent); and
6. Parking meters to be reinstated to existing conditions and any damaged parking meters replaced to existing conditions or better.

5.2 SITE PROTECTION AESTHETICS

Pedestrian Management Plan Renderings (see **Section 5.3**) will improve project site aesthetics and provide the public with information related to the project and nearby amenities. In addition, throughout all phases of the project, the contractor shall regularly inspect the project site and adjacent areas and keep these areas clean and free of debris, snow, and ice.

5.3 SIGNAGE

5.3.1 Project Management Plan Renderings

Pedestrian Management Plan Renderings (PMPRs) will not be used during Construction.

5.3.2 Pedestrian Detour Wayfinding

We believe that in this current development stage that wayfinding signage is not required as this is strictly a residential area and there are no local businesses in the immediate vicinity that will be negatively affected.

6.0 LIFTING, HOISTING AND CRANE OPERATIONS

6.1 NAVIGATION CANADA & TRANSPORT CANADA REGULATORY APPROVALS

This project will require a tower crane. The top of the crane is expected to be at an elevation of approximately 65m above the sidewalk. Approximately 82.5m above geodetic sea level.

Trans Canada and Nav Canada application will be submitted, and the owner will wait for approval letters from both agencies confirming acceptance.

During crane assembly and disassembly, crane components will be unloaded from a transport truck onto the vacant property owned by the developer adjacent to the site. These components will be assembled within the project site by site equipment.

6.2 OPERATIONS ABOVE THE PUBLIC REALM

During lifting operations, no loads will be suspended over the public realm. All lifting activities will be carried out within the property limits. If necessary, Lot 1—which is owned by Basin Heights and currently fenced—will be used.

A separate crane permit is required prior to crane installation, as stated in item 6.1.

Additional encroachments for crane operation will not be required.

7.0 ON-SITE CONDITIONS

7.1 SITE SAFETY AND SECURITY

All contractors on site will be required to be registered members in good standing with the Nova Scotia Construction Safety Association. Contractors will be required to comply with all applicable safety codes and regulations. The contractor will be required to provide a mandatory site safety orientation for all trades and site visitors.

The contractor will be required to have certified first aid responders on site during all construction activities. First aid kits will be made available at the project site and site office and locations of first aid kits will be prominently posted and communicated to all on-site workers and visitors. In addition, fire extinguishers will always remain available on site. The contractor will be responsible to carry out regular inspection of first aid kits, and fire extinguishers, and to note any deficiencies and replenish kits as required for any missing or used items.

7.1.1 Access & Egress Gates

Signs identifying the “Gate” will be prominently posted as per the TCPs (see **Appendices A**). These signs will be mounted directly onto the gates using steel cables.

7.1.2 Hazard Warning Signage

Hazard warning signs will be fastened to the “Gate” warning personnel of potential hazards and personal protective equipment (PPE) required.

7.1.3 Gate Locking & Monitoring

Gates will be locked during non-work hours and will always be closed not in use. During holidays and weekends, the contractor will be responsible for checking the project site gates daily to ensure they are secure.

7.1.4 Hoarding Signage

Hoarding will be marked with “No Trespassing – Construction Personnel Only” signs. All personnel on the construction site will always be required to use all proper personal protective equipment (PPE). PPE requirements will be prominently posted, and visitors will be required to sign in at the project site office before entering the site. A warning of potential fines will be included for those who violate PPE requirements.

7.1.5 Inspection Reports

The contractor will regularly inspect hoarding and address all safety-related and other deficiencies in a prompt and timely manner. Inspection reports on maintenance activities carried out will always be kept on site.

7.1.6 Dangerous Activities

Public safety and the safety of on-site workers will be of critical importance throughout all construction phases and all works will be carried out in accordance with Nova Scotia Occupational Health and

Safety Act. For all dangerous activities, first aid kits will be readily available as outlined in **Section 7.1**. See **Appendix H** for vehicular and pedestrian hazard assessment information.

Hot Works

Hot works will be undertaken a minimum of 3 m inside the project site property boundary. During hot works, the contractor will ensure that a first aid kit and fire extinguisher are readily available (in addition to the first aid kits and fire extinguishers identified in **Section 7.1**) in the immediate vicinity of the work such. In addition, hot works will be undertaken away from heavy equipment and heavy equipment routes.

On Site Smoking

Smoking will be permitted only in designated areas (signage posted) on the project site. In addition, under no circumstances will smoking or open flames be permitted within the vicinity of combustible or explosive materials, to a minimum standard as identified in the material's product specifications. See **Section 7.1.9** for information related to the designated smoking area.

Ignition Source Controls

It will be the contractor's responsibility to review potential ignition sources regularly and to proactively mitigate the potential for them to ignite. Potential ignition sources include faulty wiring, hot surfaces and motors, welding, grinding, and other sparks, convex lenses (magnifying glasses), and reactive chemicals. Material and equipment specifications and best practices will be followed during all construction activities to reduce the risk of ignition. In addition, potential ignition sources and work which may result in potential ignition will be kept away from heavy equipment and heavy equipment routes.

Storage of Combustible Materials

On-site materials will be protected as required from environmental conditions such as snow, rain, and wind to prevent materials from causing harm to on-site workers or the general public. Combustible materials, as well as explosive, reactive, and corrosive materials, will be stored in accordance with their product specifications using storage sheds and containers within the loading area and on-site as required and will be kept away from heavy equipment and heavy equipment routes.

Waste Management Practices

Throughout construction the contractor will be required to maintain a clean and tidy work environment and work to proactively eliminate risks. The contractor will monitor the project site at the start and end of the work day, or more frequently as required, to ensure that waste is removed in a prompt and timely manner such that it does not pose a risk to on-site construction activities, on-site workers, or the general public.

7.1.7 Emergency Contact Information

As outlined in **Section 5.3**, throughout all project phases, **Dartmouth Cove Construction Ltd.** and **Contractors** emergency contact information will be prominently posted on Project Information Boards.

7.1.8 After-hours Lighting

No additional after hours lighting is expected at this time.

7.1.9 Smoking Area

Smoking will not be permitted on the project site. A designated smoking area within the project boundary, away from the HRM Right of Way, will be designated prior to the start of construction.

7.2 MATERIAL HANDLING, LOADING/UNLOADING, DELIVERY, AND VEHICLE STAGING

Loading zone will be within the project boundary to allow for safe material handling, loading and unloading, deliveries, and vehicle staging. Barriers and fencing in this area will separate construction activities from public traffic. This loading area is identified in the Encroachment Plans. The Haul Route Plan shows the route for trucks travelling to and from the project site, as outlined in **Section 4.1.9** of this report.

On-site materials will be protected as required from environmental conditions such as snow, rain, and wind to prevent materials from causing harm to on-site workers or the public. Efforts will be made to prevent dust and other materials from becoming airborne during high wind events.

See **Appendix H** for vehicular and pedestrian hazard assessment information.

7.3 ENVIRONMENTAL CONTROLS

7.3.1 Street & Right-of-Way Cleaning

The contractor owns a street cleaner which will be used regularly to sweep streets and travel ways in and around the project site. Pedestrian travel ways will be hand swept when necessary, or more frequently as required. It will be the responsibility of the contractor to keep the 1.5m temporary sidewalks free and clear of snow, ice, and debris. The contractor will also be responsible to remove snow on the street side of F-Type jersey barriers and fences within the ROW that cannot be removed by typical Municipality ploughing operations.

7.3.2 Stormwater Management and Runoff Pollution

The contractor will be required to prevent sediment from entering all adjacent catch basins and leads using erosion and sediment controls (see NSE Erosion & Sedimentation Control Handbook for Construction Sites). All water on site will be treated and pumped to an adjacent catch basin in accordance with HRM Bylaw W-101. The proposed construction will not cause negative impacts to the storm systems or affect drainage paths.

To achieve this, the contractor will install and maintain sediment traps in the catch basin directly adjacent to the project site. The sediment trap in this catch basin will provide further protection against storm system sedimentation.

7.3.3 Noise Pollution

The contractor will always adhere to the HRM Noise Bylaw (N-200). No work will take place on the project site outside those hours identified in **Section 2** of this report.

7.3.4 Dust Pollution

As outlined in **Section 5.1** of this report, fencing and opaque mesh will assist in preventing the spread of dust throughout the project site.

In addition to the fencing and opaque mesh, the contractor will be responsible to carry out the following dust/debris controls;

1. Adjacent streets and properties will be regularly swept clean;
2. The excavation access will regularly be topped with clean gravel to prevent tire tracing from trucks;
3. Catch basins within and adjacent to hoarding will have sediment traps installed;
4. On dry days the site will be watered to prevent dust from becoming airborne; and
5. The upper levels of the new building will be regularly swept clean and materials secured to prevent construction debris from exiting the building site.

7.3.5 Emissions Control

All construction vehicles will be required to use the loading area for parking and idling to keep exhaust emissions within the construction zone as much as possible. Vehicles will be staged so that idling will not occur for more than 3 minutes at a time. Note that, unless a vehicle motor is required to run to complete work functions, it must be turned off after no more than 3 minutes. Signs identifying these idling requirements will be posted on the front of the project site office trailer and within the loading area.

7.3.6 Rodent Control

Rodent movement increases during construction activities; the Site Contractor will engage a certified pest control company to help mitigate this, if needed. The certified pest control company will review the rodent control plan with the goal of preventing movement of rodents off-site to find safe refuge in adjacent areas.

Rodent Control Credentials

The company will be required to be certified by the Canadian Pest Management Association (CPMA), is a member in good standing with the National Pest Management Association (NPMA) and is certified to be in conformance with ISO 9001:2008. All rodent control technicians on site will hold Nova Scotia Environment (NSE) pest control licenses. Proof of these documents will always be kept on site at the project site office trailer and remain available.

Rodent Control Management

The RCP will consist of a baiting and monitoring program. Auxiliary buildings will remain locked and secure during all non-work hours and sewer laterals to be removed will be removed in a prompt and timely manner such that they do not provide safe refuge for rodents. In addition, standing water will be promptly pumped off-site to abate attractive conditions for rodent habitation.

Bait stations will be secured in their locations using wooden stakes (for open sodded and dirt locations), weighted patio stones (behind walls and on paved areas), and zip-ties (fixed to fences). Bait stations within the project site will be fixed to rigid fences using zip-ties and will be placed on the private side of property line.

Bait stations will be baited using “Contrac Blox” in accordance with the Environment Canada Pest Control Products Act. Information and specifications for bait stations and bait are provided in **Appendix E**.

The Certified Rodent Control Professional will provide monthly monitoring of every bait station. During each visit to an individual bait station, the technician will open the bait station, record the amount of bait consumed, the amount of bait replenished, the site conditions (weather), and the condition of the bait and bait station. Visible rodent carcasses will be collected and removed from the project site and neighboring areas on a monthly basis.

A rodent control package will always be kept on site and be housed in the project site office trailer. It will include copies of certifications, letters of good standing, letters of conformance, technician names and licenses, rodent control plans, and rodent control records. Certified Rodent Control technicians will be required to sign in and out upon arrival to, and departure from, the project site.

Rodent Control Safety Considerations

Public safety will be of critical importance for rodent control activities. Physical (snap) traps will be prohibited unless approved by HRM (the contractor must request proposed CMP changes to HRM a minimum of 10 days prior to planned implementation for review). Trap size will be sufficiently small to prevent children, dogs, or cats from entering and becoming poisoned and the bait/poison will be sufficiently weak so as not to kill children, dogs, or cats. In addition, bait stations will be tampering proof and bait will be securely fixed inside so that it cannot be shaken out. Bait stations will be opaque to protect the public from unsightly images.

Project Closure

Following completion of this project, the certified pest control company will promptly collect and appropriately dispose of all unused bait, bait stations, and remaining carcasses and will provide a close out letter to HRM outlining the work that was completed throughout construction and confirming that all necessary clean-up has been completed.

7.3.7 Light Pollution

Lighting of the project site (private property) will be 3 m (maximum) above the highest elevation of the building or excavation and will be directed inwards towards the property.

8.0 COMMUNITY ENGAGEMENT & NOTIFICATION

8.1 PRE-CMP COMMUNITY ENGAGEMENT

The owner and contractor have been in contact with neighbors over the past month to discuss the proposed work. They further intend to distribute community consultation letters to neighboring property owners in the immediate vicinity of the project.

A sample of the letter that was distributed is provided in **Appendix C- Draft Notification Letter**.

During construction, project contact information will be easily identifiable on Project Information Boards which will be posted around the project site as identified in the Pedestrian Management Plans (PMPs) and **Appendices A**.

8.2 SCHEDULED COMMUNITY NOTIFICATIONS

As mentioned in Section 8.1, major project updates will be sent to the community periodically throughout construction.

8.3 CLOSURE NOTIFICATION REQUIREMENTS

Notification of street closures and public service interruptions will adhere to the requirements of the HRM Traffic Control Manual Supplement. Street closure requests require 10 days (minimum) notice to HRM prior to their planned implementation and must be approved by HRM prior to implementation. Notification to the affected public will be made a minimum of 5 days prior to the disruption. These notifications will be hand delivered and the contractor will keep and maintain a list of all effectively notified property owners such that they ensure all affected parties are notified. The contractor will notify HRM immediately upon confirmation of affected parties that have been notified and their respective civic addresses. A Draft Notification Letter is provided in **Appendix C**.

9.0 PERMIT & NOTIFICATION REQUIREMENTS

The contractor will be responsible for coordinating a pre-construction meeting 10 days prior to construction commencement to review the CMP on site. Attendees will include the contractor, the owner, HRM, Halifax Water (HW), utility companies, and representatives from neighboring properties.

10.0 REGULATION & ENFORCEMENT

10.1 INSPECTION & MONITORING

The contractor will be responsible to monitor the implementation of the CMP daily, or more frequently as necessary, to ensure its continued effectiveness. The contractor will complete a daily inspection/maintenance log of all CMP elements.

As outlined in **Section 1**, any changes required to this CMP must be sent to HRM for review 10 days (minimum) prior to their proposed implementation. Changes may only be implemented following HRM approval.

11.0 SUMMARY

This CMP has been prepared with the goal to minimize negative impacts to the community, pedestrians, and traffic throughout construction of this project. This CMP will be used as a minimum standard and any further safety protection required, or methods to provide a more positive environment, will be used throughout construction as necessary as approved by HRM.

Should you have any questions or comments related to this document, please contact **Dartmouth Cove Construction Ltd.** For all construction-related inquiries, please contact the owner, contractor, or traffic control service provider (see contact information in **Section 1.2**).

Regards,



Gilbert S. Merheb P.Eng.

Project Engineer

APPENDICES

APPENDIX A – EXCAVATION, SUBSTRUCTURE, AND SUPERSTRUCTURE PLAN CMP DRAWINGS

Encroachment Plan

Pedestrian Management Plan – All Phases

Traffic Control Plan – All Phases

Haul Route Plan – All Phases

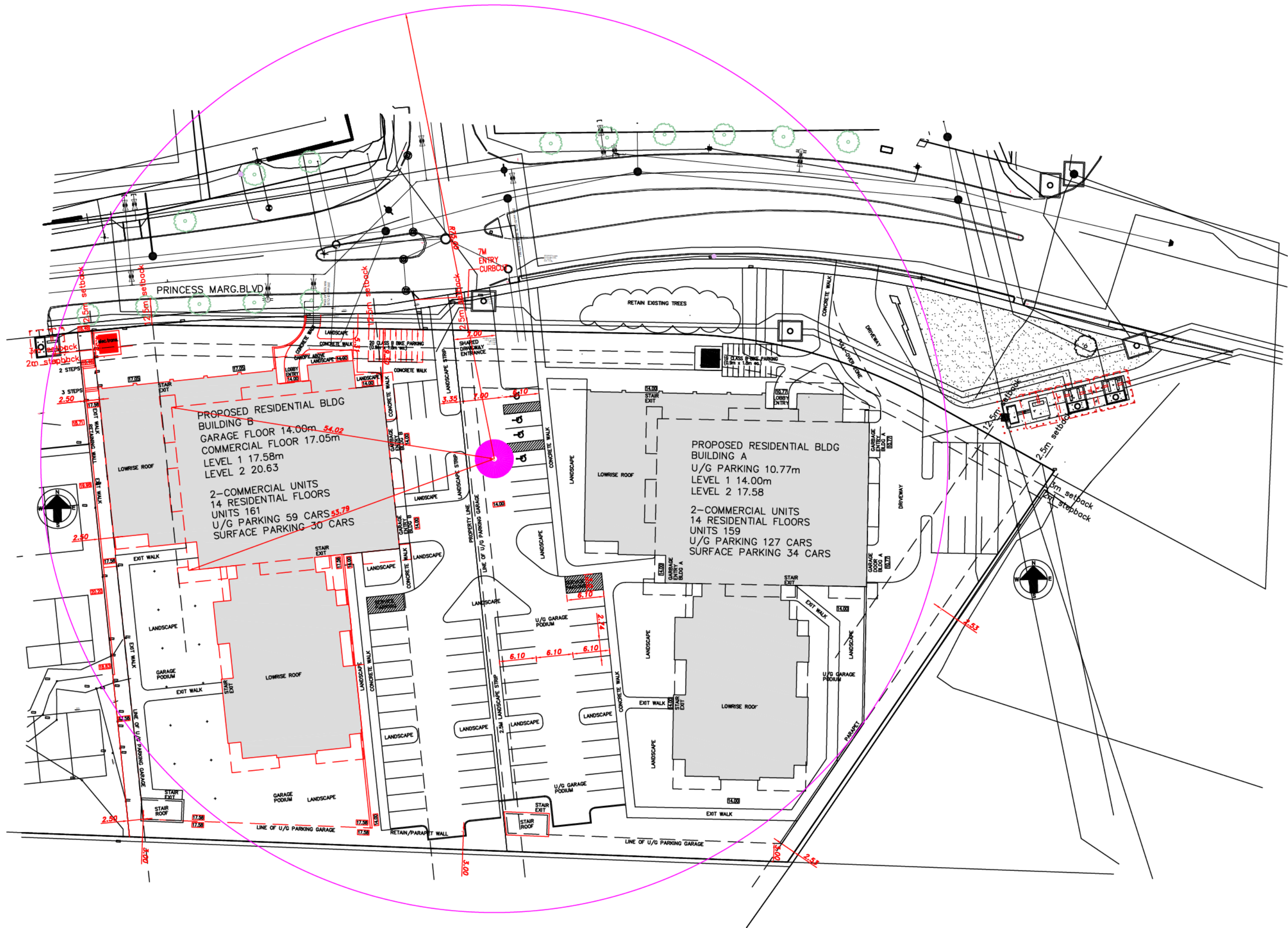



19 princess Margaret blvd

Playground

On Time Limousine

Princess Margaret Blvd

Ocean Breeze - Universal Properties

Playground

A. Murray MacKay

111

111

111

Hudson Way



19 princess
Margaret blvd

Playground

On Time Limousine

Princess Margaret Blvd

Ocean Breeze -
Universal Properties

Playground

400

A. Murray MacKay

111

111

111

Hudson Way



P

P

Waterside

19 princess
Margaret blvd

P

P

P

400

111

111

111

111

2E

MACPASS
Customer Service

U-Haul Moving &
Storage of Dartmouth

Yorkshire Avenue Extension

Hebden Ct

Sports Field

Comfort Inn

Fan's Chinese Restaurant

O'Regan's Kia Dartmouth

Premiere Suites

Ship Victory
Restaurant & Lounge

Fernhill Dr

Canadian Food
Inspection Agency

Hudson Way

Hudson Way

Irroquois Dr

Small Playground
in the Shannon Park...

Shannon Park
Canada 150 Trail

Big Playground
in the Shannon Park...

Irroquois Dr

Windmill Rd

Neck Ave

Nadia Dr

APPENDIX B – DEVELOPMENT INFORMATION SIGN

**DEVELOPMENT INFORMATION
BOARD**

**PROPOSED DEVELOPMENT
400 Princess Margaret
Blvd.**

| | |
|---|---|
| Developer Dartmouth Cove Construction Ltd. 50 Kings Wharf Pl. Dartmouth, NS B2Y 0B4 | Contractor/General Dartmouth Cove Construction Ltd. |
| 24 Hour Emergency Contact: Travis England 400 Princess Margaret Blvd. 902-210-6672 | |

APPENDIX C – DRAFT NOTIFICATION LETTER

Community Information Letter | 400 Princess Margaret Blvd.

Dartmouth Cove Construction Ltd.
50 Kings Wharf Place
Dartmouth, NS, B2Y 0B4

Telephone: 902-455-5555
Email: info@faresin c. com

XXXX, 2025

Dear Neighbor,

This letter is to notify you that the western sidewalk adjacent to 400 Princess Margaret Blvd development will be closed to pedestrians between April XX and April XX. During this time pedestrians will be directed to use the western sidewalk parallel to the development, using the marked crosswalks on Princess Margaret Blvd.

If you have any questions or concerns, feel free to contact us using the information below.

General Contractor: Dartmouth Cove Construction Ltd.

General Contractor: 400 Princess Margaret Blvd. development.
902-455-4555
info@faresin c. com

APPENDIX D – MONTHLY PROJECT UPDATE LETTER

Monthly Project Update | 400 Princess Margaret Blvd.

Dartmouth Cove Construction Ltd.
50 Kings Wharf Place
Dartmouth, NS, B2Y 0B4

Telephone: 902-455-5555
Email: info@faresinc.com

XXXX, 2025

This is to notify you that construction is ongoing at 400 Princess Margaret Blvd development.

In the past month.....
This month.....

If you have any questions or concerns, feel free to contact us using the information below.

General Contractor: Dartmouth Cove Construction Ltd.

General Contractor: 400 Princess Margaret Blvd. development.
902-455-4555
info@faresinc.com

APPENDIX E – RODENT CONTROL SPECIFICATIONS & TEMPLATES

Contract Box Specifications

Bait Trap Specifications



HONTRAC'* BLOX KILLS RATS & MICE

SAFETY DATA SHEET

ACCORDING TO REGULATION:
GHS/WHMIS 2015

DATE OF ISSUE:
January 2020

PREPARED BY:
CAR

Product Identifier: CONTRAC BLOX KILLS RATS & MICE

PMRA Registration Number: tt239

Relevant Identified uses: Anticoagulant Rodenticide

Uses advised against: Use only for the purpose described above

MANUFACTURER/SUPPLIER:

Bell Laboratories, Inc.

3699 Kinsman Blvd.

Madison, WI 53704, USA

Email: sds@bell1labs.com

Phone: 608-241-0202

Medical or Vet Emergency: 877-854-2494 or 952-852-4636

Spill or Transportation Emergency: 800-424-9300 (CHEMTREC)

WBMS Classification: Not classified

Signal Word PMRA: Warning/Poison

Precautionary Statements: KEEP OUT OF REACH OF CHILDREN, PETS AND LIVESTOCK. May be harmful or fatal if swallowed or absorbed through the skin. Chemical-resistant gloves must be worn when handling product and when disposing of dead rodents, unconsumed bait and empty containers. Avoid contact with eyes, skin or clothing. Wash hands before eating, drinking, chewing gum, using tobacco or using the toilet. Wash skin thoroughly with soap and water after handling. Wash contaminated clothing, separately from other laundry, with soap and water before reuse. KEEP AWAY FROM FEED AND FOODS FS.



See Section 15 for information on PMRA applicable safety, health, and environmental classifications.

Component

CAS No.

% By weight

Bromadiolone [3-[3-(4'-Bromo-[1,1'-biphenyl]-4-yl)-3-hydroxy-1-phenylpropyl]-4-hydroxy-2H-1-benzopyran-2-one]

28772-56-7

0.005%

Inert and Non-Hazardous Ingredients

(Unlisted components are non-hazardous)

Proprietary

99.995%

ft.

Description of first aid measures

Ingestion: Call physician or emergency number immediately. Have person sip a glass of water if able to swallow. Do not induce vomiting unless instructed by physician.

Inhalation: Not applicable.

Eye contact: Hold eye open and rinse slowly with water for 15 — 20 minutes. Remove contact lenses, if present, after the first 5 minutes, then continue rinsing eye. If irritation develops, obtain medical assistance.

Skin contact: Take off contaminated clothing. Rinse skin immediately with plenty of water for 15 - 20 minutes. If irritation develops, obtain medical assistance.

Most important symptoms and effects, both acute and delayed

Ingestion of excessive quantities may cause nausea, vomiting, loss of appetite, extreme thirst, lethargy, diarrhea, bleeding.

Advice to physician: If ingested, administer Vitamin K1 intramuscularly or orally as indicated for bishydroxycoumarin overdoses. Repeat as necessary as based upon monitoring of prothrombin times.

Advice to Veterinarian: For animals ingesting bait and/or showing poisoning signs (bleeding or elevated prothrombin times), give Vitamin K1. If needed, check prothrombin times every 3 days until values return to normal (up to 30 days). In severe cases, blood transfusions may be needed.

Extinguishing media

Suitable Extinguishing Media: water, foam or inert gas.

Unsuitable Extinguishing Media: None known.

Special hazards arising from the mixture: High temperature decomposition or burning in air can result in the formation of toxic gases, which may include carbon monoxide and traces of bromine and hydrogen bromide.

Advice for firefighters: Wear protective clothing and self-contained breathing apparatus.

Personal precautions, protective equipment and emergency procedures: Collect spillage without creating dust.

Environmental precautions: Do not allow bait to enter drains or water courses. Where there is contamination of streams, rivers or lakes contact the appropriate environment agency.

Methods and materials for containment and cleaning up

For Containment: Sweep up spilled material immediately. Place in properly labeled container for disposal or re-use.

For Cleaning Up: Wash contaminated surfaces with detergent. Dispose of all wastes in accordance with all local, regional and national regulations.

Refer to other sections: Refer to Sections 7, 8 & 13 for further details of personal precautions, personal protective equipment and disposal considerations.

Precautions for safe handling: All handlers must wear long-sleeved shirt and long pants, shoes plus socks, and chemical resistant gloves when handling this product. Do not handle the product near food, animal foodstuffs or drinking water. Keep out of reach of children. Do not use near heat sources, open flame, or hot surfaces. As soon as possible, wash hands thoroughly after applying bait and before eating, drinking, chewing gum, using tobacco, or using the toilet.

Conditions for safe storage, including any incompatibilities: Store in cool, dry place away from other chemicals and food or feed. Store product not in use in original container in a secure location inaccessible to children and non-target animals.

Established Limits

| Contaminant | OSHA | ACGIH | Other Limits |
|--------------|-----------------|-----------------|-----------------|
| Bromadiolone | Not Established | Not Established | Not Established |

Appropriate Engineering Controls: Not required

Occupational exposure limits: Not established

Personal Protective Equipment:

Respiratory protection: Not required

Eye protection: Not required

Skin protection: Not required

Hygiene recommendations: Wash thoroughly with soap and water after handling.

Information on basic physical and chemical properties

| | |
|---|------------------|
| Appearance/Color: | Blue wax block |
| Odor: | Sweet grain-like |
| Odor Threshold: | No Data |
| pH: | No Data |
| Melting point: | No Data |
| Boiling point: | No Data |
| Flash point: | No Data |
| Evaporation rate: | No Data |
| Flammability: | No Data |
| Upper/lower flammability or explosive limits: | No Data |
| Vapor Pressure: | No Data |
| Vapor Density: | No Data |
| Relative Density: | 1.13 g/mL @ 20°C |
| Solubility(water): | Negligible |
| Solubility(solvents): | No Data |
| Partition coefficient: n-octanol/water: | No Data |
| Auto-Ignition temperature: | No Data |
| Decomposition temperature: | No Data |
| Viscosity: | No Data |

Reactivity: Stable when stored in original container in a cool, dry location.
Chemical stability: Stable when stored in original container in a cool, dry location.
Possibility of hazardous reactions: Refer to Hazardous decomposition products
Conditions to avoid: Avoid extreme temperatures (below 0°C or above 40°C).
Incompatible materials: Avoid strongly alkaline materials.
Hazardous decomposition products: High temperature decomposition or burning in air can result in the formation of toxic gases, which may include carbon monoxide and traces of bromine and hydrogen bromide.

Information on toxicological effects

Acute Toxicity

LD50, oral (ingestion): >5000 mg/kg (rats) (Bromadiolone Rat LD50 oral: 0.70 mg/kg bw).

LD50, dermal (skin contact): > 5001 mg/kg (rats) (Bromadiolone rabbit LD50 dermal: 1.71 mg/kg bw).

LC50, inhalation: Product is a wax block and therefore exposure by inhalation is not relevant.

Skin corrosion/irritation: Not irritating to skin.

Serious eye damage/irritation: Not irritating to eyes.

Respiratory or skin sensitization: Dermal sensitization: Not a Sensitizer (Guinea pig maximization test).

Germ cell mutagenicity: Contains no components known to have a mutagenetic effect.

Carcinogenicity: Contains no components known to have a carcinogenic effect.

| Components | NTP | IARC | OSHA |
|--------------|------------|------------|------------|
| Bromadiolone | Not listed | Not listed | Not listed |

Reproductive Toxicity: No data

Aspiration Hazard: Not applicable. Product is a wax block.

Target Organ Effects: Reduced blood clotting ability.

Ecotoxicity Effects: This product is toxic to fish and wildlife. Keep out of lakes, streams or ponds.

Persistence and degradability: Product is inherently biodegradable.

Bioaccumulative potential: Not determined. Bromadiolone water solubility is extremely low (< 0.1 mg/l).

Mobility in Soil: Not determined. Mobility of bromadiolone in soil is considered to be limited.

Other adverse effects: None.

Do not reuse empty container. Dispose of unused or spoiled bait in accordance with local requirements. Follow provincial instructions for any required cleaning of container prior to its disposal. Make the empty container unsuitable for further use. Dispose of the container in accordance with provincial requirements. For more information on the disposal of unused, unwanted product and cleanup of spills, contact the provincial regulatory agency or the Manufacturer. Dispose of dead rodents in garbage or by burying.

UN number: Not regulated

UN proper shipping name: Not regulated

Transport hazard class(es): Not regulated

Packing group: Not regulated

Environmental Hazard

DOT Road/Rail: Not considered hazardous for transportation via road/rail.

DOT Maritime: Not considered hazardous for transportation by vessel.

DOT Air: Not considered hazardous for transportation by air.

Canadian Classification: Not considered hazardous

Freight Classification: LTL Class 60

Transport in bulk according to Annex H of MARPOL 73/78 and the IBC code: Not applicable

Special precautions for user: None

Safety, health and environmental regulations/legislation specific for the substance or mixture:

Health Canada PMRA: This pesticide product is regulated by the Pesticide Management Regulatory Agency of Health Canada and is subject to certain labeling requirements under federal pesticide law. These requirements differ from the classification criteria and hazard information required for safety data sheets (SDS), and for workplace labels of non-pesticide chemicals. The safety, health, environmental, and hazard information required on the pesticide label is listed below and reflected throughout this SDS. The pesticide label also includes other important information, including directions for use.

TSCA: All components are listed on the TSCA Inventory or are not subject to TSCA requirements

CERCLA/SARA 313: Not listed

CERCLA/SARA 311/2: Not listed

For additional information, please contact the manufacturer noted in Section 1.

| | | | | |
|------|----------------------|--------------------------|-------------------------|--------------------------|
| NFPA | Health: 1 (caution) | Flammability: 1 (slight) | Reactivity: 0 (stable) | Specific Hazard: None |
| HMIS | Health: 2 (moderate) | Flammability: 1 (slight) | Reactivity: 0 (minimal) | Protective Equipment: BB |

Disclaimer: The information provided in this Safety Data Sheet has been obtained from sources believed to be reliable. Bell Laboratories, Inc. provides no warranties; either expressed or implied, and assumes no responsibility for the accuracy or completeness of the data contained herein. This information is offered for your consideration and investigation. The user is responsible to ensure that they have all current data, including the approved product label, relevant to their particular use.



NEPTUNO BAITSTATION

4 "6 x" g'x"/ 7"r 0 - _____

APPENDIX F – CONSTRUCTION MANAGEMENT PLAN CHANGE REQUEST

400 Princess Margaret Blvd.

Construction Management Change Request

Dartmouth Cove Construction
Ltd.

50 Kings Wharf Pl.
Dartmouth, NS, B2Y 0B4

Ph: 902-410-4957

Date

This is to request a change to the Construction Management Plan for the 400 Princess Margaret Blvd Development. Dartmouth Cove Construction Ltd. requests a change to the Construction Management Plan (CMP) to be reviewed by the Halifax Regional Municipality (HRM). These changes are required due to [REDACTED]. The proposed date of implementation for these changes is [REDACTED], and are expected to be required until [REDACTED]. Please see the attached sketch which outlines the changes being requested.

Should you have any other questions or concerns, please feel free to contact the below.

Contact Information:

General Contractor: Dartmouth Cove Construction Ltd

Ph: 902-410-4957

Yours Truly,

Dartmouth Cove Construction Ltd.

Tony Daniel, Project Manager

APPENDIX G – CONSTRUCTION MANAGEMENT PLAN INSPECTION SHEET

Site Safety Inspection

Location:

Date (Y.M.D): _____

Inspector: _____

Inspection

| Description Include Positive Items Items/Communication | Hazard Rating H/M/L | Repeat Item Y/N | Corrective Action Required | Responsible Company/Person | Due Date | Completed Y/N |
|--|---------------------------|-----------------------|-------------------------------|-------------------------------|----------|------------------|
| | | | | | | |
| | | | | | | |
| | | | | | | |
| | | | | | | |
| | | | | | | |
| | | | | | | |
| | | | | | | |

General Comments

| |
|--|
| |
| |
| |
| |
| |
| |
| |
| |
| |

Inspector Signature

X _____

APPENDIX H – HAZARD ASSESSMENT

Job Hazard Assessment

Project Name: Dartmouth Cove Construction Ltd. (DDC)

Location: 400 Princess Margaret Blvd.

Date of Assessment: September 4, 2025.

Assessment Team Review

| Name | Company | Position | Signature |
|-----------------|--------------------------|------------------------|-----------|
| Tony Daniel | Fares & Co. Developments | Project Manager | |
| Suray Churamani | Fares & Co. Developments | General Superintendent | |
| Kim Johnson | Fares & Co. Developments | Site Superintendent | |
| Ernil Olivario | Fares & Co. Developments | CSO | |

Please check all items that apply. Items checked in table one need to be addressed in Table 2.

Table one

| Site Preparation | × | Site work/Building | × | Safety Program | × |
|------------------------------|---|------------------------|---|-------------------------------------|---|
| Soil Remediation | | Excavation | × | Safety Station Installed | × |
| Grading | × | Trenching | × | Emergency Procedure/ numbers posted | × |
| Drainage | × | Roofing | × | SDS Binder | × |
| Stacking of Materials | × | Steel erection | | OH&S Act and Regs | × |
| Traffic control measures | × | Demo/Blasting | | Safety Manual | × |
| Lighting | × | Confined Space | | Company rules posted | × |
| Visibility (Fog, mist, dust) | × | Crane work. Rigging | × | Other: | |
| Parking | × | Work at Heights | × | | |
| Fencing | × | Interior work | × | | |
| Accessibility | × | Other: | | | |
| Other: | | | | | |
| | | | | | |
| Occupational Health Hazards | × | Equipment | × | Fire Prevention | × |
| Physical Agents | × | Mobile Equipment | × | Smoking Rules | × |
| Biological Agents | × | Power Tools | × | Special Fire Prevention | × |
| Chemical Agents | × | Vehicles | × | Fire extinguishers | × |
| Lead | | Ladders | × | Signage Posted | × |
| Asbestos | | Scaffolds | × | Alarm System | × |
| Silica | × | Hand Tools | × | Fire Dept. Assistance | × |
| Spill Clean-up Procedure | × | Other: | | Hot work | × |
| Other: | | | | Other: | |
| | | | | | |
| | | | | | |

Table Two

| Activities | Hazards | Risk Ranking | Responsibility | Control Measures | Date of Review |
|--|--|--------------|---|---|----------------|
| Reviewing this hazard assessment | Not all hazards may be identified on this hazard assessment | 4D | DDC/ST | Not all hazards will be on this assessment. Each Subtrade is required to do their own JHA for their scope of work. This document will be updated throughout the project. | |
| General Public | Public accessing site and hurting themselves because they do not know the hazards associated with a construction site. | 2C | DDC/ST - report any unauthorized personnel. | Perimeter fencing installed and signs posted. Gates locked during non construction hours. Traffic control personnel if/ when required. Encourage sub trades to report any unauthorized personnel to site management. | |
| Site Mobilization -Setting up office and Safety board. Securing site | Lifting (back injury) Property damage Pinch points between material and walls Not all safety info and supplies on safety board and on site. Public accessing work area | 3C | DDC/ST | Use safe work procedures for lifting heavy materials, have enough help on site to complete task safely. After safety board is set up have supervision and safety review to ensure it is complete. Fencing around the whole work area with signage to keep public out. | |
| Site orientation Visitors | Working with no orientation or safety training. | 2C | DDC/ST | Every worker must go through Site safety orientation. WHMIS 2015 GHS is the minimum required training to access site. Task specific training will be required before starting these tasks (example Fall protection). All training must be submitted to site management. Any visitor to site must wear all required PPE, sign in and be escorted by someone that has the site orientation. | |
| Evacuation/ Rescue plan | Workers not knowing evacuation plan | 2C | DDC/ST | In the event an evacuation of the building and or injury occurs all workers need to be aware of the evacuation plan, location of the MUSTER station (sign posted). This will be discussed in the orientation. It will be posted on the Safety Board(s). | |
| Training | Not the proper training for the site or for task being done. | 2C | DDC/ST | Ensure all site and task training is done prior to coming to site. Training certs must be passed in prior to working. | |
| PPE | Not wearing Site required PPE | 1C | DDC/ST | Any personnel accessing the site must have the required CSA approved PPE on. Hard hat, Work boots, hi- visibility is recommended when working around moving equipment. | |

| | | | | | |
|--|--|-----|--------|--|--|
| | | | | Task specific gloves and safety glasses. Any worker using a grinder must have double eye protection (glasses and face shield). And any other task specific PPE. | |
| Parking | Blocking Access to site and impeding on public parking. | N/A | DDC/ST | Designated parking will be identified by signage, no street parking allowed. | |
| Using Hazardous Products | Using chemicals and material without reviewing SDS. Not wearing proper PPE or having proper controls in place. Not having proper training on use of product. | 1C | DDC/ST | All SDS are to be maintained in the SDS binder and kept in an easily accessible location on site. A request will be made to the subtrades for any hazardous material that may be present on the site. There will be a digital copy of the SDS on Procore under the safety section. Task Specific PPE required and training required, WHMIS 2015 and on the job training. | |
| Safe work Practices and Procedures | Your company might not have these in place. Not following Safe work Practices and procedures in place by King's Wharf. | 1C | DDC/ST | Reference Subtrade and 3321382 NS Ltd. Manual and Safe work Practices and Procedures for additional information on controlling risk associated with specific task. Always adhere to the higher standard. | |
| Deliveries | Site congestion. Pedestrian traffic at site entrance. Delivery personnel not having all PPE on. | 4C | DDC/ST | Ensure spotters are used as site may be congested. All subs are responsible for their deliveries and to ensure proper PPE is worn. Proper signage posted to notify public of active construction site. | |
| Access/Egress | Not have quick exit in the event of an emergency. | 3C | DDC/ST | A safe means of access and egress will be maintained for the life of the project. Always be aware of where your closest Exit is. Always maintain housekeeping and do block any access/egress right away. | |
| Welding | Arc flash, Fire, combustible material in the area, No fire protection (fire extinguisher) | 1B | DDC/ST | Site hot work permits must be filled out and approved prior to welding or hot work. All combustible material must be removed from the hot work area. A fire extinguisher must be in the area of all hot work and follow site hot work rules. | |
| Moving equipment/ machinery near work area | Struck by or run over by equipment/machinery. Not being properly trained. | 1B | DDC/ST | Wearing Hi-Vis Vest is recommended, have spotters in place and if possible, cordon off area where moving equipment is operating. Post signage. Operators are to have valid training. | |
| Use of man lift | Defective equipment, Poor ground conditions, dropped tools/material, not tied | 2B | DDC/ST | All equipment must be inspected and documented before use and copy passed into site management. Ensure ground | |

| | | | | | |
|-----------------------------|---|----|--------|--|--|
| | off in lift. No training on lift or fall protection. Overloading lift | | | conditions will hold the man lift. Workers are to be kept clear of overhead work if there is a chance for tools/material to fall. Secure area if needed. All operators in lift must have a valid training cert and all workers in the lift must have a valid fall protection training cert. 100% tie off in the lift at all times. Know the weight of all tools, material and workers in the lift and know what the weight capacity of the lift is. Never overload a lift. | |
| Overhead work | Dropped tools/material | 2B | DDC/ST | Stay away from overhead work if it's not your task and tape off if needed and have warning signage. | |
| Housekeeping | Poor housekeeping | 2B | DDC/ST | All crews must keep a clean work site. All debris must be cleaned up as you go. Additional cleaning will be at the discretion of the site superintendent. | |
| Working around other trades | Other trades not knowing your hazards | 4A | DDC/ST | Communicate with all trades on site. If you have hazardous work that could affect another trade, then communicate it with them or tape and tag off the hazardous area. | |
| Extension Cords | Not inspecting cords, missing ground, cuts in cords, | 3B | DDC/ST | All extension cords shall be checked for broken insulator covering, missing ground plug and general condition. Cords are to be maintained in good condition. Site management will periodically inspect cords and remove any that do not meet the minimum standards. | |
| Tower Crane | No control zones No crane certs No Crane logs Improper rigging Defective rigging Poor ground conditions Overhead loads- workers walking under loads/ swinging loads over workers. No tag lines used | 1B | DDC/ST | Before any craning is done ensure there is a control zone in place. Crane certs must be checked and a copy on file. Only competent riggers to be used. All rigging is to be certified and inspected before use. Ensure ground conditions will support out riggers. At no time can a worker walk under a suspended load or any load swung over top of a worker. Keep all body parts away from all crush/pinch points. All lifts must have one or more tag lines | |
| Plumbing | -Sharp pipe ends -Doing hot work (fire) -Cutting a pressured line causing property | 1B | DDC/ST | -ensure proper PPE for task -follow all hot work procedures. -Follow LOTO procedure -keep work area clean -Know SWPP | |

| | | | | | |
|---|--|----|--------|---|--|
| | <p>damaged or worker injury</p> <ul style="list-style-type: none"> -improper lifting -poor housekeeping | | | - Clean as you go. | |
| Mechanical work. | <ul style="list-style-type: none"> -Sharp edges, -Back injury do to lifting. -Live equipment. -Poor housekeeping - cutting duct work/hot work | 1B | DDC/ST | Use proper PPE when handling sharp material. Get help with lifting when needed. Use mechanical advantage when possible. Never work on live equipment when there are moving parts and exposed live power. LOTO to be used. Clean as you go. | |
| Electrical | Sharp conduit and knives, wiring wrong, working on live power, shocks, electrocution, arc flash. Poor Housekeeping. | 1B | DDC/ST | Workers must be aware of sharp edges and wear the proper PPE for each task. Proper supervision of crew for safety and to ensure installation of electrical is done proper. Never work on live power unless the proper training and PPE is used. Clear out all workers from the area that doesn't have the proper training and or PPE on. LOTO of wires before working on them. Clean as you go. | |
| Ladders | Not securing ladders, not inspecting ladders Improper ladder setup. Falls. | 2C | DDC/ST | Visual pre-use inspection of all ladders. Defective ladders are to be tagged out of service and removed from site. Ladders shall be contractor grade 1 or 2, in good shape with no missing parts and used within manufacturers guidelines. Ladders are to be tied off and extend 1 meter above the safe landing surface. Step Ladders are not to be leaned against the wall or equipment they are to be used only when in the open position. Documented inspection yearly on all ladders. | |
| Hand tools/ power tools/ pneumatic tools. | Not inspected, defective and no training. Not grounded tools. | 4D | DDC/ST | Visual daily inspected and in good working order and used for the appropriate job. Tag out any defective tools, remove from site. Follow SWPP and manufacturers specifications and get on the job training for tools. | |
| Working at heights | Falls, dropped tools/material, workers under your work area, defective fall protection gear | 1B | DDC/ST | All work at heights must have the areas secured below if there is a danger of tools or material falling. 100% tie off at 3m (10') and over. Ensure all gear is inspected before use and has the yearly inspection tag on it. When using fall protection there must be a rescue plan in place. | |

| | | | | | |
|--------------------------|--|----|--------|--|--|
| Weather | High winds, Ice, snow, rain, low and high temperatures. | 3C | DDC/ST | Monitor weather conditions daily, weekly. Plan ahead and secure any materials that potentially could create hazards. Snow removal and sanding and salting of site. Dress in layers and warm up in low temperatures. High temperatures drink water, take mini breaks, wear sunscreen. | |
| Trenching and Excavation | No training, no proper shoring or slopping. Water accumulation in trench, no emergency plan. Not following Site rules and OHS act and regulations | 1C | DDC/ST | Proper training, follow rules and regulations when it comes to trench and excavation safety at all times. Emergency plan in place. | |
| Concrete Work | Overexertion and awkward postures. Slips, trips, and falls. Chemical burns from wet concrete. Lack of training on equipment, safeguards not in place on equipment. | 2C | DDC/ST | Stretching and mini breaks, drink water. Watch footing, clean as you go, guardrails. Wear proper PPE, ensure all workers are trained on tasks/equipment. Never remove safeguards from any piece of equipment and use LOTO for maintenance and defective tools/ equipment. | |
| Form Work | Working from heights 3m(10'), exposed rebar, slip, trips and falls, sharp edges, working with crane. | 1C | DDC/ST | Training, wear fall protection equipment, fall protection plan in place, install guardrails. Use rebar caps and/or proper rebar coverings. Practice good housekeeping and be vigilant. Wear task specific gloves and communicate with crane and be vigilant of live loads. | |
| Structural Steel/ Rebar | Cuts, Slip, trips and fall. Working from Heights. Overexertion and awkward postures. Lack of training on equipment, safeguards not in place on equipment. | 2C | DDC/ST | Stretching and mini breaks, drink water. Watch footing, clean as you go, guardrails or 100% tie off.. Wear proper PPE, ensure all workers are trained on tasks/equipment. Never remove safeguards from any piece of equipment and use LOTO for maintenance and defective tools/ equipment. | |

Once all the hazards have been found and prioritized, they should next be ranked with the severity and probability.

Severity- What are the consequences of the hazard:

1. **Imminent danger**(causing deaths, widespread occupational illness, loss of facilities)
2. **Serious** (severe injury, serious illness, property or equipment damage)
3. **Minor**(non-serious injury, illness or damage)
4. **O.K.** (minor injury, requiring first aid or less)
5. **Not Applicable** (N/A)

Probability- How many times is the incident going to occur?

- A. **Probable**-Likely to occur immediately or soon.
- B. **Reasonably probable**-likely to occur eventually.

- C. **Remote**-could occur at some point.
D. **Extremely remote**-unlikely to occur.

Each hazard is assigned both ranking and the result determines priority in terms of corrective action.

A hazard ranked 1-A is more important than one marked 1-B.

Job Hazard Assessment Review by Work Crew

I have participated in a Job Hazard Review Meeting and understand the content and requirements of the attached Job Hazard Assessment.

[illegible]