

SCHEDULE “A”

AAN 08949549

PID 40753030

Lot 1 of the Widows Dowers Lots (so-called) in a division of lands of Frederick C. Dauphinee, shown on the Plan annexed to the Deed recorded in the Halifax County Registry of Deeds as Document 256 in Book 221 at Page 189 on March 19, 1879 and containing 3 Acres more or less.

Reference to Crown Grant 1253D recorded in Grant Book K at Page 210 in 1821.

Reference to the Deed recorded in Book 76 at Page 216 in 1844.

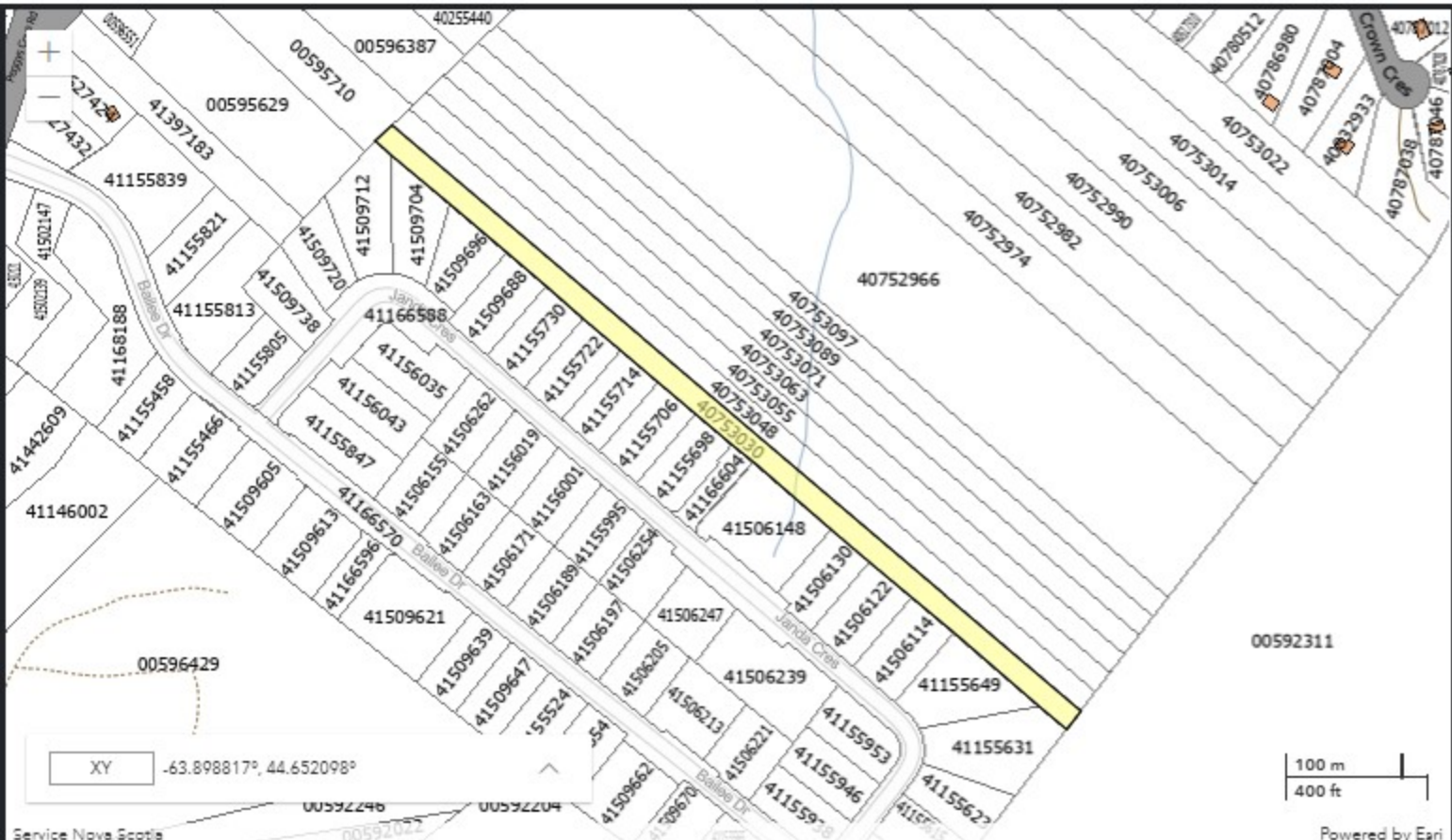

Lat: 44-39-007N

Long: 063-53-056W

Scale: 4505

Go

Zoom: 15

The Provincial mapping is a graphical representation of property boundaries which approximate the size, configuration and location of parcels. Care has been taken to ensure the best possible quality, however, this map is not a land survey and is not intended to be used for legal descriptions or to calculate exact dimensions or area. The Provincial mapping is not conclusive as to the location, boundaries or extent of a parcel [Land Registration Act subsection 21(2)]. THIS IS NOT AN OFFICIAL RECORD.