

SCHEDULE "A"

ALL those lands and premises which were conveyed to Charles Albert Burns, then an Insurance Adjuster, then of Amherst, Cumberland County, Nova Scotia, from Frances Jane Burns of Halifax, Halifax County, Nova Scotia, widow of Robert Roy Burns, by Warranty Deed dated May 27, 1961 and recorded at the Registry of Deeds for the County of Halifax at Halifax, Nova Scotia on May 31, 1961 in Book 1739 at Pages 365-367, and therein more particularly bounded and described as follows:-

"ALL that certain tract, piece or parcel of land situate, lying and being at Brookside in the County of Halifax, Province of Nova Scotia, more particularly described as follows:

BEGINNING at an iron pipe sunk in the ground on the eastern shore of Moosehorn Lake; THENCE South eighty-seven degrees twenty-five minutes East (S 87° 25' E) a distance of two hundred feet (200'); THENCE turning North ten degrees forty minutes West (N 10° 40' W) through an angle of seventy-six degrees forty-five minutes (76° 45') and running a distance of eighty feet (80'); THENCE turning North eighty-seven degrees twenty-five minutes West (N 87° 25' W) through an angle of one hundred three degrees fifteen minutes (103° 15') and running to shore of said Moosehorn Lake; THENCE Southerly along shore of said Moosehorn Lake to point of beginning.

Situation of above lot of land being more fully described as follows: Northwest of Lovely Cove Bridge on Old Terrence Bay Road as defined by traverse line beginning at a drill hole in rock on northern bank of said Lovely Cove Brook eight feet seven and three quarter inches (8' 7 3/4") West of said Lovely Cove Bridge; THENCE North one hundred twenty-five and one-tenth feet (125.1'); THENCE running North seventy-six degrees West (N 76° W) through an angle of one hundred four degrees (104°) a distance of one hundred twenty-nine and five-tenths feet (129.5'); THENCE North ten degrees forty minutes West (N 10° 40' W) through an angle of two hundred forty-five degrees twenty minutes a distance of five hundred thirty-six feet (536') to an iron pipe sunk in the ground marking the south-east corner of said lot. Also right of way to said lot along north and east side of said traverse line. All angles measured to the right. Bearings magnetic."

Reference is made to Book 4724 at Page 11

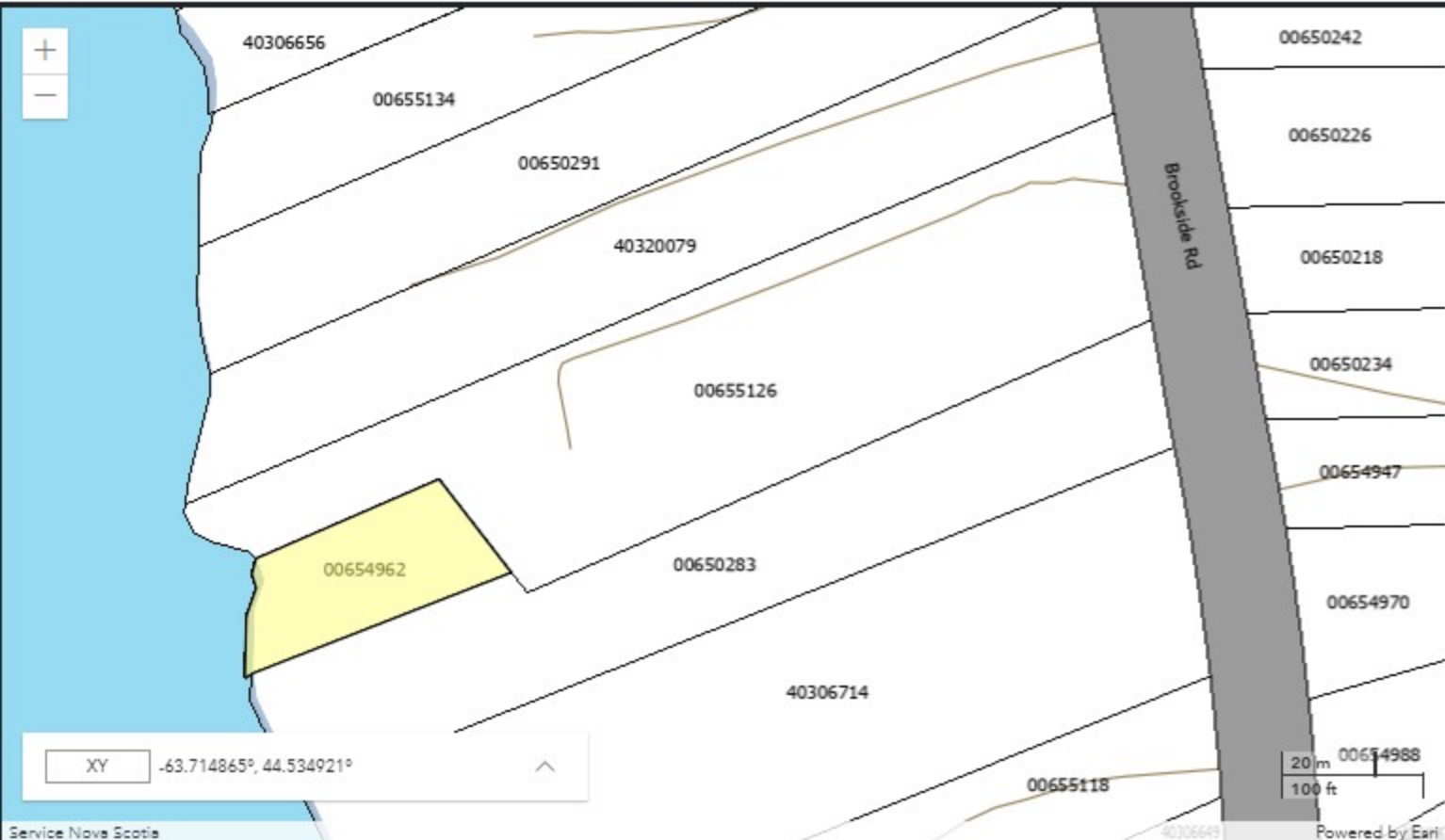

Lat: 44-32-006N

Long: 063-42-054W

Scale: 1126

Go

Zoom: 17

The Provincial mapping is a graphical representation of property boundaries which approximate the size, configuration and location of parcels. Care has been taken to ensure the best possible quality, however, this map is not a land survey and is not intended to be used for legal descriptions or to calculate exact dimensions or area. The Provincial mapping is not conclusive as to the location, boundaries or extent of a parcel [Land Registration Act subsection 21(2)]. THIS IS NOT AN OFFICIAL RECORD.