

SCHEDULE "A"

ALL that certain lot, piece or parcel of land situate, lying and being in the district of Ferguson's Cove, County of Halifax Province of Nova Scotia, and marked Lot 3A on "Plan Showing Lot 3A Lynch Property", dated 24 May 1976 and signed by R.J. Donovan, Nova Scotia Land Surveyor, said Lot 3A being more particularly described as follows:

Beginning at a point on the line dividing property of the Estate of William Palmer Lynch from land formerly of H.M. the Queen (Connaught Battery) distant northeastwardly one hundred fourteen and three tenths (114.3) feet from Crown Post 5310;

Thence south seventeen degrees seven minutes and forty-three seconds east ($S 17^{\circ} 07' 43'' E$), a distance of twelve (12) feet;

Thence north seventy-two degrees fifty-two minutes and seventeen seconds east ($N 72^{\circ} 52' 17'' E$), a distance of thirty-eight (38) feet;

Thence north seventeen degrees seven minutes and forty-three seconds west ($N 17^{\circ} 07' 43'' W$), a distance of twenty-five and one tenth (25.1) feet to the dividing line between land of the Estate of William Palmer Lynch and land formerly of H.M. the Queen (Connaught Battery);

Thence south fifty-three degrees fifty-two minutes and seventeen seconds west ($S 53^{\circ} 52' 17'' W$) along land formerly of H.M. the Queen (Connaught Battery) a distance of forty and two tenths (40.2) feet to the point of beginning.

Reference is made to Document No. 119248350

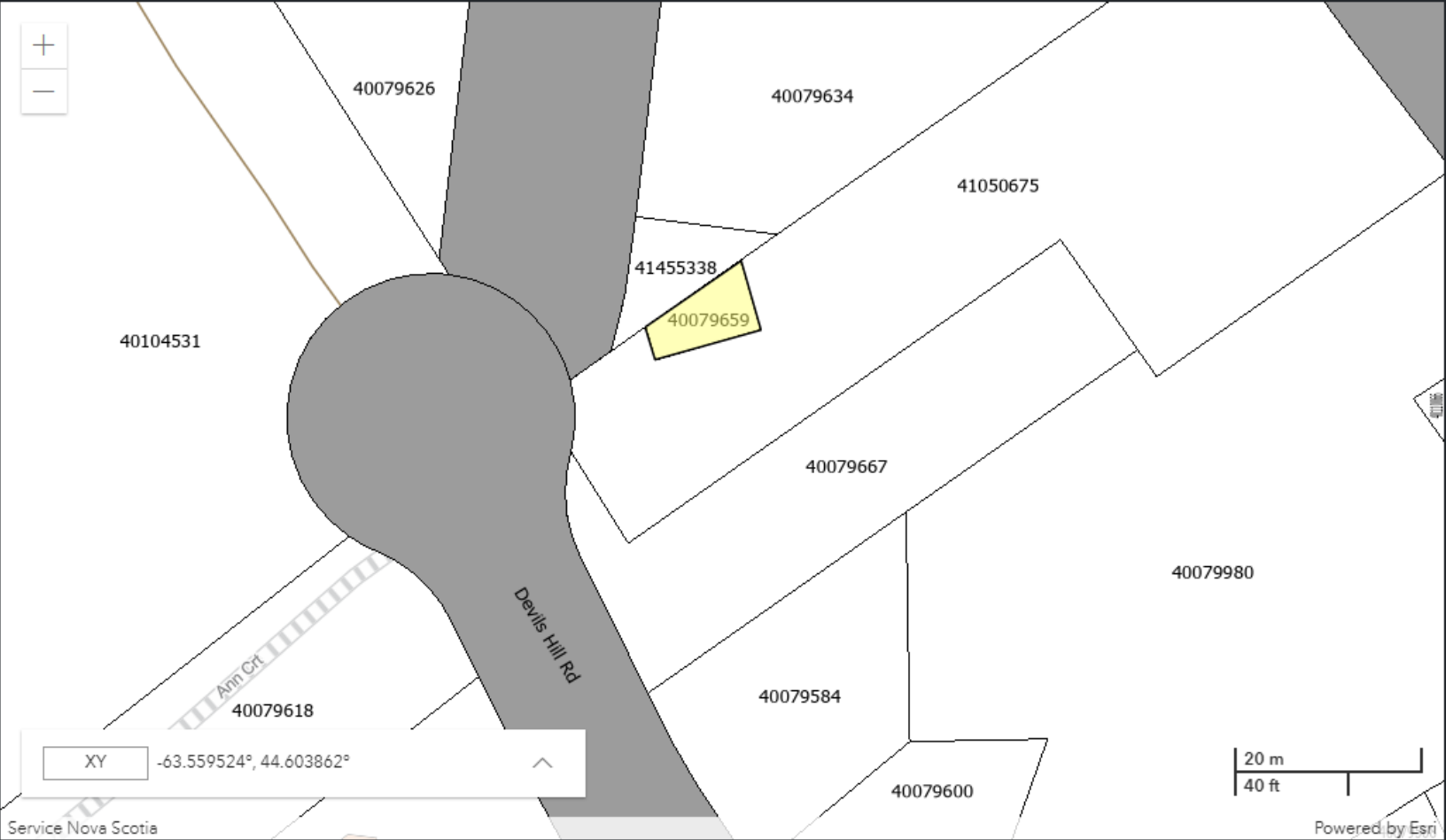

Lat: 44-36-014N Long: 063-33-034W Scale: 563 Go Zoom: 18

The Provincial mapping is a graphical representation of property boundaries which approximate the size, configuration and location of parcels. Care has been taken to ensure the best possible quality, however, this map is not a land survey and is not intended to be used for legal descriptions or to calculate exact dimensions or area. The Provincial mapping is not conclusive as to the location, boundaries or extent of a parcel [Land Registration Act subsection 21(2)]. THIS IS NOT AN OFFICIAL RECORD.