

SCHEDULE “A”

All that right, title and interest of the assessed owner, Sheila Dean, in the following personal property:

Mobile Home
Serial #UNKNOWN
Located at 1463 Highway 336, Dean
Halifax Regional Municipality

SCHEDULE "A"

} All that lot of land situate at Dean, in the County of Halifax, Province of Nova Scotia, shown as Lot 79-1 on plan entitled "lots 79-1 & 79-2, Subdivision of Lands of Harold P. Lemmon" and dated the 25th day of May A.D. 1979 by E.C. Keen, N. S. L. S., the said lot of land being more particularly bounded and described as follows:

BEGINNING at a survey marker set on the North West boundary line of Route # 336 Highway at a point being distant 50 feet at right-angles from the centre of said highway and being at the South corner of lands belonging to Russell Henley, said marker being distant 705.02 feet on a bearing of South 40° 51.7' West from Nova Scotia Control Monument # 9823;

THENCE South 39° 15.3' West a distance of 150 feet along the said highway boundary to a survey marker;

THENCE North 47° 06.6' West a distance of 145.50 feet along lands of Harold P. Lemmon to a survey marker;

THENCE North 39° 15.3' East a distance of 150 feet along lands of Harold P. Lemmon to a survey marker;

THENCE South 47° 06.6' East a distance of 145.50 feet along lands of Russell Henley to the point of beginning.

Said lot of land containing 21,781 square feet and being a portion of lands conveyed from Georgie Dean to Harold Lemmon by deed as recorded at the Registry of Deeds, Halifax in Book 1426, Page 92.

All bearings referable to Grid North
(3° M. T. N., C. M. 64° 30' West)

Reference is made to Book 4486 at Page 814

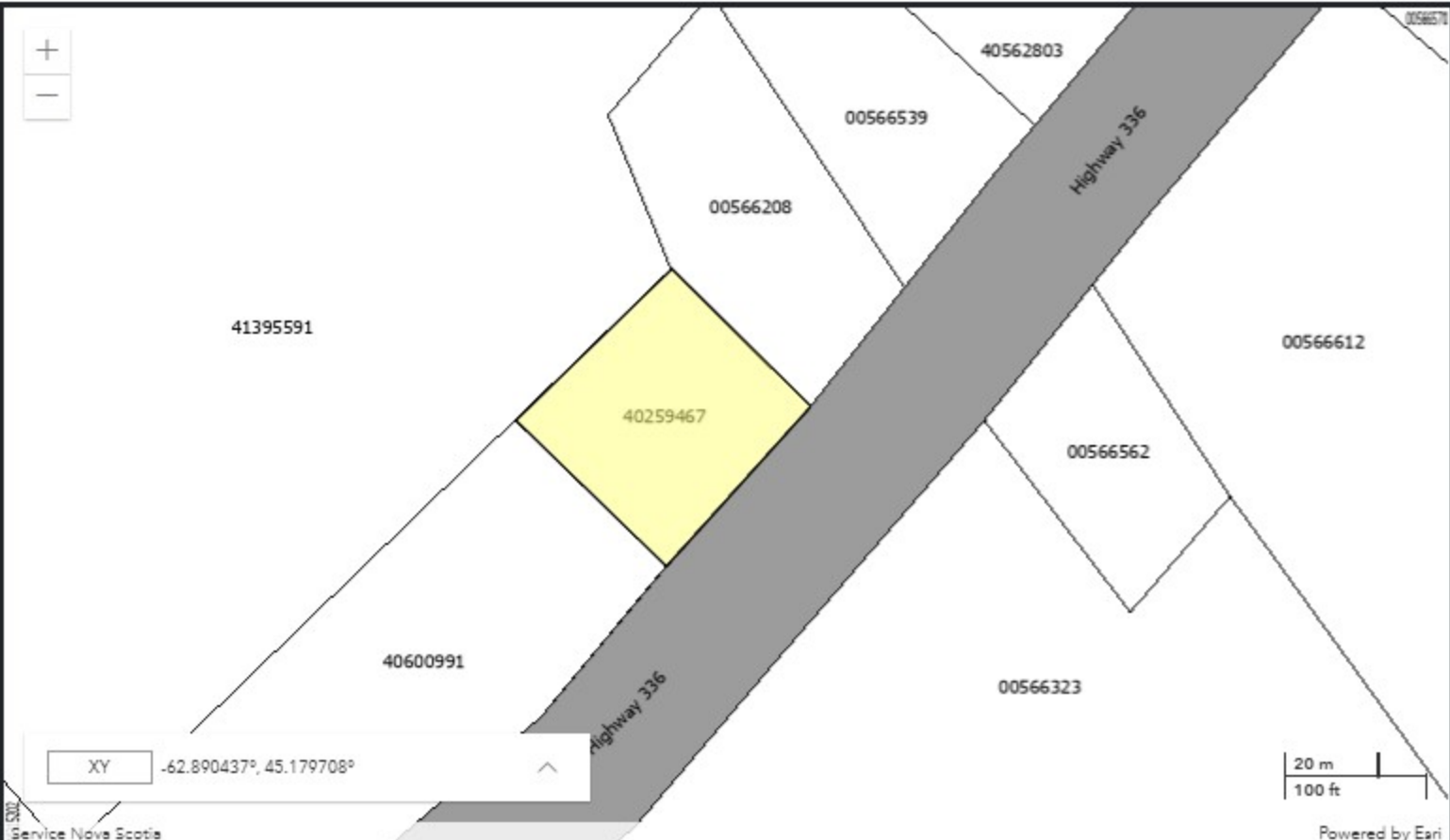

Lat: 45-10-047N

Long: 062-53-026W

Scale: 1126

Go

Zoom: 17

The Provincial mapping is a graphical representation of property boundaries which approximate the size, configuration and location of parcels. Care has been taken to ensure the best possible quality, however, this map is not a land survey and is not intended to be used for legal descriptions or to calculate exact dimensions or area. The Provincial mapping is not conclusive as to the location, boundaries or extent of a parcel [Land Registration Act subsection 21(2)]. THIS IS NOT AN OFFICIAL RECORD.