

PARCEL DESCRIPTION REPORT

SCHEDULE "A"

2025-03-03 11:03:09

01676881

PID: 295204
CURRENT STATUS: ACTIVE
EFFECTIVE DATE/TIME: 2006-04-27 10:37:45

Municipality/County: Halifax
Designation of Parcel on Plan: Lot 96A
Registration County: Halifax
Registration Reference of Plan: Plan No. 6294 Drawer 94

SUBJECT TO an easement upon, over, under, along and across the rear five feet of the said lot number ninety-six A for the purpose of constructing, repairing, replacing, operating and maintaining electric and telephone lines including all necessary poles, wires, cables, (both buried and aerial) conduit, fixtures and guys and anchors in connection therewith. The said easement shall include (without limiting the generality of the foregoing) the right to trim trees and shrubs so as to keep the said wires and cables clear at least two feet and as contained in a Deed recorded at the Halifax County Registry of Deeds in Book 1871 at Page 772.

SUBJECT TO a right of way agreement dated June 20 1962 and made between Clayton Development Limited of the one part, and Nova Scotia Light and Power Company Limited, of the other part and recorded in the Registry of Deeds at Halifax on August 6, 1962 in Book 1852 at Page 523.

SUBJECT TO restrictive covenants as contained in a Deed recorded at the Halifax County Registry of Deeds in Book 1871 at Page 772.

The parcel originates with an approved plan of subdivision that has been filed under the Registry Act or registered under the Land Registration Act at the Land Registration Office for the registration district of Halifax as plan number 6294 Drawer 94.

External Comments:

Description Change Details:

Reason:
Author of New or
Changed Description:
Name:

Registered Instruments:

Comments:

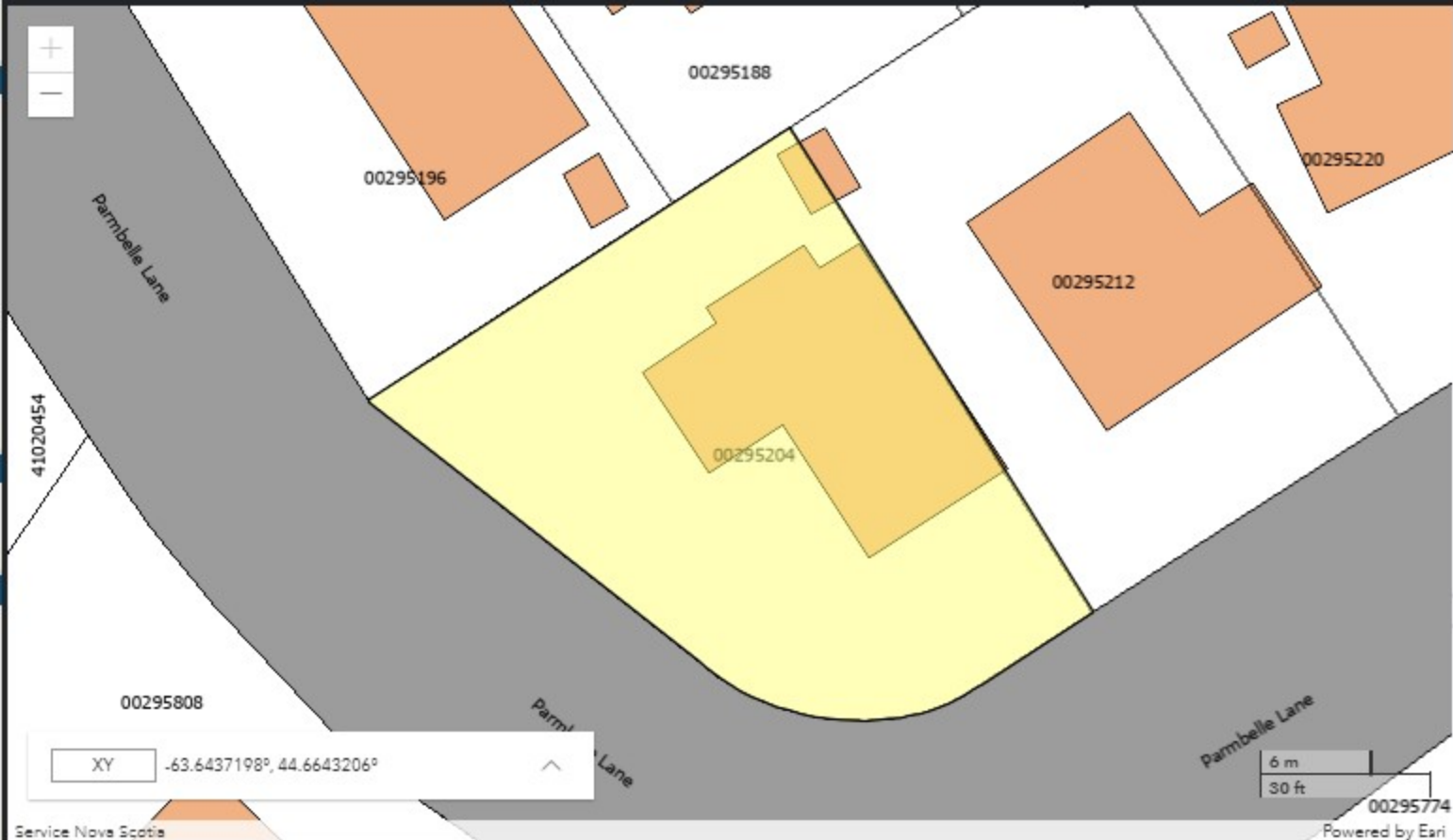

Lat: 44-39-052N

Long: 063-38-037W

Scale: 282

Go

Zoom: 19

The Provincial mapping is a graphical representation of property boundaries which approximate the size, configuration and location of parcels. Care has been taken to ensure the best possible quality, however, this map is not a land survey and is not intended to be used for legal descriptions or to calculate exact dimensions or area. The Provincial mapping is not conclusive as to the location, boundaries or extent of a parcel [Land Registration Act subsection 21(2)]. THIS IS NOT AN OFFICIAL RECORD.