

SCHEDULE "A"

ALL that piece or parcel of land being and lying at Popes Harbour,

As described being a lot of land as follows:

STARTING from the Queens Highway running South along the Road of Maxwell

Daye, One Hundred and Forty Feet (140);

THENCE East One Hundred and Fifty Feet (150);

THENCE North along the line of Ernest Abriel One Hundred and Ninety Feet

to the Main Highway;

THENCE along the Main Highway running West One Hundred and Fifty Feet

(150) to the place of the beginning.

Reference is made to Document No. 88440665

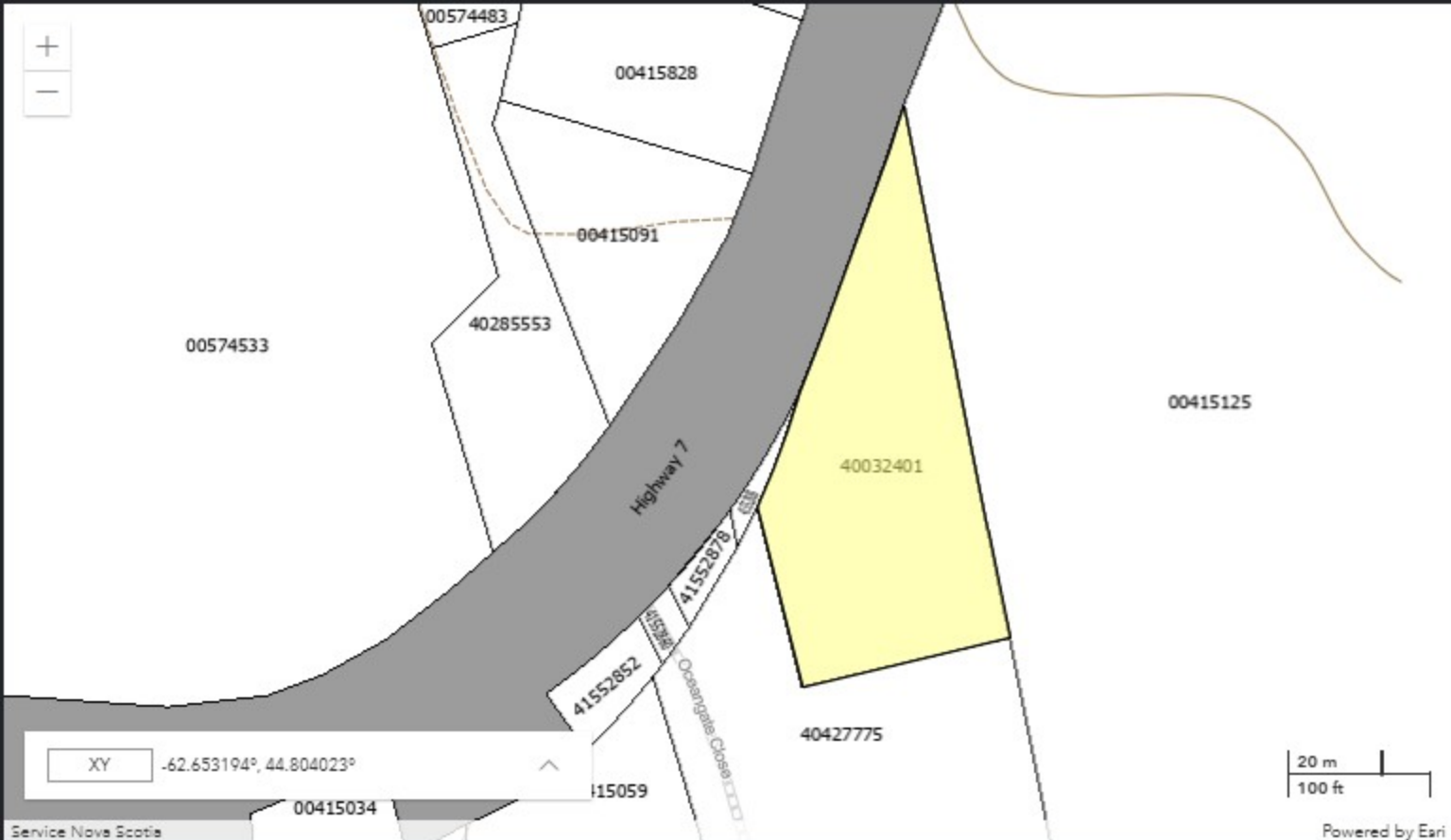

Service Nova Scotia

Lat: 44-48-014N

Long: 062-39-012W

Scale: 1126

Go

Zoom: 17

The Provincial mapping is a graphical representation of property boundaries which approximate the size, configuration and location of parcels. Care has been taken to ensure the best possible quality, however, this map is not a land survey and is not intended to be used for legal descriptions or to calculate exact dimensions or area. The Provincial mapping is not conclusive as to the location, boundaries or extent of a parcel [Land Registration Act subsection 21(2)]. THIS IS NOT AN OFFICIAL RECORD.