

Parcel Summary

15 Laurelcrest Dr, Eastern Passage

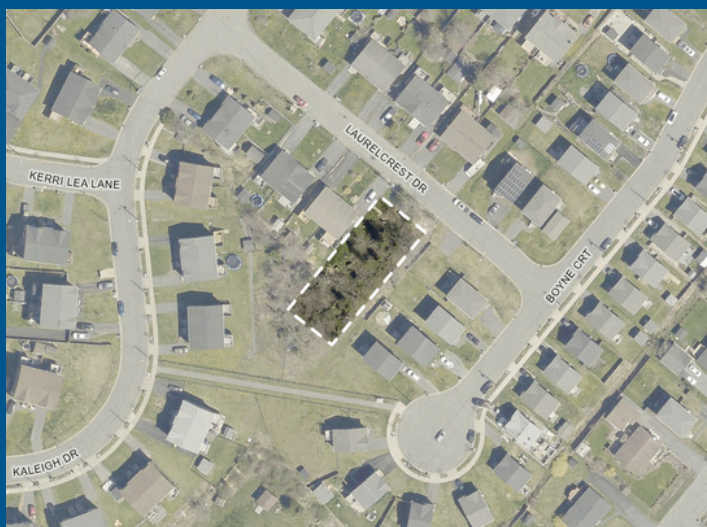

15 Laurelcrest Drive is a suburban lot located in Eastern Passage, with excellent access to amenities and no known environmental issues. The surrounding area is mostly composed of single-family homes and public green space. There is a public playground, elementary school, high school, recreation centre and grocery store within a 15-minute walk of the site. There are also bus stops within 250m that serves the #6B and #6C transit routes. Residents can access the Woodside Ferry Terminal in 20 minutes by transit.

Site details	
Parcel ID:	40507220
Civic address	15 Laurelcrest Dr, Eastern Passage
Assessed value	\$140,000
Site servicing	Urban Service Area
Plan area	Eastern Passage/Cow Bay
Zone	R-2
Lot size	885 m ²
Max height	10.7 metres
Max density	4 units
Max lot coverage	35%

Distance to amenities	
Elementary school	0.9 km
High school	0.9 km
Community centre	1.0 km
Public park	0.2 km
Grocery store	1.2 km
Bus stop	0.2 km

Permitted housing types
<ul style="list-style-type: none"> • Single detached dwelling • Two-unit dwelling • Multi-unit dwelling • Shared housing • Auxiliary dwelling unit