

PARCEL DESCRIPTION REPORT

SCHEDULE "A" Page 1 of 2

2024-10-20 16:53:08

PID: 371666
CURRENT STATUS: ACTIVE
EFFECTIVE DATE/TIME: 2006-06-15 15:45:57

AAN 00019062

PARCEL 3 being all that certain lot, piece or parcel of land situate, lying and being on the southern side of Josey Road at Spry Bay in the County of Halifax, Province of Nova Scotia, being and comprising of that lot of land shown as Parcel 3 on plan of survey numbered A1-078 signed by E. J. Webber, N.S.L.S dated June 17 1987, showing lands conveyed to Dennis Graham Adair; said Parcel 3 being more particularly described as follows:

BEGINNING At a survey marker set at the intersection of the southern boundary of Josey Road and the eastern boundary of Parcel 2;

THENCE South 72 degrees 14 minutes 08 seconds East along the southern boundary of Josey Road, a distance of 217.75 feet to a survey marker at a point of curvature;

THENCE Easterly along the southern boundary of Josey Road an arc distance of 96.84 feet to a survey marker at a point of tangency, said road boundary being the arc of a circular curve to the left having a radius of 593.42 feet and having a chord bearing of South 76 degrees 54 minutes 39 seconds East, a distance of 96.74 feet;

THENCE South 81 degrees 35 minutes 10 seconds East along the southern boundary of Josey Road, a distance of 80.71 feet to a survey marker;

THENCE South 81 degrees 35 minutes 10 seconds East along the southern boundary of Josey Road, a distance of 15 feet more or less to a brook;

THENCE Southwesterly along the various courses of said brook, a distance of 480 feet more or less, to the ordinary high water mark of Taylor Bay (Spry Harbour);

THENCE Westerly along the various courses of ordinary high water mark of Taylor Bay (Spry Harbour), a distance of 95 feet more or less, to the southeastern corner of Parcel 2;

THENCE North 10 degrees 26 minutes 52 seconds East along the eastern boundary of Parcel 2, a distance of 20 feet more or less to a survey marker;

THENCE North 10 degrees 26 minutes 52 seconds East along the Eastern boundary of Parcel 2, a distance of 334.67 feet to the point of beginning.

The description for this parcel originates with a deed dated February 10, 1964, registered in the registration district of Halifax in book 1959 at page 532 and the subdivision is validated by Section 291 of the Municipal Government Act.

External Comments:

Description Change Details:

Reason:

Author of New or

Changed Description:

Name:

Registered Instruments:

2024-10-20 16:53:08

Comments:

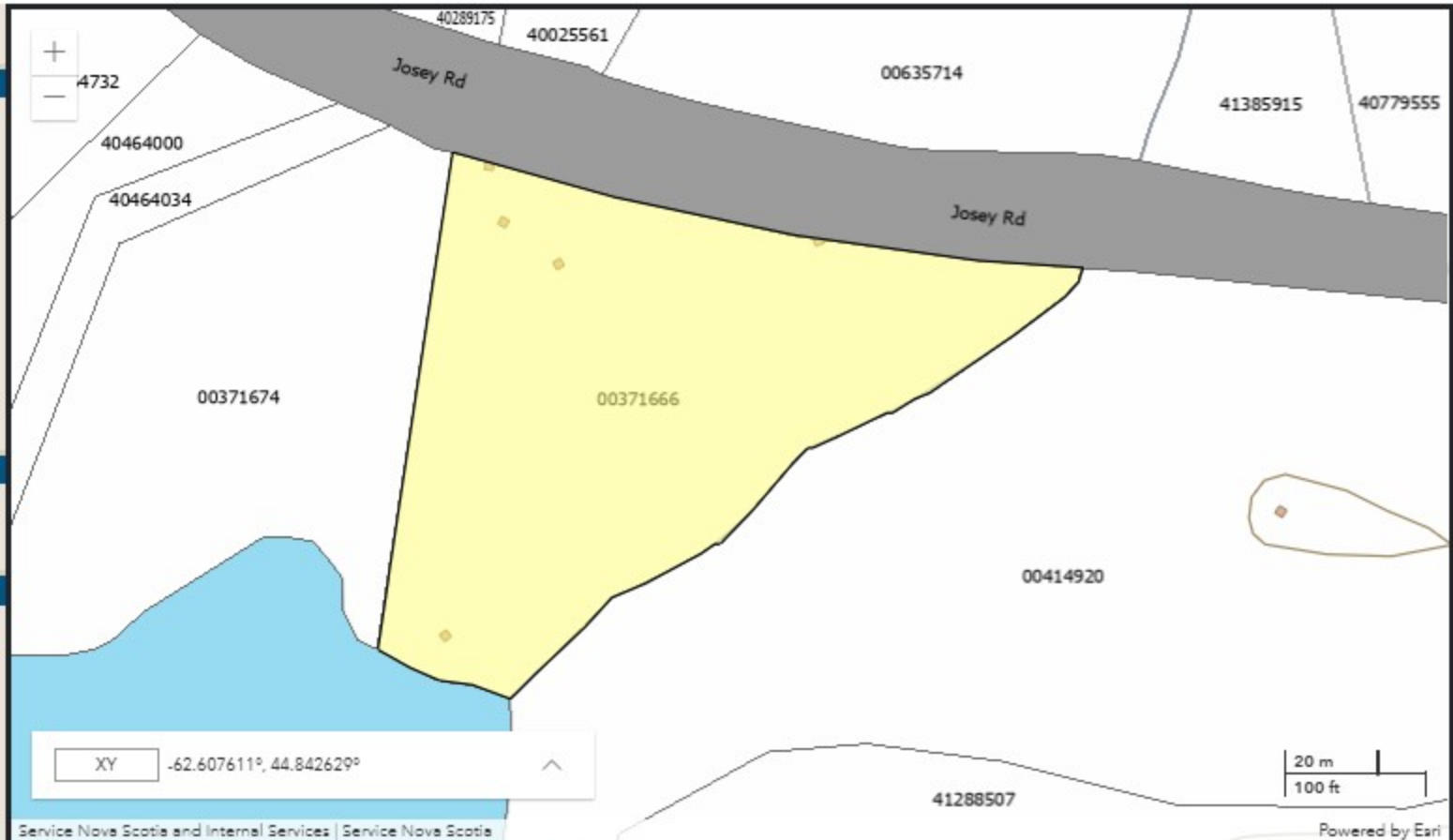

Lat: 44-50-033N

Long: 062-36-027W

Scale: 1126

Go

Zoom: 17

The Provincial mapping is a graphical representation of property boundaries which approximate the size, configuration and location of parcels. Care has been taken to ensure the best possible quality, however, this map is not a land survey and is not intended to be used for legal descriptions or to calculate exact dimensions or area. The Provincial mapping is not conclusive as to the location, boundaries or extent of a parcel [Land Registration Act subsection 21(2)]. THIS IS NOT AN OFFICIAL RECORD.