

FILE: C:\Users\Kyle\Zwickler\Projects - 2022\Projects\22-057 Bowers Crestfield Office\4_Planning\1-DWG\22-057-SITE_PLAN-100.dwg SHEET: 11x17

LEGEND
 Site Boundary
 Adjacent Property Boundary

SITE SUMMARY:
• PID: 00422279
• Total Land Area: 21,656 SF
• Existing Zone: P-2

NOTES:
• Subject to survey. Property lines and topographic features are approximate only.
• Site subject to by-law review and regulations.

SOURCES:
• Plan based on BOWERS CONSTRUCTION Site Plan Rev 2 dated 01.07.2022
CAD file: 'A001.dwg'

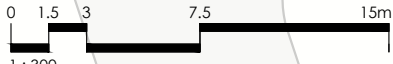
SCALE:

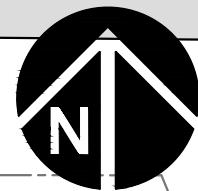
1 : 300

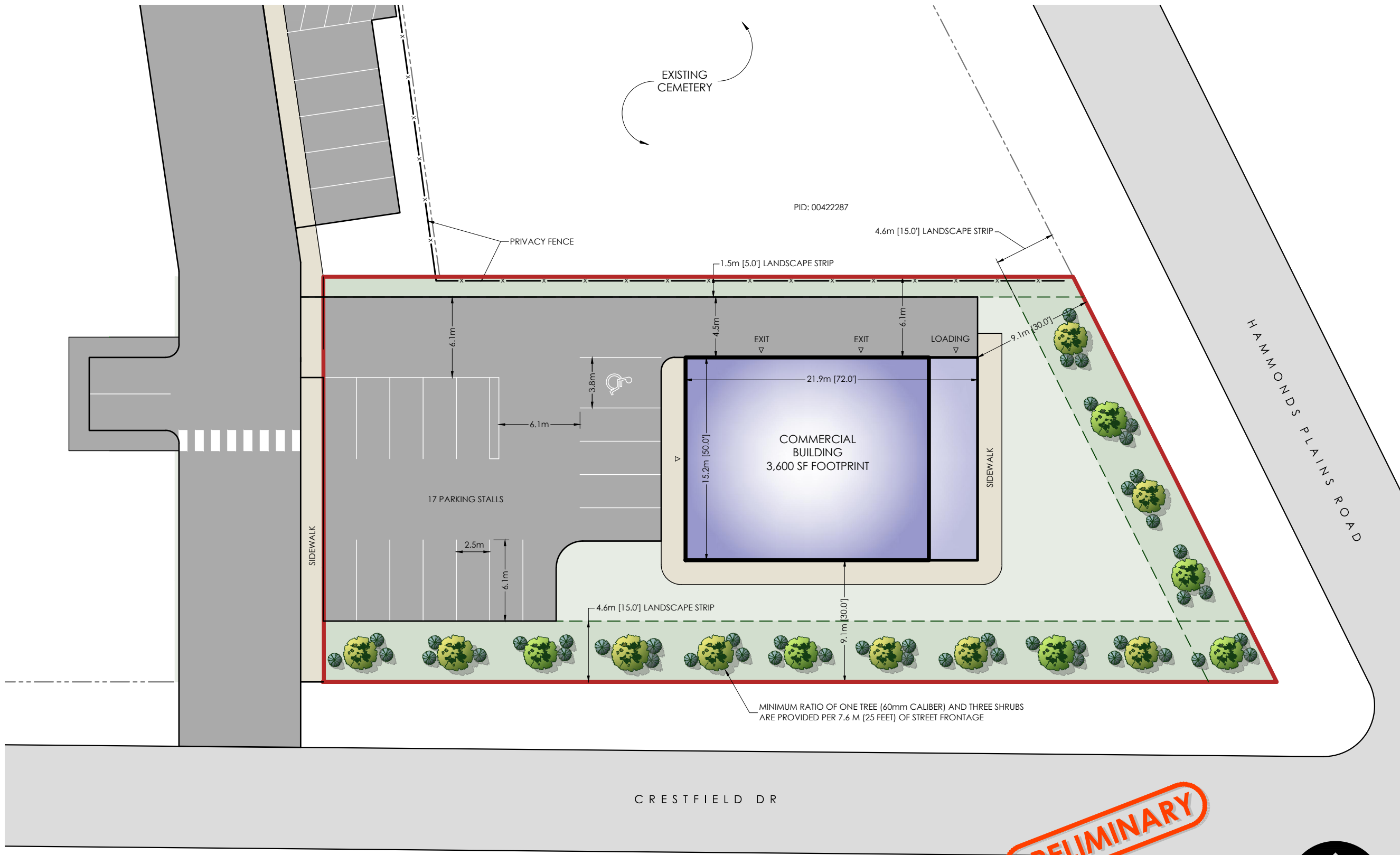

PRELIMINARY



CLIENT
BOWERS CONSTRUCTION

PROJECT
CRESTFIELD PROFESSIONAL OFFICES
Crestfield Drive, Hammonds Plains, Nova Scotia

DRAWING
SITE PLAN

PROJECT NO. **22-057** DRAWING NUMBER
DRAWN BY: KJW
100
DATE: JUNE 28, 2022