

GRID NORTH

LEGEND

| PERIMETER OF LANDS SURVEYED | |
|-----------------------------|---|
| x123.4 | SPOT ELEVATION |
| ○ MH | MANHOLE |
| ⊗ | CATCHBASIN |
| ⌒ CVINV | CULVERT INVERT |
| ⊕ BMF/BMS | BENCHMARK FOUND/SET |
| ⊙ < | UTILITY POLE & ANCHOR |
| ⊙ * | LIGHT POLE |
| ⊙ | LIGHT STANDARD |
| ⊙ | FIRE HYDRANT |
| ⊙ | WATER VALVE |
| ⊙ | BOLLARD |
| ⊙ | SIGN POST |
| HCLRO | HALIFAX COUNTY LAND REGISTRATION OFFICE |
| PID | PARCEL IDENTIFICATION NUMBER |
| CONC | CONCRETE |
| R/W | RETAINING WALL |
| O/H | OVERHANG |
| ⊖ | CHAINLINK FENCE |
| ⊖ | WOOD FENCE |
| --- | OVERHEAD WIRES |
| --- | TOP OF SLOPE |
| --- | TOE OF SLOPE |
| --- | CENTRELINE OF DITCH/STREAM |
| ⊙ | HARDWOOD TREE |
| ⊙ | SOFTWOOD TREE |

NOTES

- ELEVATIONS ARE BASED ON CANADIAN GEODETIC VERTICAL DATUM 2013 AND REFER TO NOVA SCOTIA COORDINATE MONUMENT NO. 222299; ELEVATION = 115.000 METRES.
- FIELD SURVEYS WERE CARRIED OUT ON OCTOBER 5, 2021.
- CAUTION:** BOUNDARY LINES SHOWN HEREON HAVE BEEN COMPILED FROM VARIOUS PLANS AND DOCUMENTS. SUFFICIENT FIELD SURVEY HAS NOT BEEN CONDUCTED TO VERIFY THEIR ACCURACY.
- CAUTION:** DIGITAL DATA BASED ON THIS SURVEY MUST BE USED IN CONJUNCTION WITH THIS PLAN. USERS ARE ADVISED TO CONFIRM THE ACCURACY OF DIGITAL INFORMATION NOT EXPRESSLY INDICATED HEREON.
- CAUTION:** SERVICE INFORMATION SHOWN HEREON WAS COMPILED FROM FIELD SURVEY AND DATA OBTAINED FROM VARIOUS UTILITY OPERATORS. THE EXACT LOCATION OF UNDERGROUND SERVICES IS NOT CONFIRMED. CONTACT SHOULD BE MADE WITH ALL UTILITY OPERATORS RELATING TO THE CONFIRMATION OF THE SERVICES SHOWN HEREON AND FOR OTHER SERVICES WHICH MAY EXIST BEFORE CONSTRUCTION COMMENCES.

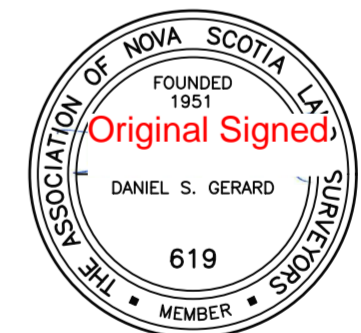

Servant, Dunbrack, McKenzie & MacDonald Ltd.
NOVA SCOTIA LAND SURVEYORS & CONSULTING ENGINEERS
36 OLAND CRESCENT BAYERS LAKE BUSINESS PARK HALIFAX, NS B3S 1C6
PHONE: (902) 455-1537 FAX: (902) 455-8479 WEB: www.sdmm.ca

LOT A1-B
SACKVILLE DRIVE
MIDDLE SACKVILLE, HALIFAX COUNTY, NOVA SCOTIA

EXISTING CONDITIONS

| | | |
|-----------------|-------------|--------------------------|
| Date | Drawn | Project No. |
| OCTOBER 8, 2021 | K. KEARNEY | FILE No. 1-13-49 (36512) |
| Scale | Checked By | Plan No. |
| 1:500 | D. GERARD | 13-3082-0 |
| Reference | Reviewed By | Drawing Name |
| | D. GERARD | |
| Surveyed | Sheet | |
| SDMM | 1 OF 1 | |

