

# LEGEND

EXISTING		PROPOSED	
⊗/⊗ BF	CURB STOP/GATE/BUTTERFLY VALVE	⊗/⊗ BF	
⊙	FIRE HYDRANT	⊙	
↔	SIAMESE SPRINKLER CONNECTION	↔	
■/■/○	CATCH BASIN/PIT	■/■/○	
⚡	POWER POLE/LIGHT POLE	⚡	
🌳	TREE	🌳	
♣	STREET SIGN	♣	
— GAS —	GAS LINE	— GAS —	
— W —	WATER MAIN/SERVICE	— W —	
● SAN	SANITARY MANHOLE & PIPE	● SAN	
○ STM	STORM MANHOLE & PIPE	○ STM	
● SAN/STM	COMBINED SEWER	● SAN/STM	
—	PROPERTY LINE/BOUNDARY	—	
▭	BUILDING	▭	

## NOTES

- EXISTING WATER, STORM & SANITARY SEWER, AND GAS UNDERGROUND PIPING BASED ON HW & HERITAGE GAS GIS DATA AND RECORDS. CONTRACTOR TO VERIFY EXACT LOCATIONS AND ELEVATIONS IN THE FIELD.
- PROPERTY BOUNDARIES HAVE BEEN COMPILED FROM VARIOUS SOURCES AND ARE SUBJECT TO SURVEY.
- ALL WORK SHALL BE COMPLETED IN ACCORDANCE WITH NOVA SCOTIA REGULATIONS AND HRM BY-LAWS, HALIFAX WATER DESIGN AND CONSTRUCTION SPECIFICATIONS (LATEST EDITION) AND HRM MUNICIPAL SERVICE SYSTEM GUIDELINES "RED BOOK" (LATEST EDITION).
- CONTRACTOR TO HAVE SERVICES LOCATED IN THE FIELD PRIOR TO DIGGING.
- CONTRACTOR TO REMOVE EXISTING LATERALS TO THE MAIN AND REMOVE OLD VALVES. WATER SERVICES TO BE PLUGGED AT MAIN AND SEWER CAPPED AT THE MAIN.
- LANDSCAPED ROOF AND ROOF CONTROL FLOW DRAINS WILL REDUCE POST DEVELOPMENT STORMWATER BELOW PRE-DEVELOPMENT FLOWS.

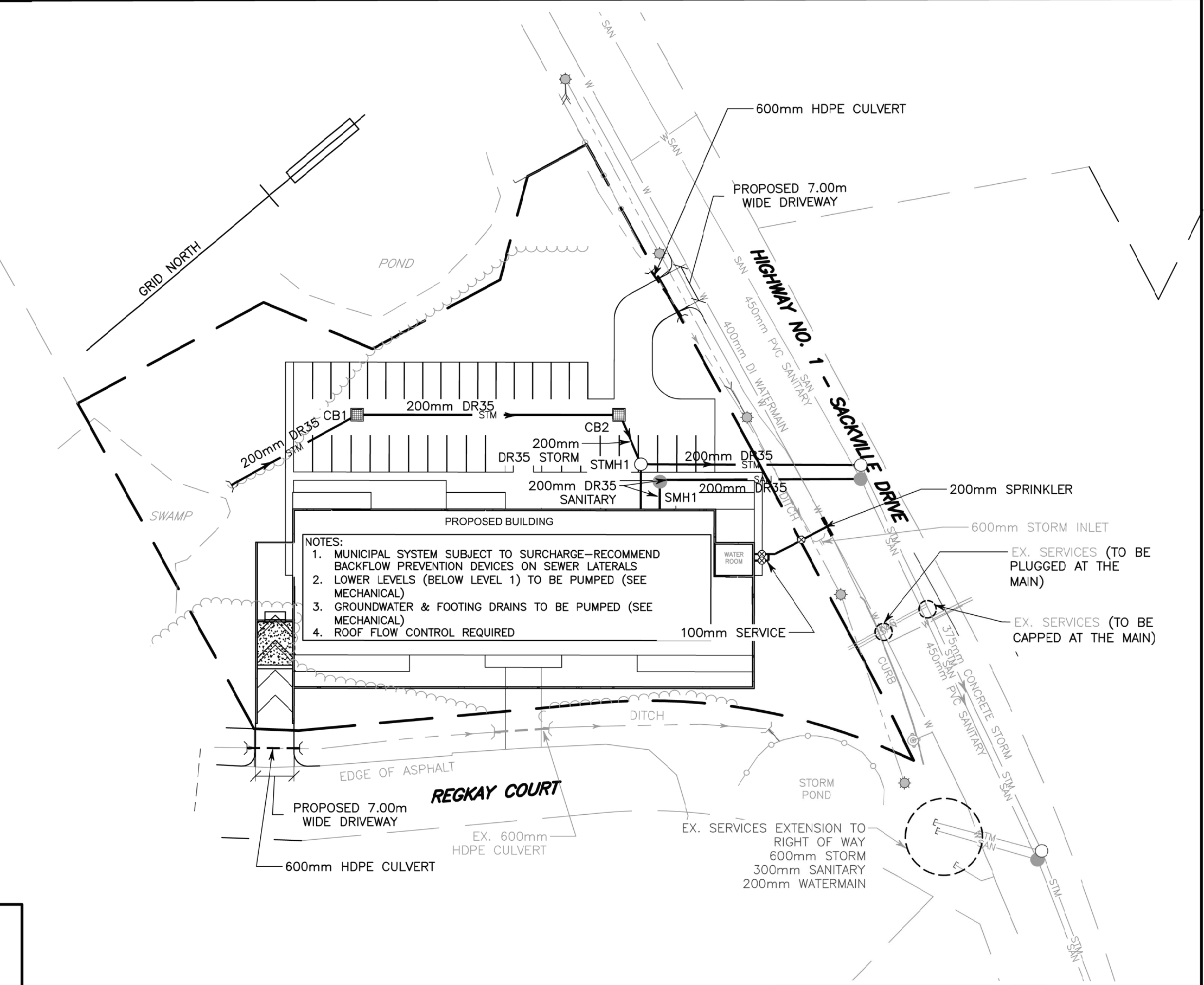

NOTES:  
 1. MUNICIPAL SYSTEM SUBJECT TO SURCHARGE—RECOMMEND BACKFLOW PREVENTION DEVICES ON SEWER LATERALS  
 2. LOWER LEVELS (BELOW LEVEL 1) TO BE PUMPED (SEE MECHANICAL)  
 3. GROUNDWATER & FOOTING DRAINS TO BE PUMPED (SEE MECHANICAL)  
 4. ROOF FLOW CONTROL REQUIRED

**SDMM**  
 36 OLAND CRESCENT  
 BAYERS LAKE BUSINESS PARK  
 HALIFAX, NOVA SCOTIA  
 OFFICE: (902) 455-1537  
 FAX: (902) 455-8479  
 WEB: www.sdmm.ca

**REGKAY COURT**  
 REGKAY COURT, SACKVILLE, NS

**PROPOSED APARTMENT SERVICE SCHEMATIC**

Project No: (36973)  
 Scale: 1:750  
 Date: 04/05/2022  
 Rev 1

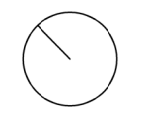

**WM FARES**  
 ARCHITECTS

**CSK-1**