

LANDSCAPE SPECIFICATIONS

- QUALIFICATION OF BIDDERS**
 - THE CONTRACTOR SHALL BE A MEMBER IN GOOD STANDING OF A MEMBER ORGANIZATION OF THE CANADIAN NURSERY TRADES ASSOCIATION.
 - THE CONTRACTOR'S SITE SUPERVISOR SHALL BE A CERTIFIED LANDSCAPE TECHNICIAN.
- GENERAL**
 - SITE LAYOUT HAS BEEN TAKEN FROM ARCHITECTURAL SITE PLAN PREPARED BY STUDIO WORKS INC MAY 2020.
 - THIS PLAN IS TO BE READ IN CONJUNCTION WITH ARCHITECTURAL DRAWINGS.
- SOILS FOR LANDSCAPING**
 - TOPSOIL SHALL BE FRIABLE SANDY LOAM WITH A SUITABLE CONTENT OF MINERAL PARTICULATE, MICRO ORGANISMS, ORGANIC MATTER AND SOIL NUTRIENTS (NITROGEN, PHOSPHORUS, POTASSIUM), FREE OF DEBRIS AND STONES OVER 25mm IN DIAMETER. SAND CONTENT SHALL BE 40-70%, ORGANIC CONTENT BE 20%, THE CLAY CONTENT SHALL BE 20% MAX. A SAMPLE OF THE TOPSOIL SHALL BE SUBMITTED TO THE PROVINCIAL DEPARTMENT OF AGRICULTURE FOR ANALYSIS. THE CONTRACTOR SHALL SUPPLEMENT THE TOPSOIL IN ACCORDANCE WITH THE RECOMMENDATIONS OF THE SOIL ANALYSIS. THE CONTRACTOR SHALL SUBMIT A COPY OF THE SOILS ANALYSIS REPORT TO THE OWNER AND PROVIDE A SAMPLE OF THE TOPSOIL FOR APPROVAL PRIOR TO DELIVERY TO THE SITE.
 - PLANTING SOIL TO BE A MIXTURE OF 60% TOPSOIL AND 40% ORGANIC MATTER TO BE AGED COMPOST OR WELL AGED MANURE. ALL SOIL, COMPOST OR MANURE TO BE COMPLETELY FREE OF WEED AND WEED SEED.
- PLANTING**
 - ALL PLANTING SHALL CONFORM TO THE CANADIAN NURSERY TRADES ASSOCIATION METRIC GUIDE SPECIFICATIONS AND STANDARDS FOR NURSERY STOCK, LATEST EDITION. ALL PLANT MATERIAL SHALL BE TOP QUALITY AND APPROVED BY THE OWNER PRIOR TO PLANTING. POOR QUALITY PLANT MATERIAL WILL BE REJECTED. UNDERSIZED PLANT MATERIAL OR SUBSTITUTIONS WILL NOT BE ACCEPTED UNLESS APPROVED BY THE OWNER.
 - ALL PLANTS SHALL BE PLANTED AS SHOWN ON PLANTING DETAILS.
- SODDING**
 - ALL SOD SHALL CONFORM TO THE CANADIAN NURSERY TRADES ASSOCIATION METRIC GUIDE SPECIFICATIONS AND STANDARDS FOR NURSERY STOCK, LATEST EDITION.
 - ALL SODDED AREAS SHALL SLOPE TO DRAIN AT A MINIMUM OF 2% SLOPE AND A MAXIMUM OF 1V/3H RISE/RUN UNLESS NOTED OTHERWISE.
 - ALL AREAS TO BE SODDED SHALL BE COVERED WITH 6" (AFTER COMPACTION) OF APPROVED AND AMENDED TOPSOIL.
- BENCH**
 - SHALL BE ODGEN COLLECTION, BACKLESS, STRAIGHT , 6' LONG AS SUPPLIED BY MAGLIN SITE FURNITURE OR APPROVED EQUAL. ODGEN COLLECTION: LAY_OGM1900-00144 BENCH SHALL HAVE PEDESTAL LEGS WITH FOOTPLATES TO BE SURFACE MOUNTED ON CONCRETE PAD.
- BEACH STONE**
 - SHALL BE SMOOTH, ROUND, NATURAL STONE, 50-100mm DIA, WASHED FREE OF SOIL AND OTHER CONTAMINANTS. COLOUR GRAY. PLACE SURFACE STONES TO CREATE SMOOTH EVEN FINISH.
- MULCH**
 - PLANTING AREAS TO BE COVERED WITH 75MM OF BARK MULCH.
 - BARK MULCH TO BE SHREDDED BARK AT LEAST TWO YEARS OLD AND FROM THE BARK OF SOFTWOOD TREES.

PLANT LIST

QTY	COMMON NAME	BOTANICAL NAME	SIZE/ CONDITION
1	LONDON PLANETREE	PLATANUS X ACERIFOLIA	70mm CAL / WB
5	PYRAMIDAL ENGLISH OAK	QUERCUS ROBUR 'FASTIGIATA'	50mm CAL / WB
36	BOXWOOD GREEN VELVET	BUXUS GREEN VELVET	50cm - POTTED
18	SARCOXIE EUONYMUS	EUONYMUS FORTUNEI 'SARCOXIE'	50cm - POTTED
11	FEATHER REED GRASS	CALAMAGROSTIS x ACUTIFOLIA 'KARL FOERSTER'	3 GAL. POT
26	SWITCH GRASS	PANICUM VIRGATUM HEAVY METAL	3 GAL. POT
20	DWARF FAMILIN FOUNTAIN GRASS	PENNISETUM ALOPECUROIDES HAMLN	3 GAL. POT
9	CATMINT WALKERS LOW	NEPETA WALKERS LOW	3 GAL. POT
12	HOSTA	HOSTA SPECIES PATRIOT AND FRANCIS WILLIAMS	3 GAL. POT
6	SEDUM AUTUMN JOY	SEDUM SPECTABALIS BRILLIANT	3 GAL. POT
12	OSTRICH FERN	MATTEUCCIA STRUTHIOPERIS	3 GAL. POT
6	HAKONE GRASS	HAKONECHLOA MACRA ALL GOLD	3 GAL. POT
24	SEDUM	SEDUM SPECTABALE 'AUTUMN JOY'	2 GAL. POT

PLANT MATERIAL NOTES:
 1. ALL PLANT MATERIAL SHALL BE SALT TOLERANT
 2. ALL PLANTS SHALL CONFORM TO THE CANADIAN NURSERY TRADES ASSOCIATION STANDARDS AND SPECIFICATIONS FOR NURSERY STOCK

**FOR SITE PLAN APPROVAL ONLY
 NOT FOR CONSTRUCTION**

- CONTRACTORS MUST:**
- CHECK AND VERIFY THAT ALL DIMENSIONS ARE CORRECT, REPORTING ALL ERRORS AND OMISSIONS IN WRITING TO THE ARCHITECT PRIOR TO PROCEEDING WITH THE WORK.
 - PRINT THESE DRAWINGS ONLY AT THE CORRECT SCALE.
 - READ THE DRAWINGS WITH ALL ASSOCIATED SPECIFICATIONS AND DRAWINGS BY OTHER CONSULTANTS, SUCH AS ELECTRICAL, MECHANICAL, STRUCTURAL.

THIS SHEET IS PROTECTED BY COPYRIGHT. IT REMAINS THE INTELLECTUAL PROPERTY OF THE ARCHITECT WHO HAS PREPARED IT FOR THE SOLE BENEFIT OF THE OWNER. UNAUTHORIZED USE OF THIS SHEET IS PROHIBITED, AND MAY RESULT IN LEGAL ACTION. PERSONS WHO USE THIS INFORMATION FOR PURPOSES OTHER THAN THOSE DESCRIBED HEREIN DO SO AT THEIR OWN RISK.

REVISIONS:

NO.	DESCRIPTION	DATE
1	FOR SITE PLAN APPROVAL	24 SEPT. 2020

PROJECT NAME:
 Tony Gossen Oxford Apartments

SHEET NUMBER:
 L102
 (sheet 82 of 105)

SHEET NAME:
 Planting Plan

PROJECT NUMBER: TG1901 **DATE:** 19 May 2020

CHECKED BY: RS **DRAWN BY:** CF

SCALE: as noted

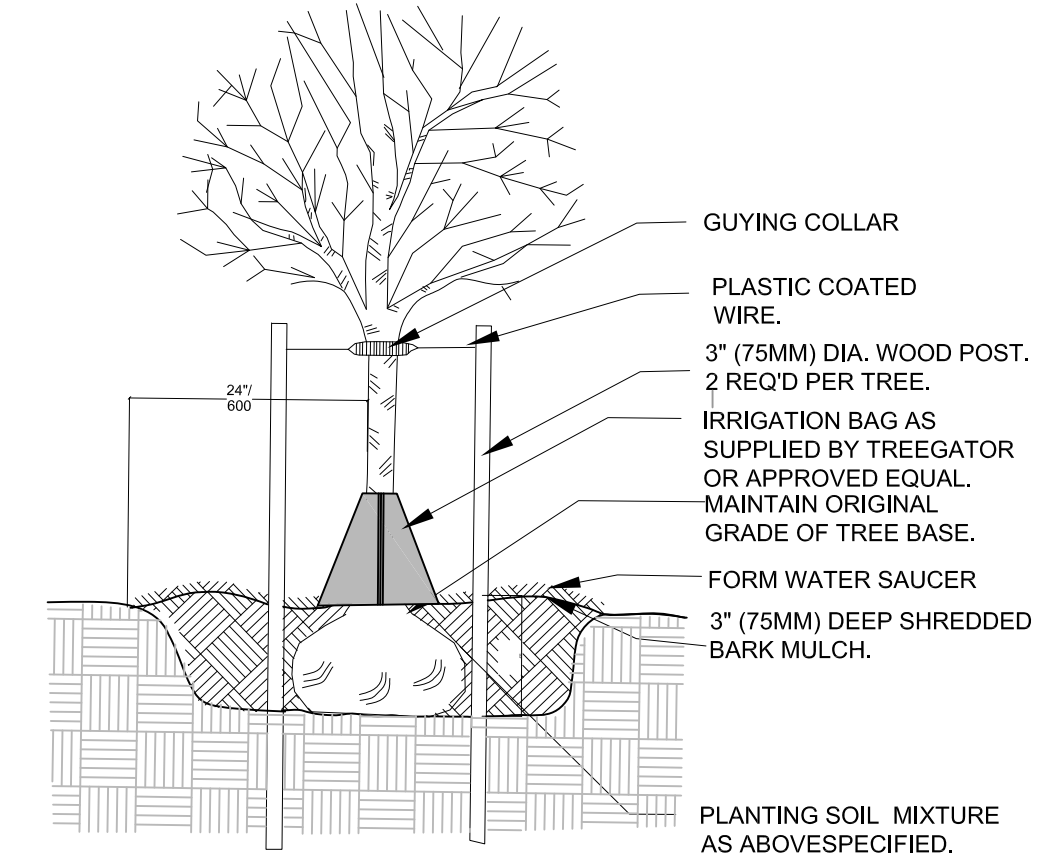

1 DECIDUOUS TREE PLANTING
 L101 N.T.S.

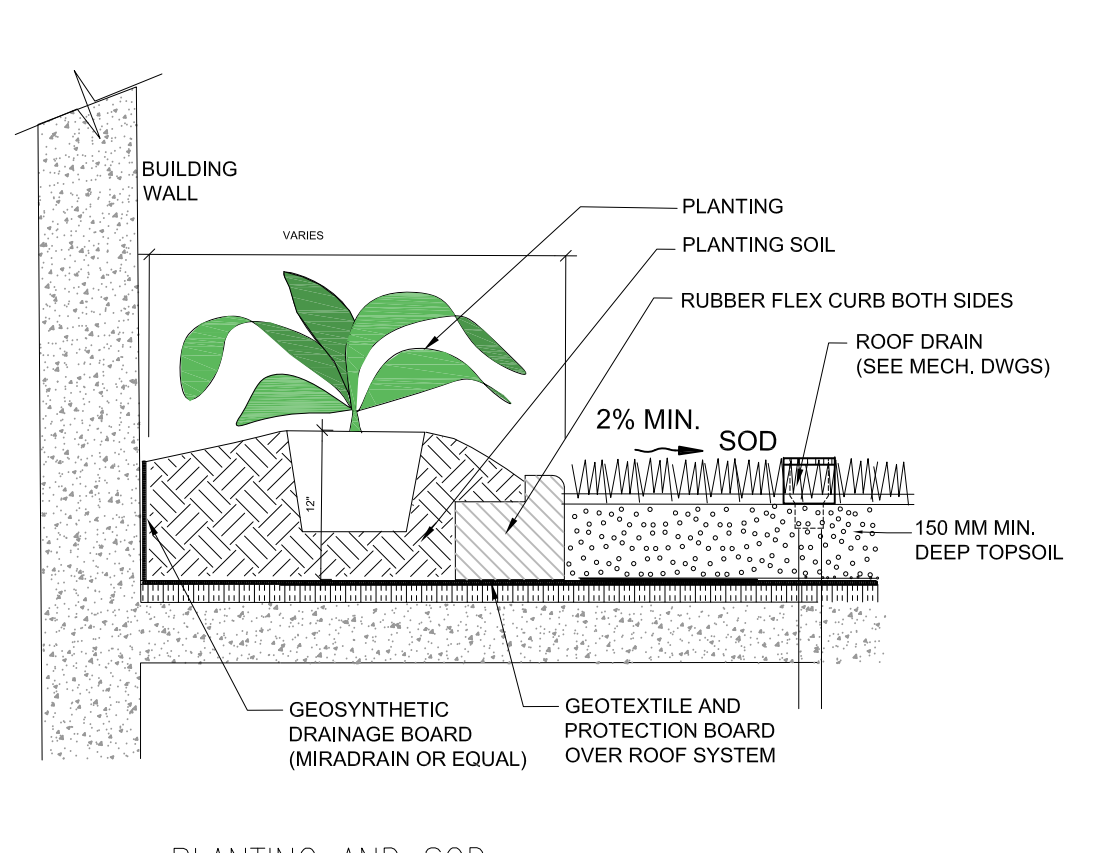

2 PLANTING AND SOD ON PODIUM
 L101 N.T.S.

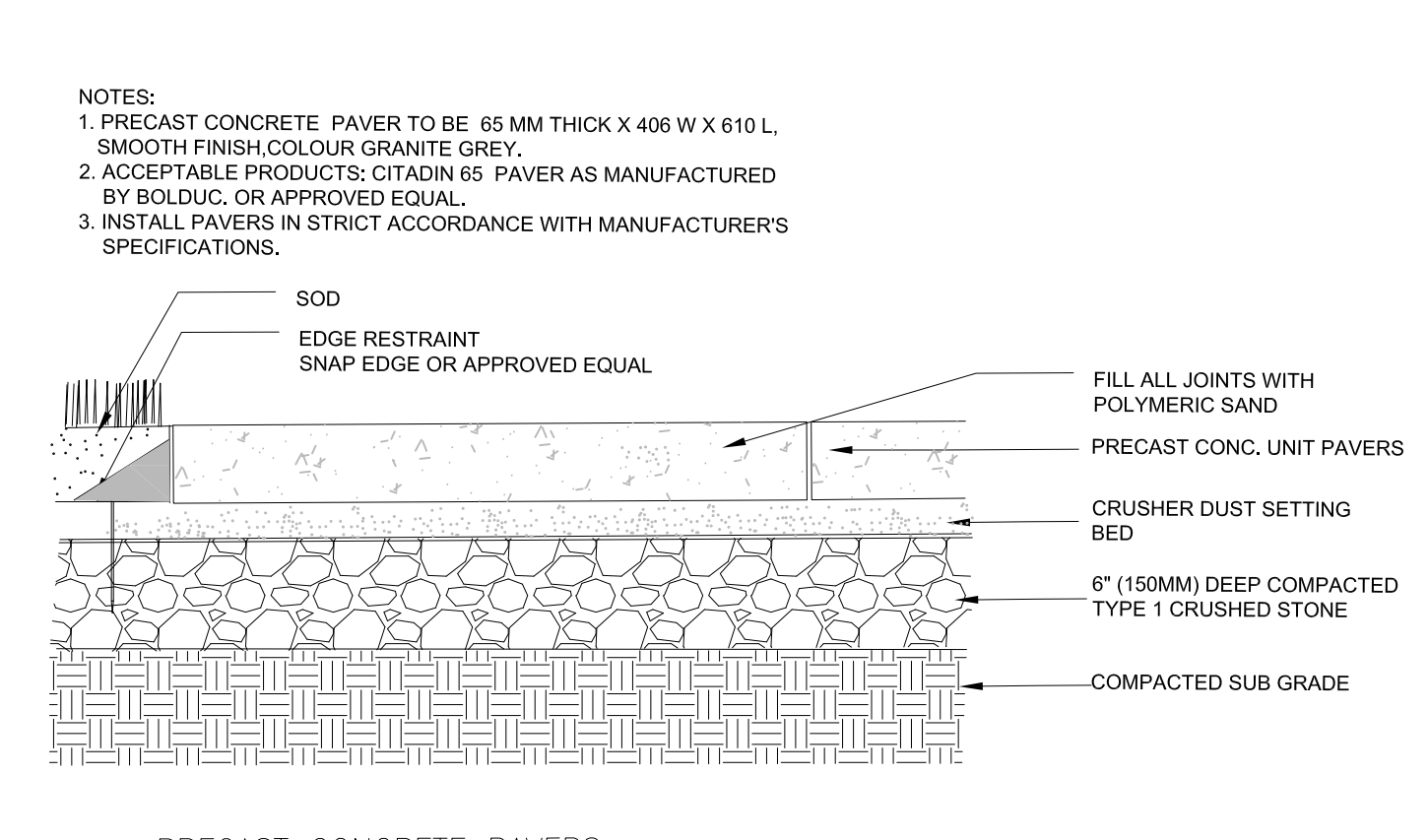

3 PRECAST CONCRETE PAVERS ON GRADE
 L101 N.T.S.

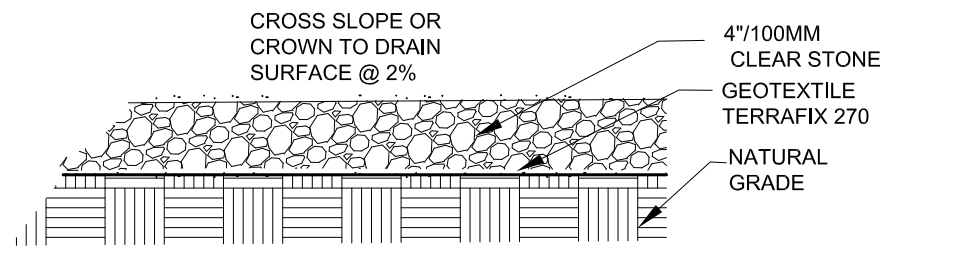

**4 1\"/>
 L101 N.T.S.**

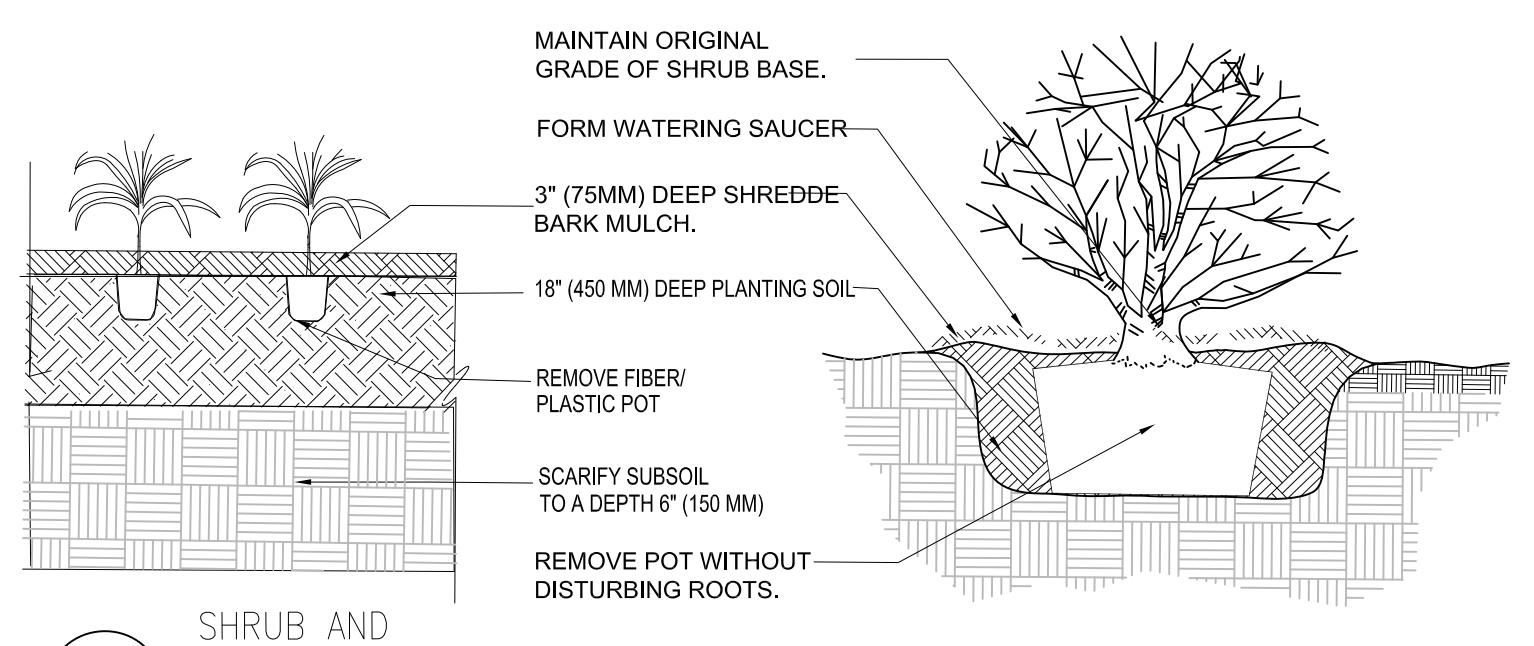

5 SHRUB AND PERENNIAL PLANTING
 L101 N.T.S.

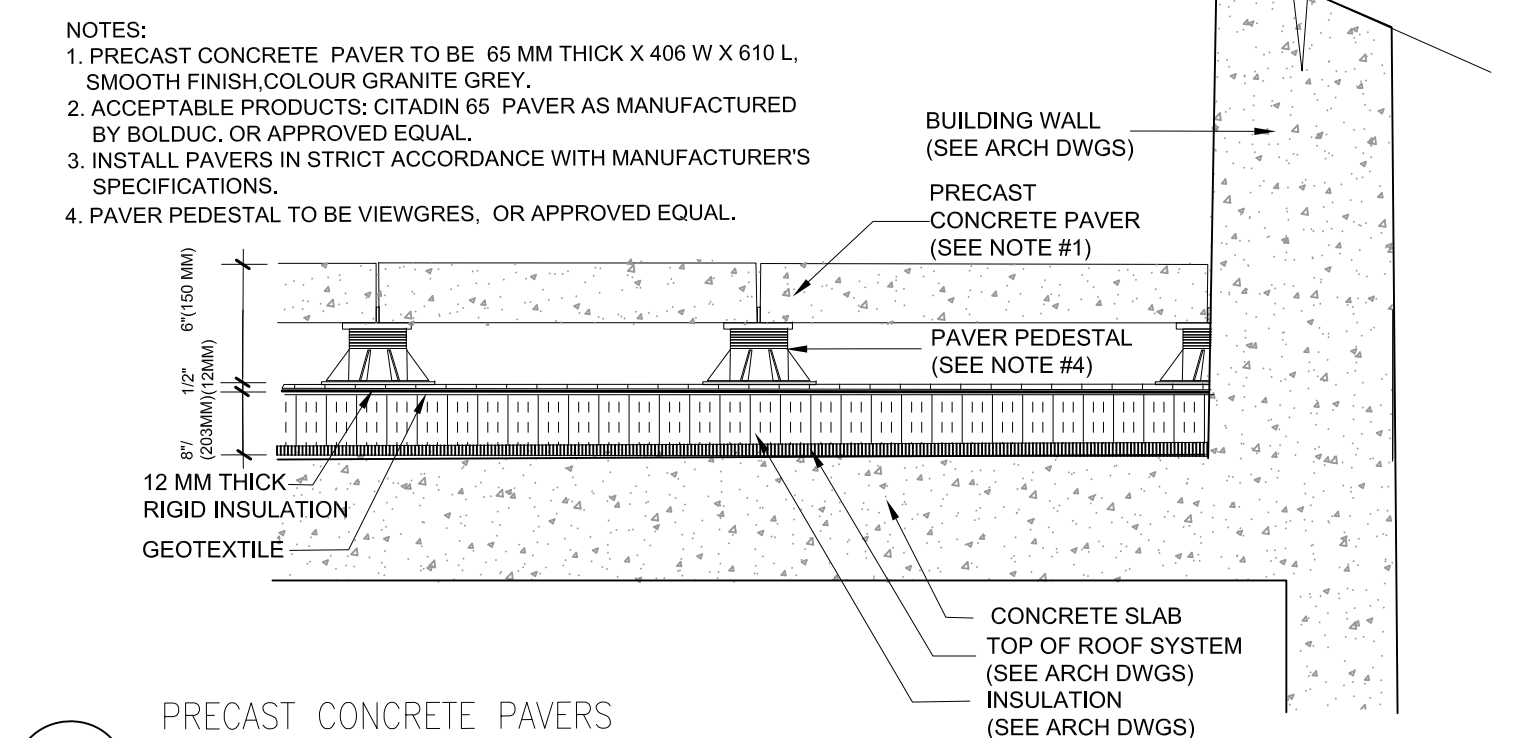

6 PRECAST CONCRETE PAVERS ON PEDESTALS
 L101 N.T.S.

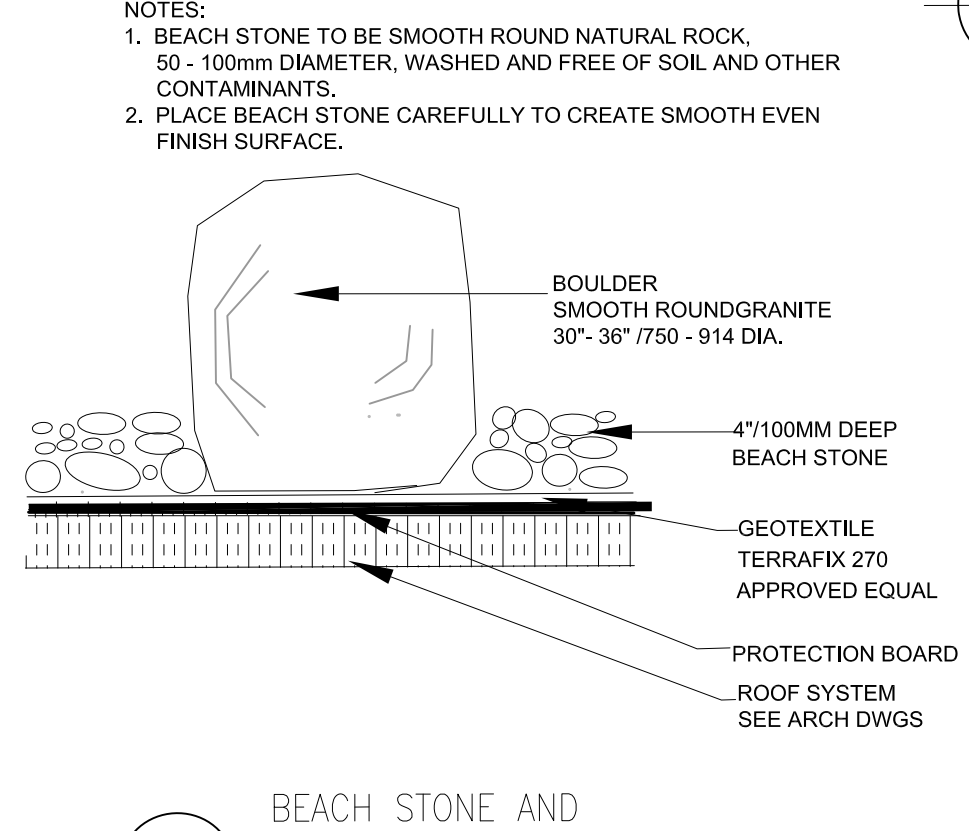

7 BEACH STONE AND BOULDER ON PODIUM
 L101 N.T.S.