

LEGEND

EXISTING		PROPOSED
⊙	GATE/BUTTERFLY VALVE	⊙
▽	STREET SIGN	▽
○/○	POWER POLE/LIGHT POLE	○/○
⊙/■	CATCHBASIN	⊙/■
⌋	CULVERT	⌋
158.5	ELEVATION	158.5
○	HYDRANT	○
---	PROPERTY BOUNDARY	---
---	OVERHEAD LINE	---
—SA—SA—	SANITARY MANHOLE & PIPE	—SA—SA—
—ST—ST—	STORM MANHOLE & PIPE	—ST—ST—
—WM—WM—	WATERMAIN	—WM—WM—
—FM—FM—	FORCEMAIN	—FM—FM—
—C—C—	UNDERGROUND CONDUIT	—C—C—
⌈	CONCRETE THRUST BLOCK	⌈
---	CURB AND DRIVEWAY CUT	---
---	SIDEWALK	---
---	STREET LINE	---
→	DRAINAGE DIRECTION	→
→	SWALE FLOW	→
346	CONTOUR LINES	346
—GAS—GAS—	GAS LINE	—GAS—GAS—
○	TREE	○
---	BOTTOM OF SLOPE	---
---	TOP OF SLOPE	---
---	GUARD RAIL	---
---	SILT FENCE	---

- NOTES:**
- TOPOGRAPHIC SURVEY DATA SHOWN HAS BEEN PRODUCED BY ABLE ENGINEERING SERVICES INC.. VALUES SHOWN ARE OBTAINED FROM THE NOVA SCOTIA LIDAR POINT CLOUD (RAW LIDAR) AND THE NOVA SCOTIA ELEVATION DATASET REFERENCED TO THE COORDINATE SYSTEM NAD83 CSRS 2010 CGVD2013.
 - THIS IS NOT A LEGAL BOUNDARY SURVEY. BOUNDARIES SHOWN HERE ARE APPROXIMATE. DERIVED FROM PROPERTY ONLINE MAPPING/PLAN OF SURVEY AND FIELD RECONNAISSANCE BY CIVIL ENGINEERING TECHNICIAN. BOUNDARIES ARE SUBJECT TO A LEGAL FIELD SURVEY BY A LICENSED NSLS, AND A LEGAL SURVEY MAY CAUSE OFFSETS AND BOUNDARIES TO DIFFER FROM WHAT IS SHOWN HEREIN.
 - WATER SERVICE TO PROPOSED DEVELOPMENT TO BE COMPLETED WITH A SINGLE CONNECTION TO THE 300mm HRWC WATERMAIN. WATER METER TO BE INSTALLED IN BUILDING 1. ALL WORK TO BE IN ACCORDANCE WITH THE LATEST VERSION OF THE HRWC SPECIFICATIONS AND STANDARD DETAILS.

NOT FOR CONSTRUCTION

No.	Date	Revision	Description	Appr'd
2	09/04/2020	ISSUED FOR REVIEW		
1	03/04/2020	ISSUED FOR REVIEW		

Seal

ABLE
ENGINEERING SERVICES INC
5209 ST. MARGARET'S BAY RD., SUITE 201
UPPER TANTALON, NOVA SCOTIA
TEL. 902-273-3050 FAX. 902-273-3072
civil@ableinc.ca www.ableinc.ca

FALL RIVER SITE C
PROPOSED INGRAM DRIVE DEVELOPMENT

PROPOSED WATER SERVICE
SITE CONCEPT PLAN

Date	MARCH 13, 2020	Drawn	J.HENMAN	Project No.	
Scale	1:750	Engineer	M.VISENTIN	Plan No.	C-101

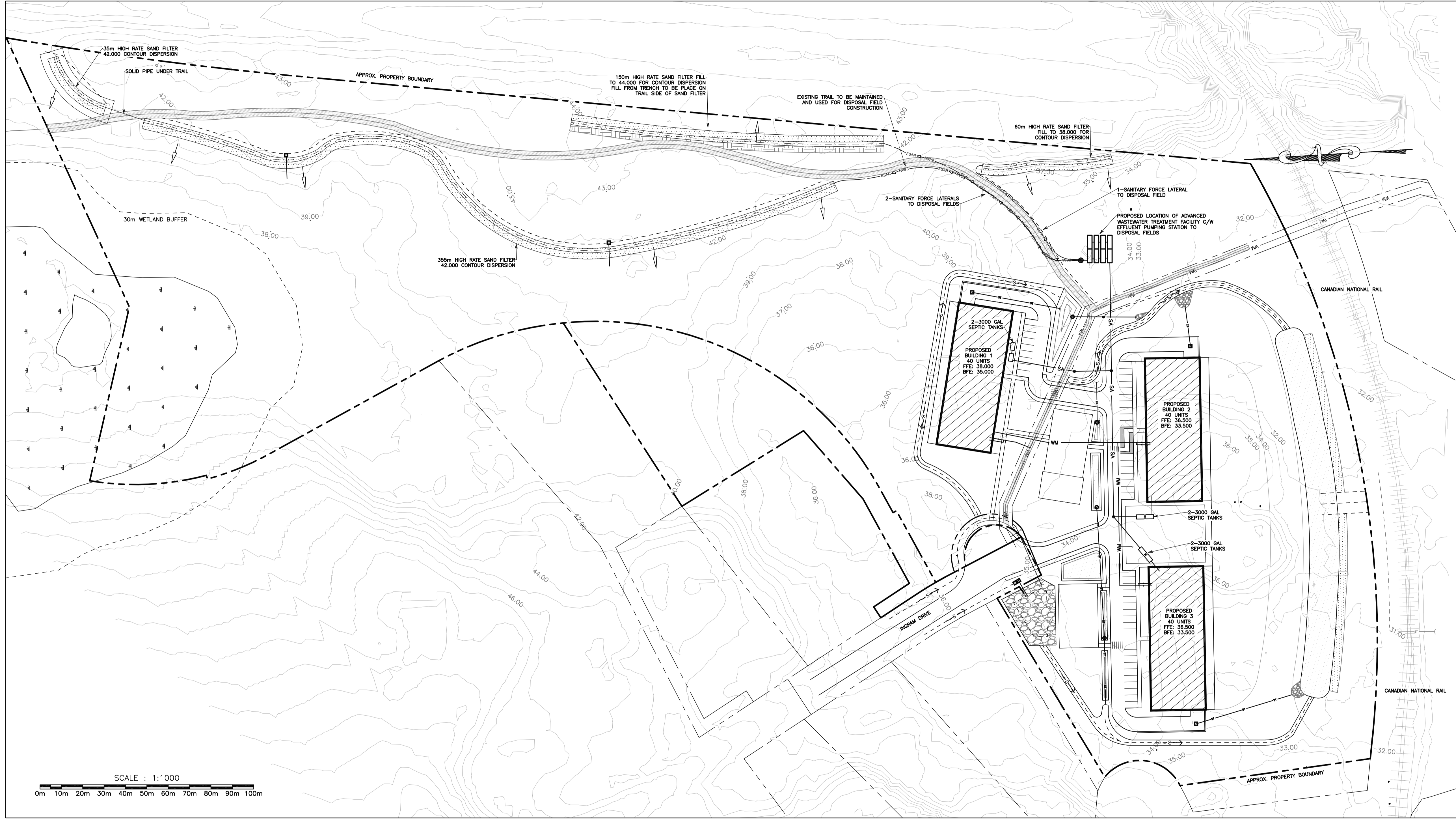
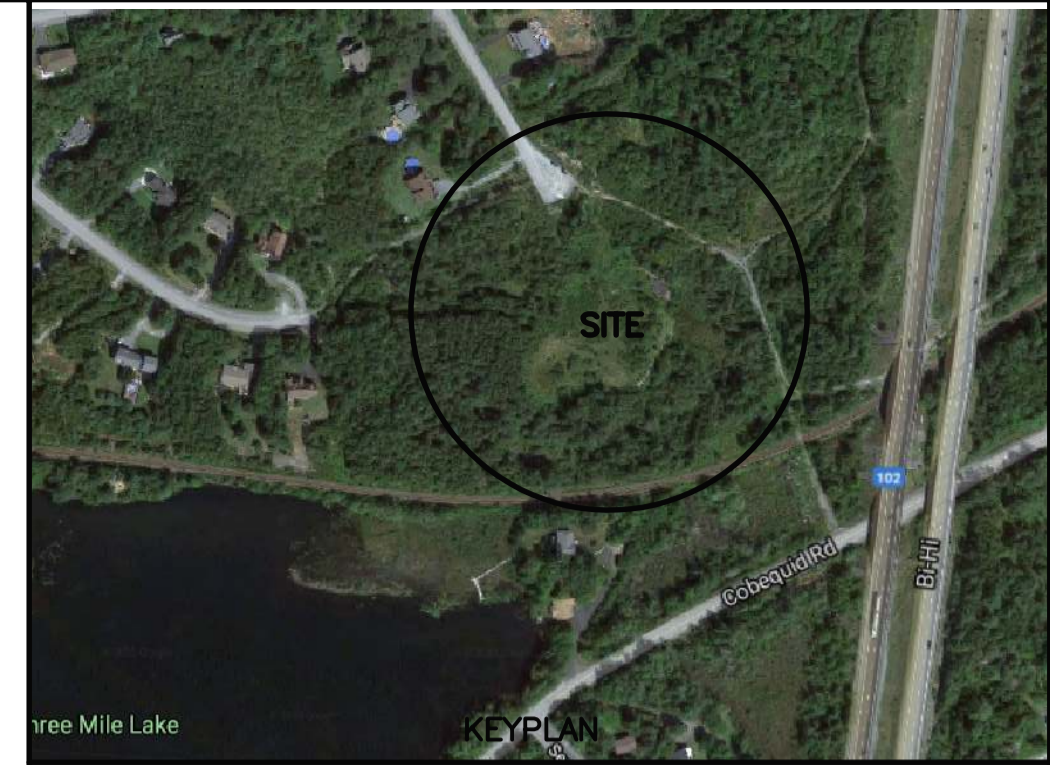

SCALE : 1:1000
 0m 10m 20m 30m 40m 50m 60m 70m 80m 90m 100m

LEGEND		
EXISTING		PROPOSED
⊙	GATE/BUTTERFLY VALVE	⊙
⊙/⊙	STREET SIGN	⊙/⊙
⊙/⊙	POWER POLE/LIGHT POLE	⊙/⊙
⊙	CATCHBASIN	⊙
⊙	CULVERT	⊙
158.5	ELEVATION	158.5
⊙	HYDRANT	⊙
---	PROPERTY BOUNDARY	---
---	OVERHEAD LINE	---
SA- SA	SANITARY MANHOLE & PIPE	SA- SA
ST- ST	STORM MANHOLE & PIPE	ST- ST
WM- WM	WATERMAIN	WM- WM
WM	WATER SERVICE	WM
FM- FM	FORCEMAIN	FM- FM
C- C	UNDERGROUND CONDUIT	C- C
⊏	CONCRETE THRUST BLOCK	⊏
---	CURB AND DRIVEWAY CUT	---
---	SIDEWALK	---
---	STREET LINE	---
---	DRAINAGE DIRECTION	---
---	SWALE FLOW	---
346	CONTOUR LINES	346
GAS- GAS	GAS LINE	GAS- GAS
⊙	TREE	⊙
---	BOTTOM OF SLOPE	---
---	TOP OF SLOPE	---
---	GUARD RAIL	---
---	SILT FENCE	---

NOTES:
 1. TOPOGRAPHIC SURVEY DATA SHOWN HAS BEEN PRODUCED BY ABLE ENGINEERING SERVICES INC. VALUES SHOWN ARE OBTAINED FROM THE NOVA SCOTIA LIDAR POINT CLOUD (RAW LIDAR) AND THE NOVA SCOTIA ELEVATION DATASET REFERENCED TO THE COORDINATE SYSTEM NAD83 CSRS 2010 CGVD2013.
 2. THIS IS NOT A LEGAL BOUNDARY SURVEY. BOUNDARIES SHOWN HERE ARE APPROXIMATE. DERIVED FROM PROPERTY ONLINE MAPPING/PLAN OF SURVEY AND FIELD RECONNAISSANCE BY CIVIL ENGINEERING TECHNICIAN. BOUNDARIES ARE SUBJECT TO A LEGAL FIELD SURVEY BY A LICENSED NSLS, AND A LEGAL SURVEY MAY CAUSE OFFSETS AND BOUNDARIES TO DIFFER FROM WHAT IS SHOWN HEREIN.
 3. WASTEWATER TREATMENT DETAILED DESIGN TO MEET OR EXCEED REQUIREMENTS OF NOVA SCOTIA ENVIRONMENT AND PHOSPHORUS NET LOADING ASSESSMENT.

NOT FOR CONSTRUCTION

No.	Date	Revision	Description	Appr'd
2	09/04/2020	ISSUED FOR REVIEW		
1	03/04/2020	ISSUED FOR REVIEW		

Seal

ABLE
 ENGINEERING SERVICES INC
 5209 ST. MARGARET'S BAY RD., SUITE 201
 UPPER TANTALLON, NOVA SCOTIA
 TEL. 902-273-3050 FAX. 902-273-3072
 civil@ableinc.ca www.ableinc.ca

FALL RIVER SITE C
 PROPOSED INGRAM DRIVE DEVELOPMENT
 PROPOSED SANITARY SERVICE
 SITE CONCEPT PLAN

Date	MARCH 13, 2020	Drawn	J.HENMAN	Project No.	
Scale	1:1000	Engineer	M.VESINTIN	Plan No.	C-102