



P.O. Box 1749  
Halifax, Nova Scotia  
B3J 3A5 Canada

**Item No. 14.1.3**  
**Halifax Regional Council**  
**February 7, 2017**

**TO:** Mayor Savage and Members of Halifax Regional Council

Original Signed by 

**SUBMITTED BY:** \_\_\_\_\_  
Jacques Dubé, Chief Administrative Officer

**DATE:** January 6, 2017

**SUBJECT:** **Award – Tender 16-186 Canal Greenway Park**

---

**ORIGIN**

The approved 2015/16 Capital Budget. Project Number: CDG00493. Reference page C5. The approved 2017/18 Advanced Tendering Funds. Project Number: CDG00493. Reference Item No. 49 Shubenacadie Greenway Trail.

The Shubenacadie Canal Greenway is located in downtown Dartmouth and follows the historic Shubenacadie Canal. It connects Halifax Harbour with Lake Micmac and Shubie Park, and is comprised of a system of trails and parks owned by HRM. Regional Council has approved a master plan for the Starr Manufacturing Site on Prince Albert Road and Sullivan's Pond /Lake Banook.

**LEGISLATIVE AUTHORITY**

In accordance with Administrative Order No. 35, The Procurement Policy, Section 9(4), the CAO may approve the award of contracts where the award conforms to the Procurement Policy and does not exceed \$50,000 for sole/single source, \$500,000 for RFQs, Tenders and RFPs, where the funds and programs have been approved by Regional Council as part of the annual business planning and budget process, and the expenditure will not result in an over-expenditure of the entire budget.

The following report conforms to the above Policy and Charter.

**RECOMMENDATION**

It is recommended that Halifax Regional Council award Tender 16-186 Canal Greenway Park to the lowest bidder meeting specifications, Schooner Excavation Limited, for a Total Price of \$620,396 net HST included, with funding from CDG00493, as outlined in the Financial Implications section of this report.

## **BACKGROUND**

In April of 2008, Regional Council approved the Sullivan's Pond Banook Master Plan to develop the Greenway Corridor from Lake Banook to the Halifax Harbour. The following historic elements (to interpret the marine railway that moved boats from the Halifax Harbour to Lock No. 1 of the canal system) were included in the restoration/replication scope of work:

- Turbine Chamber - Excavation, cleaning and restoration work of the Turbine Chamber was completed in fall of 2016. Replica of the turbine and the drums will be installed this spring as part of the Shubenacadie Canal Commission project
- Flume House - the flume house (or power house) was originally built to contain the drums and brakes which captured the mechanical energy from the flow of water, building construction was completed fall of 2016
- Boat Cradle and Inclined Plane - The boat cradle was constructed in spring 2015 and delivered to the site in fall 2015. This element has been completed. The inclined plane (marine railway) was partially constructed under the boat cradle. The remaining interpretation part of the inclined plane is included in this award

The site development and landscaping is the last phase in the development of the Canal Greenway heritage park and trail system. The project scope is outlined below. This project will create a key element of the park, central timber plaza to provide free access and space to exhibit the Power House and Flume replica and other historical interpretation components.

The site is planned to open in June of 2017 and the interpretational aspects of the park will be overseen by the Shubenacadie Canal Commission.

## **DISCUSSION**

Tenders were called on September 27, 2016, with closing on October 18, 2016. Bids were received from the following companies:

<b>Name of Company</b>	<b>Bid Price (net HST Incl.)</b>
Schooner Excavation Ltd.	\$620,396*
Dexter Company Ltd.	\$626,479
Turf Masters Landscaping	\$665,138
Tracey's Landscaping Ltd.	\$672,068

\*Recommended Bidder

The solicitation is a unit price lump sum tender.

### ***Scope and Schedule:***

Scope of work:

- Civil work: civil site engineering work, services connections, soil vapour extraction system in the Turbine Chambers and concrete sidewalk installation.
- Electrical work: power services connection, lighting system for Flume House and park/plaza area.
- Landscaping work: site grading, timber deck plaza and stone retaining wall, inclined plane construction, plant and tree installation, soil and sod placement.

Work excluded from the scope:

- Restoration of the stone Tail Race wall and landscaping surrounding area located south from the Flume House.
- Re-grading and landscaping at the corner of Prince Albert Road and Irishtown Road, future Water Commission project site.

**Project Schedule:**

- Commence construction - March 2017
- Substantial completion - July 2017
- Total completion - September 2017

**FINANCIAL IMPLICATIONS**

Based on the lowest qualified bid of \$620,396 (net HST included) funding is available in the approved 2015/16 Capital budget from CDG00493. The budget availability has been confirmed by Finance.

Budget Summary:	<u>Project Account No. CDG00493</u>	
	Cumulative Unspent Budget	\$ 728,465
	<b>Less: Tender No. 16-186</b>	<b><u>\$(620,396)</u></b>
	Balance	\$ 108,069

The balance of funds will be used to continue the work on the Canal Greenway Project.

**RISK CONSIDERATION**

Unforeseen Site Conditions: Due to the age of the underground structures, there is risk of finding unforeseen conditions that will require remedial work. Engineering investigations were performed to evaluate structural integrity of the underground structures.

Site Safety: This will be mitigated by attention to safe working practices by the contractor.

**ENVIRONMENTAL IMPLICATIONS**

No environmental implications. Clean up work was conducted as recommended by Environmental Site Assessment and Remedial Excavation Program recommendation. Risk Management Plan has been prepared as a guideline for the project site work.

**ALTERNATIVES**

The Council could decide not to award this contract. This is not recommended, as this work is required to complete the project and provide safe access to the site.

**ATTACHMENTS**

Canal Greenway Park Site Development plan – Attachment A

---

A copy of this report can be obtained online at <http://www.halifax.ca/council/agendasc/cagenda.php> then choose the appropriate meeting date, or by contacting the Office of the Municipal Clerk at 902.490.4210, or Fax 902.490.4208.

Report Prepared by: Bogdan Hadlaw, Project Manager, Corporate Facility Design & Construction,  
902.490.6050

Report Approved by: \_\_\_\_\_  
John MacPherson, A/Manager, Corporate Facility Design & Construction,  
902.209.0763

Procurement Review: \_\_\_\_\_  
Jane Pryor, Manager, Procurement, 902.490.4200

Report Approved by: \_\_\_\_\_  
Peter Stickings, A/Director, 902.476.8237

Report Approved by: \_\_\_\_\_  
Amanda Whitewood, Director/CFO, Finance & Information, Communication and  
Technology, 902.490.6308

Original Signed

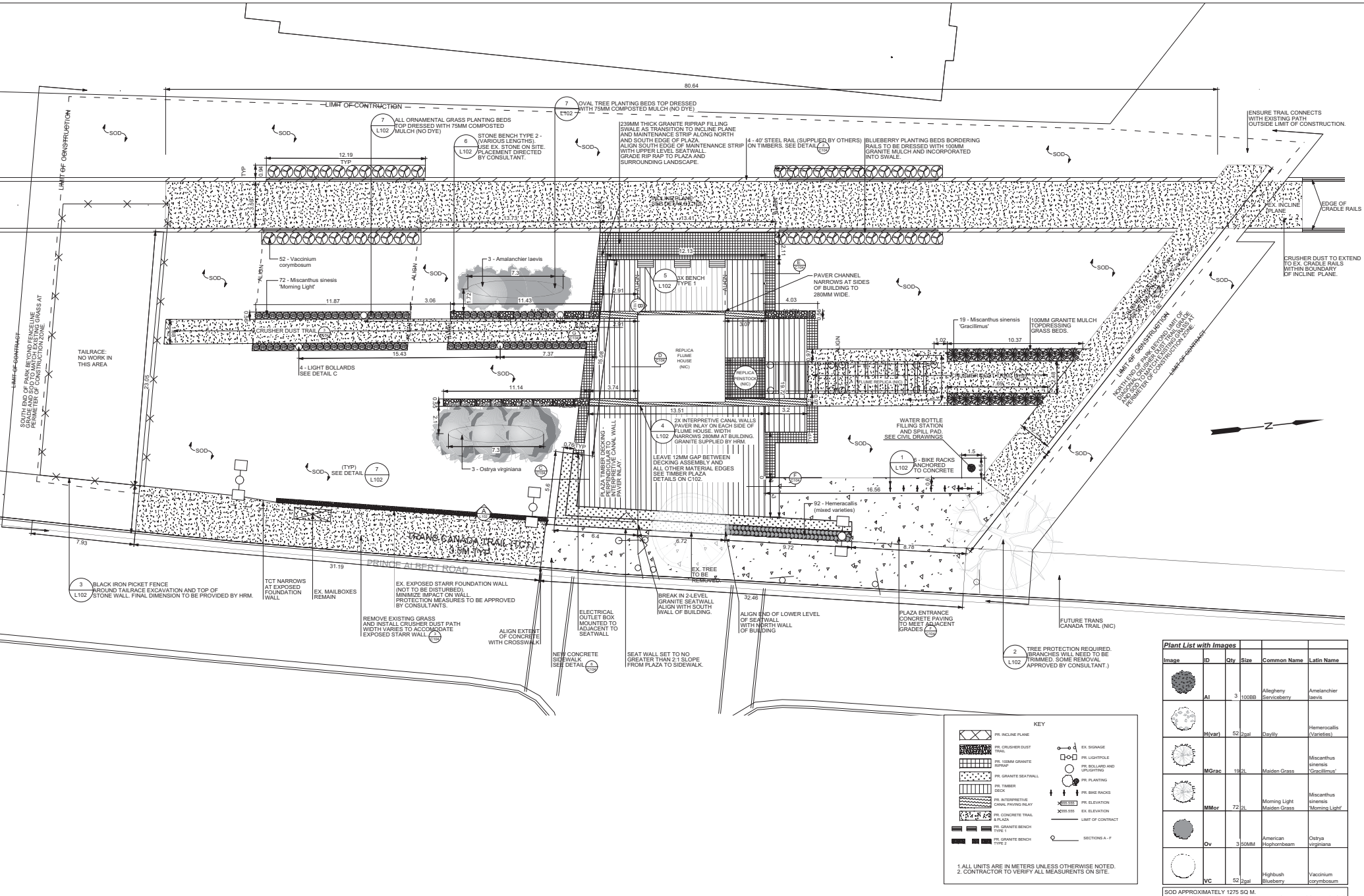

Image	ID	Qty	Size	Common Name	Latin Name
	Al	3	1000B	Allegheny Serviceberry	<i>Amelanchier laevis</i>
	H(Var)	52	2gal	Daylily	<i>Hemerocallis</i> (Varieties)
	M(Var)	19	2L	Maiden Grass	<i>Miscanthus sinensis</i> 'Gracillimus'
	MMor	72	2L	Morning Light Maiden Grass	<i>Miscanthus sinensis</i> 'Morning Light'
	Ov	3	50MM	American Hopbush	<i>Ostrya virginiana</i>
	VC	52	2gal	Highbush Blueberry	<i>Vaccinium corymbosum</i>

SOD APPROXIMATELY 1276 SQ M (CALCULATION TO BE VERIFIED AND ADJUSTED BY CONTRACTOR)

**KEY**

- PR. INCLINE PLANE
- PR. CRUSHER DUST
- PR. 100MM GRANITE RIPRAP
- PR. GRANITE SEATWALL
- PR. TIMBER
- PR. INTERPRETIVE CANAL PAVING RELAY
- PR. CONCRETE TRAIL PLAZA
- PR. GRANITE BENCH TYPE 1
- PR. GRANITE BENCH TYPE 2
- EX. STORAGE
- PR. LIGHTPOLE RIPRAP
- PR. BOLLARD AND SIGNATURE
- PR. PLANTING
- PR. BUSH PACKS
- PR. ELEVATION
- EX. ELEVATION
- LIMIT OF CONTRACT
- SECTIONS A - F

1. ALL UNITS ARE IN METERS UNLESS OTHERWISE NOTED.  
2. CONTRACTOR TO VERIFY ALL MEASUREMENTS ON SITE.

No.	Date	Issue	Description	Appr.
0	08-09-16	ISSUED FOR TENDER		
01	08-09-16	ISSUED FOR TENDER		



CANAL GREENWAY PARK  
DARTMOUTH, NOVA SCOTIA

LANDSCAPE PLAN

Date: SEPT 8, 2016  
Scale: 1:100  
Author: JC  
Checked: BS  
Sheet: 1 OF 2  
Drawing No.: L101